



Verde Close, Eye, Peterborough
£240,000 Freehold

**Sharman
Quinney**

Key Features



- Three/four Bedrooms
- Kitchen/Diner
- En-Suite To Master
- Garage
- Enclosed Rear Garden

GROUND FLOOR

ENTRANCE HALL: Entrance door. Radiator. Stairs to first floor.

STUDY/BEDROOM: 3.04m x 2.43m (10' x 8') UPVC Double glazed window to front. Radiator.

CLOAKROOM: Low level WC. Wash hand basin. Radiator.

KITCHEN/DINER: 5.19m x 3.96m (17'05" x 13'02") UPVC Double glazed window and French doors to rear. Fitted with a range of base and wall units. Stainless steel sink and drainer with mixer tap. Integrated dishwasher, washing machine and fridge/freezer. Built in oven and hob with cooker hood over. Wall mounted boiler. Radiator. Built



in cupboard.

FIRST FLOOR

LANDING: UPVC Double glazed window to front. Radiator.

LOUNGE: 3.67m x 3.69m (12'06" x 12'11") UPVC Double glazed window to rear. Two radiators.

BATHROOM: Low level WC. Wash hand basin. Bath. Radiator.

BEDROOM: 3.36m x 1.84m (11'05" x 6'04") UPVC Double glazed window to front. Radiator.

SECOND FLOOR

LANDING: Loft access. Radiator.

BEDROOM: 3.96m x 3.35m (13' x 11'01") UPVC Double glazed window to rear. Radiator. Fitted wardrobes.

EN-SUITE: Low level WC. Wash hand basin. Shower cubicle with mains shower. Radiator.

BEDROOM: 4.57m x 2.75m (15'02" x 9'05") UPVC Double glazed window to front. Radiator.

OUTSIDE

SIDE: Parking leading to garage with up and over



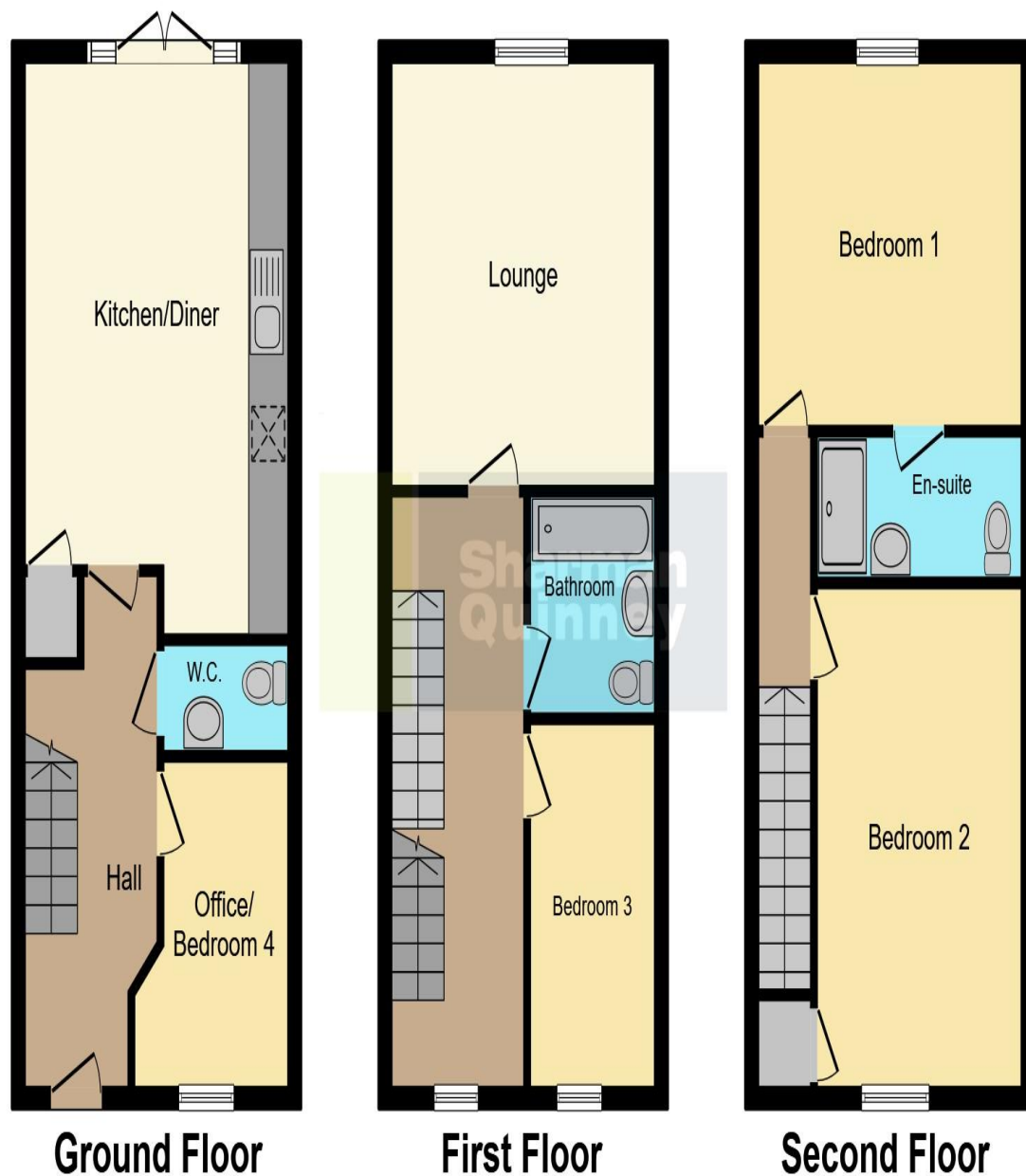

door, power and lighting and personal door to side.

REAR GARDEN: Enclosed by fencing. Side access gate. Laid to lawn with shrubs. Patio area.

This floorplan is for illustrative purposes only and is not drawn to scale. Measurements, floor-areas, openings and orientations are approximate. They should not be relied upon for any purpose and do not form any part of an agreement. No liability is taken for any error or mis-statement. All parties must rely on their own inspections.

To view this property call Sharman Quinney on:
01733 897896

Selling your property?

Contact us to arrange a **FREE** home valuation.

 01733 897896

 70 Albert Place, PETERBOROUGH,
Cambridgeshire, PE1 1DD

 peterborough@sharmanquinney.co.uk

 www.sharmanquinney.co.uk



 SCAN ME



Sharman Quinney Holdings Limited is registered in England and Wales under company number 4174227, Registered Office is Cumbria House, 16-20 Hockliffe Street, Leighton Buzzard, Bedfordshire, LU7 1GN. VAT Registration Number is 500 2481 05.

1: These particulars do not constitute part or all of an offer or contract. 2: The measurements indicated are supplied for guidance only and as such must be considered incorrect. 3: Potential buyers are advised to recheck the measurements before committing to any expense. 4: Sharman Quinney has not tested any apparatus, equipment, fixtures, fittings or services and it is the buyers interests to check the working condition of any appliances. 5: Sharman Quinney has not sought to verify the legal title of the property and buyers must obtain verification from their legal representative. 6: Intending purchasers will be asked to produce identification documentation at a later stage and we would ask your co-operation in order that there will be no delay in agreeing the sale. Ref: PTB206349 - 0008

