

**LOCATION:** Wellington is a popular market town boasting an assortment of both independently run shops and larger national stores to include the well renowned Waitrose whilst also benefitting from a range of educational and leisure facilities a Sport Centre, cinema and The Cleve Hotel & Spa. The landmark Wellington Monument showcases extensive views across the Blackdown Hills which is an Area of Outstanding Natural Beauty. There is also a regular bus service to outlying villages and to the County Town of Taunton which is approximately 7 miles distant with its main line railway station. The M5 Motorway can be accessed via Junction 26 just outside Wellington.

**DIRECTIONS:** From our Wellington town centre office proceed in the Taunton direction. After St John's Parish Church take the first turning right into Priory and then the first turning left into Priory Gardens; Priory Court can be found towards the end on the left hand side.

**GENERAL REMARKS AND STIPULATION**

**Tenure:** The property is offered for sale Leasehold, by private treaty with vacant possession on completion.

**Services:** Mains electricity, mains water, mains drainage, electric heating, telephone

**Local Authority:** Somerset County Council, County Hall, The Crescent, Taunton, TA1 4DY.

**Property Location:** w3w.co///pillows.recall.swooning

**Council Tax Band:** B

IMPORTANT NOTICE Wilkie May & Tuckwood for themselves and for the vendors of the property, whose agents they are, give notice that: 1. the particulars are intended to give a fair and substantially correct overall description for the guidance of intending purchaser and do not constitute part of an offer or contract. Prospective purchasers and lessees ought to seek their own professional advice. 2. All descriptions, dimensions, areas, reference to condition and necessary permissions for use and occupation and other details are given in good faith, and are believed to be correct, but any intending purchasers should not rely on them as statements or representations of fact, but must satisfy themselves by inspection or otherwise as to the correctness of each of them. 3. No person in the employment of Wilkie May & Tuckwood has any authority to make or give any representations or warranty whatever in relation to this property on behalf of Wilkie May & Tuckwood, nor enter into any contract on behalf of the vendor. 4. No responsibility can be accepted for any expenses incurred by intending purchasers in inspecting properties which have been sold, let or withdrawn. Photographs taken and details prepared November 2022. MEASUREMENTS AND OTHER INFORMATION All measurements are approximate. While we endeavour to make our sales particular accurate and reliable, if there is any point which is of particular importance to you, please contact the office and we will be pleased to check the information with you.

Code of Practice for Residential Estate Agents: Effective from 1 August 2011:

'8. Financial Evaluation 8a At the time that an offer has been made and is being considered by the seller, you must take reasonable steps to find out from the prospective buyer the source and availability of his funds for buying the property and pass this information to the seller. Such information will include whether the prospective buyer needs to sell a property, requires a mortgage, claims to be a cash buyer or any combination of these. Such relevant information that is available should be included in the Memorandum of Sale having regard to the provisions of the Data Protection Act.8b These reasonable steps must continue after acceptance of the offer until exchange of contracts (in Scotland, conclusion of missives) and must include regular monitoring of the prospective buyer's progress in achieving the funds required, and reporting such progress to the seller.

The agent has not tested any apparatus, equipment, fixtures and fittings or services and so cannot verify that they are in working order or fit for their purpose. A Buyer is advised to obtain verification from their solicitor or surveyor. References to the Tenure of the Property are based on information supplied by the Seller. The agent has not had sight of the title documents. A Buyer is advised to obtain verification from their Solicitor.

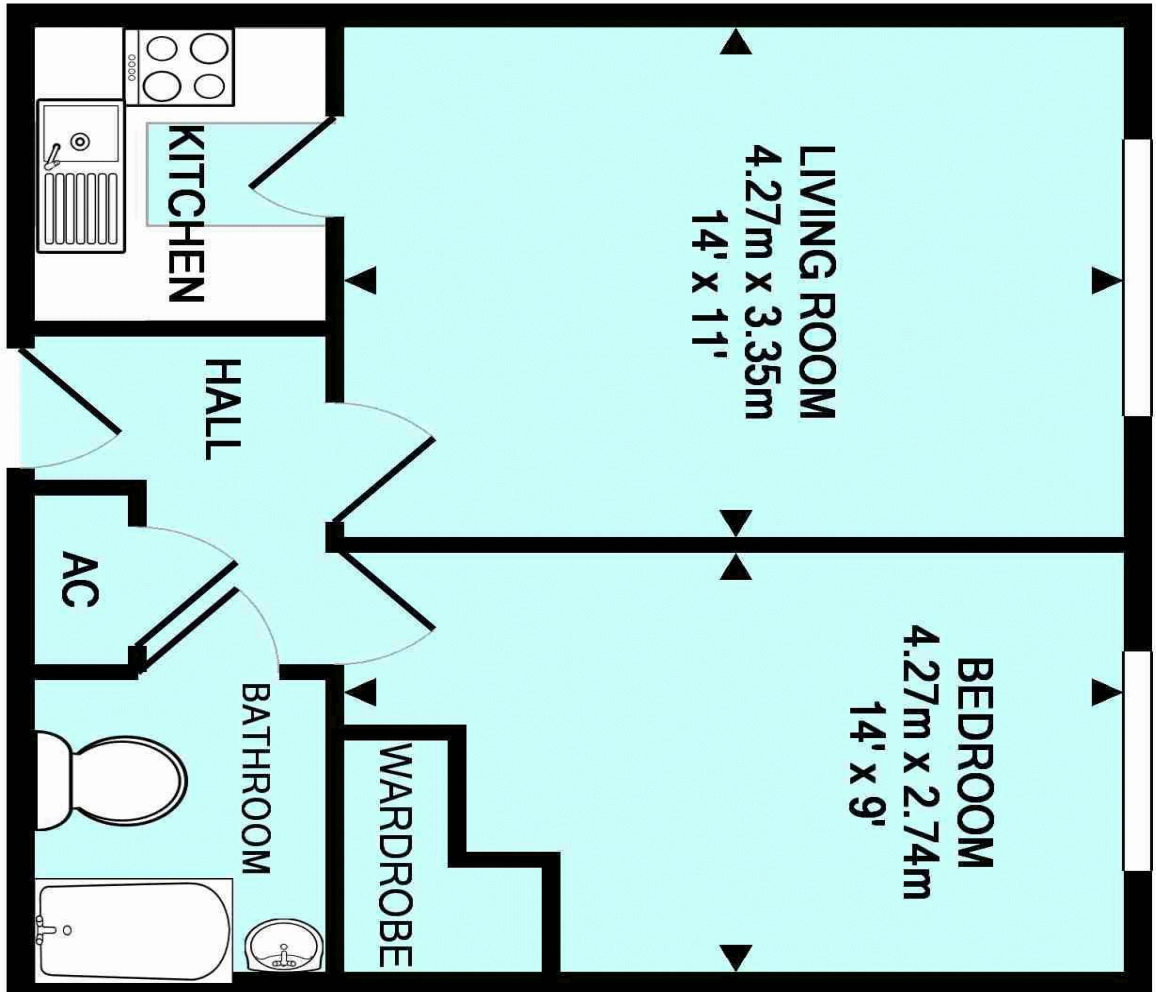

TOTAL APPROX. FLOOR AREA 36.2 SQ.M. (389 SQ.FT.)

Copyright Wilkie May & Tuckwood. Every attempt has been made to ensure the accuracy of this floorplan however, measurements are approximate and for illustration purposes only, not to scale. Made with Metropix ©2014

Offered to the market with **NO ONWARD CHAIN**, this one double bedroom first floor apartment is located just a short stroll from Wellington town centre with communal gardens and residents' parking available.

The living accommodation comprises a sitting/dining room and kitchen fitted with a comprehensive range of wall and base units with free standing cooker. There is a double bedroom with fitted wardrobes serviced by a bathroom fitted with a three piece suite.

Priory Court further benefits from a residents' lounge, laundry room and guest suite for visitors.

Outside, there is an attractive approach to the development with some resident and visitor parking and beautifully tended gardens, well stocked with a variety of mature flower and shrub borders. There are a number of seating areas and a lit pathway through towards the town centre and all of the local amenities on offer.

Agents Note: The property is leasehold with an assignable lease of 99 years starting in December 1997. Occupants must be 60 years of age or over and have obtained the Estate Manager's approval for residency. The Service Charge is approximately £2,735.76 per year and includes the pull-cord emergency-alert system, Estate Manager services, management fee, window cleaning, maintenance and insurance of the buildings and gardens.

Upon re-sale of the property the vendor is liable to pay back into the sinking fund a contribution calculated at 1.5% per annum of the original purchase price for the years owned. This information is correct as of the 21st April 2023.



- First floor apartment
- NO ONWARD CHAIN
- Communal gardens
- Walking distance to the town centre
- Over 60s only



Residents Lounge