



4 Millfield Park

Old Tupton, Chesterfield, S42 6AD

Offers In The Region Of £110,000



4 Millfield Park

Old Tupton, Chesterfield, S42 6AD

This exceptionally well-maintained two bedroom park home offers stylish, low-maintenance living with a bright and welcoming interior and well-tended outdoor space. Perfectly suited to those looking for single-level living in a peaceful setting, the home benefits from tasteful décor, quality fittings and excellent natural light throughout.

- Beautifully presented two bedroom park home
- Modern open plan kitchen and dining area with French doors
- Raised decking area — ideal for outdoor seating or entertaining
- Bright and spacious lounge with dual-aspect windows
- Generously sized master bedroom with full wall of built-in wardrobes
- Stylish shower room with contemporary suite
- Low-maintenance plot with attractive frontage
- Driveway providing off-road parking for multiple vehicles
- Peaceful residential setting, ideal for downsizers and retirement living
- Move-in ready condition with tasteful décor throughout





Accommodation

The accommodation includes a side entrance porch which leads into a central hallway. There is a contemporary open plan kitchen and dining area, fitted with sleek units and complemented by wood-effect flooring. French doors from the dining space open onto a raised decking area.

The spacious lounge features dual-aspect windows that flood the room with natural light and offer pleasant views of the surrounding area. There are two well-proportioned bedrooms, including a generous master with an entire wall of built-in wardrobes, providing ample storage space. The stylish family shower room is fully tiled and includes a modern suite with corner shower, vanity sink, and WC.

Externally, the home is set on a low-maintenance plot with an attractive frontage and neatly edged garden borders. A private driveway provides off-road parking for multiple vehicles.

This superb home is ready to move into and would make an ideal downsize, retirement option, or peaceful full-time residence.

Location - Millfield Park, Old Tupton

Millfield Park is a quiet, well-kept residential park in the village of Old Tupton, ideal for those looking to downsize or enjoy a more relaxed lifestyle. Surrounded by countryside yet close to local shops, bus routes, and a short drive from Chesterfield, it offers a great balance of peace and convenience.

Additional Information

- * Council Tax – Band A
- * Bottled LPG heating and hot water
- * EPC - Exempt
- * Pitch fees - £184.98
- * Must be 55 years old or over
- * Pets allowed on site

Please note although the property displays as Freehold online, Park Homes are neither Freehold or Leasehold.

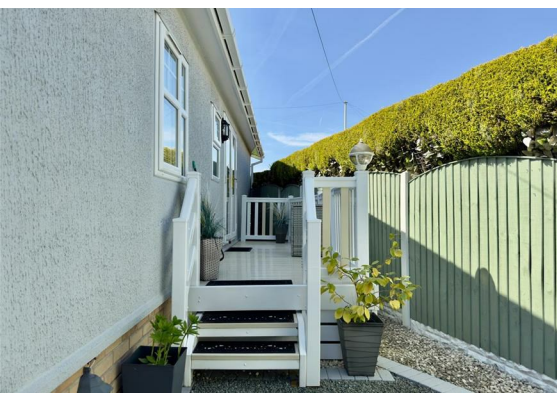

Floor Plan

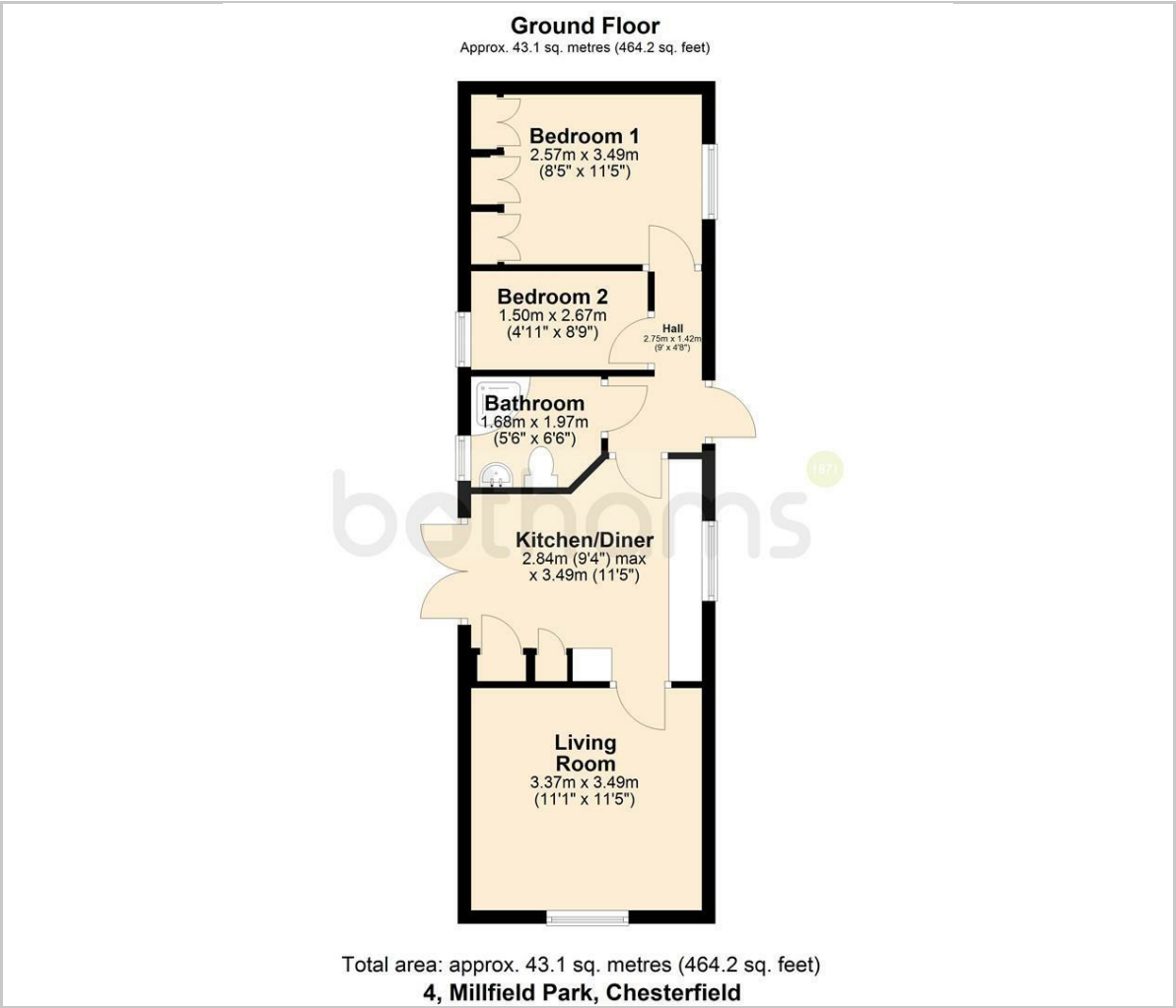

Viewing

Please contact our Chesterfield Residential Office on 01246 233121 if you wish to arrange a viewing appointment for this property or require further information.

Area Map

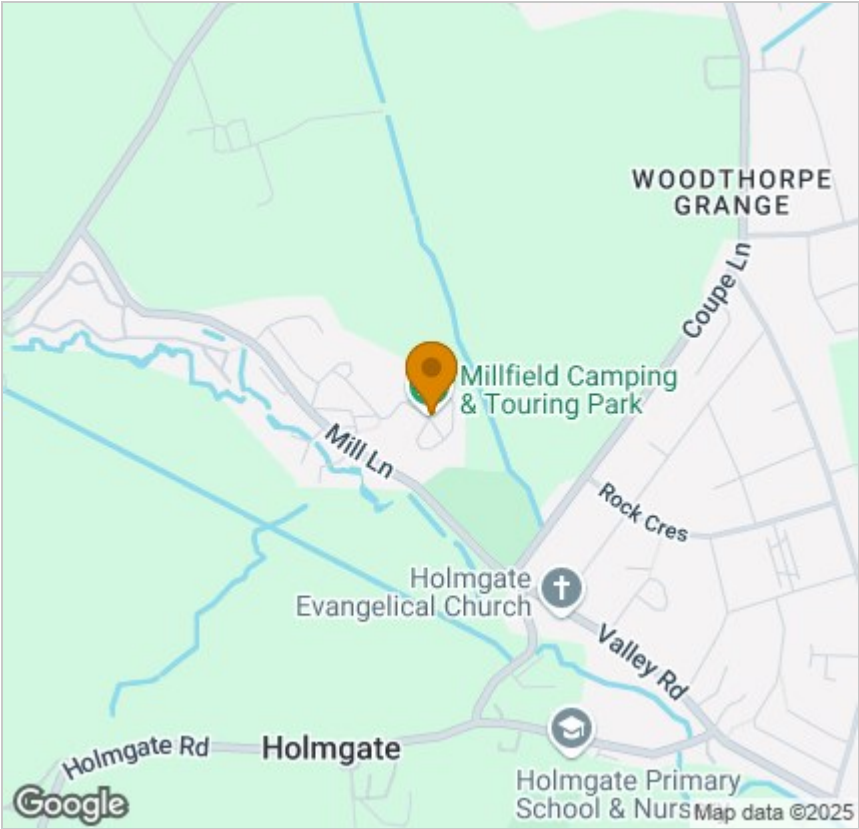

Energy Efficiency Graph

These particulars, whilst believed to be accurate are set out as a general outline only for guidance and do not constitute any part of an offer or contract. Intending purchasers should not rely on them as statements of representation of fact, but must satisfy themselves by inspection or otherwise as to their accuracy. No person in this firm's employment has the authority to make or give any representation or warranty in respect of the property.