

bothams¹⁸⁷¹



Flat 8 King Edward Street
, Shirebrook, NG20 8AU

£110 Per Week



Flat 8 King Edward Street

, Shirebrook, NG20 8AU

To let is this one bedroom ground floor flat in Shirebrook, located in a charming Tudor fronted building. The property has been newly decorated, offering a fresh feel throughout.

Conveniently located close to local amenities, including shops, cafes, and public transport links.

The new tenant will have to pay an additional £89.31 per month for electricity charges. This may vary dependant on usage and rising energy costs.

General



Floor Plan

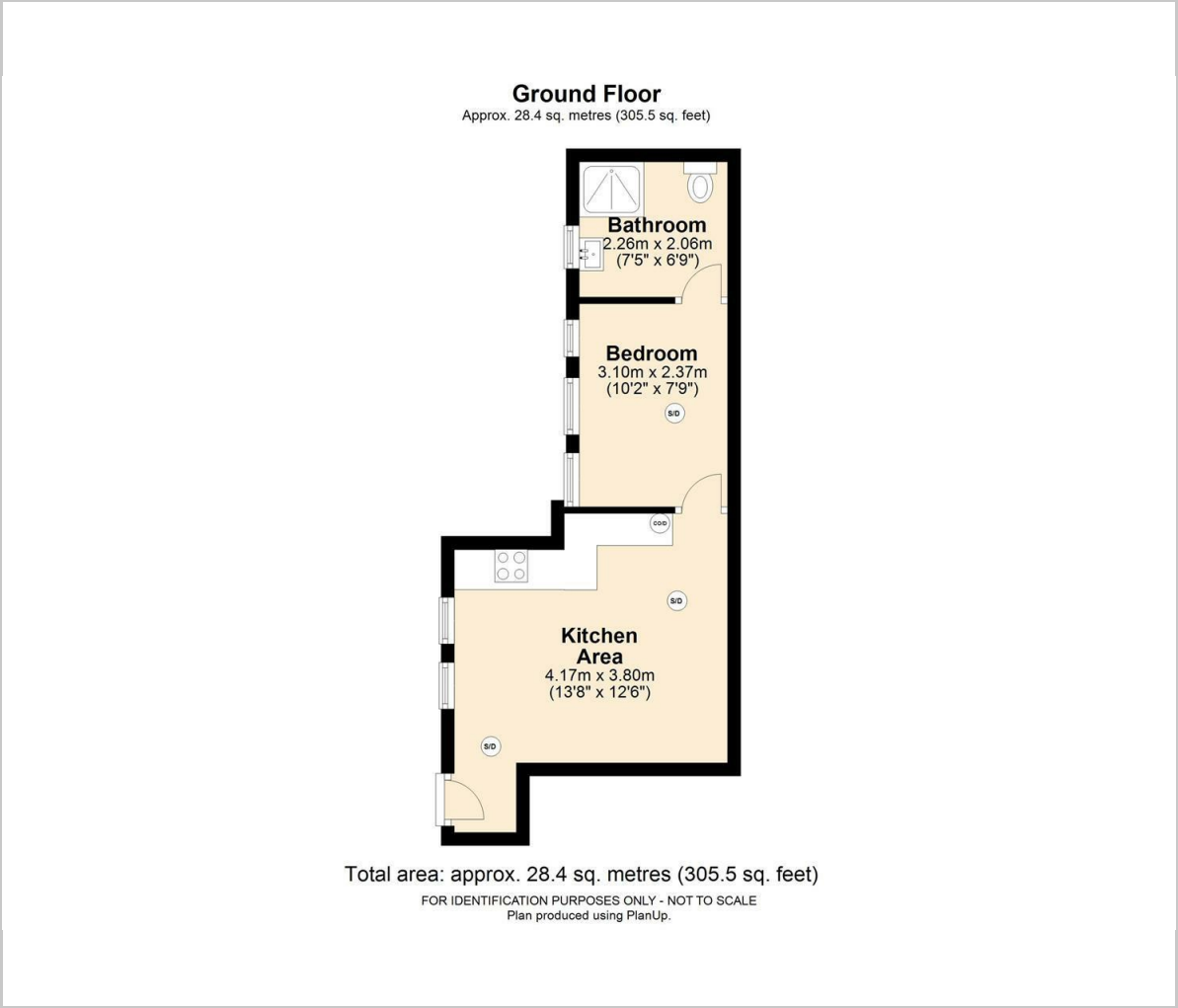

Viewing

Please contact our Chesterfield Residential Office on 01246 233121 if you wish to arrange a viewing appointment for this property or require further information.

These particulars, whilst believed to be accurate are set out as a general outline only for guidance and do not constitute any part of an offer or contract. Intending purchasers should not rely on them as statements of representation of fact, but must satisfy themselves by inspection or otherwise as to their accuracy. No person in this firms employment has the authority to make or give any representation or warranty in respect of the property.

Ravenside House 46 Park Road, Chesterfield, Derbyshire, S40 1XZ
Tel: 01246 233121 Email: enquiries@bothams.co.uk <https://www.bothams.co.uk/>

Area Map



Energy Efficiency Graph

