



## Montague Road, Clarendon Park

Offers Over £190,000

A two bedroom terraced home IN NEED OF MODERNISATION on Montague Road in Clarendon Park.

Council Tax band: A

Tenure: Freehold

EPC Energy Efficiency Rating: D



Knightsbridge  
Estate Agents

0116 274 5544







**Reception Room**

11' 0" x 10' 10" (3.35m x 3.30m)

With a door to the front elevation, window to the front elevation, wood effect laminate flooring, chimney breast, coving to ceiling and a radiator.

**Reception Room**

11' 0" x 10' 10" (3.35m x 3.30m)

With a window to the rear elevation, chimney breast with a wall-mounted gas fire, understairs cupboard and a radiator.

**Kitchen**

8' 5" x 5' 10" (2.57m x 1.78m)

With a window to the side elevation, door to the side elevation, wall-mounted combi boiler, sink and drainers, base unit with work surface over, space for a fridge freezer, space for a free-standing electric cooker and plumbing for a washing machine.



## **First Floor Landing**

### **Bedroom One**

12' 4" x 11' 1" (3.76m x 3.38m)

With two windows to the front elevation, chimney breast, fireplace with surround and a radiator.

### **Bedroom Two**

12' 5" x 11' 0" (3.78m x 3.35m)

With a window to the rear elevation, an overhead cupboard and a radiator.

### **Bathroom**

8' 10" x 5' 10" (2.69m x 1.78m)

With a window to the rear elevation, bath, WC, wash hand basin, tiled splashbacks, and a radiator.

### **Rear Garden**

A mature and established rear garden with a patio seating area, flower beds and a fenced perimeter.



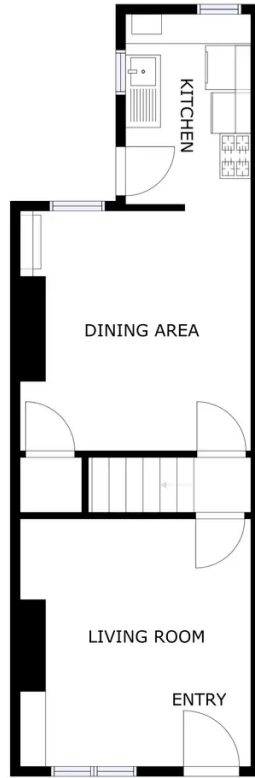

FLOOR 1

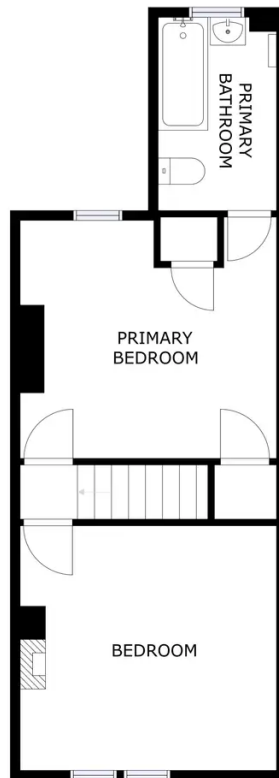

FLOOR 2



**We'll keep you moving...**



We must inform all prospective purchasers that the measurements are taken by an electronic take and are provided as a guide only and they should not be used as accurate measurements. We have not tested any mains services, gas or electric appliances, or fixtures and fittings mentioned in these details, therefore, prospective purchasers should satisfy themselves before committing to purchase. Intending purchasers must satisfy themselves by inspection or otherwise to the correctness of the statements contained in these particulars. Knightsbridge Estate Agents (nor any person in their employment) has any authority to make any representation or warranty in relation to the property. The floor plans are not to scale, and are intended for use as a guide to the layout of the property only. They should not be used for any other purpose. We are required by law to conduct anti-money laundering checks on all those selling or buying a property. Whilst we retain responsibility for ensuring checks and any ongoing monitoring are carried out correctly, the initial checks are carried out on our behalf by Lifetime Legal who will contact you once you have agreed to instruct us in your sale or had an offer accepted on a property you wish to buy. The cost of these checks is £60 (incl. VAT), which covers the cost of obtaining relevant data and any manual checks and monitoring which might be required. This fee will need to be paid by you in advance of us publishing your property (in the case of a vendor) or issuing a memorandum of sale (in the case of a buyer), directly to Lifetime Legal, and is non-refundable. We will receive some of the fee taken by Lifetime Legal to compensate for its role in the provision of these checks.