



Wellow Brook Court

Midsomer Norton, BA3 2DJ

£299,950

Launched by our Midsomer Norton office.

Looks can be deceiving and this is the perfect example. With its tardis like internal accommodation and ample parking, this is a fantastic home that is located near many amenities and walking distance to Midsomer Norton High Street.

- No onward chain!
- Great sized accommodation
- Three parking space and large garage
- En-suite to main bedroom
- Kitchen with built in appliances
- Move in ready

Viewing

Please contact our Bath Stone Property (MSN) Office on 01761 360144

if you wish to arrange a viewing appointment for this property or require further information.



3



2



2



C

Floor Plan

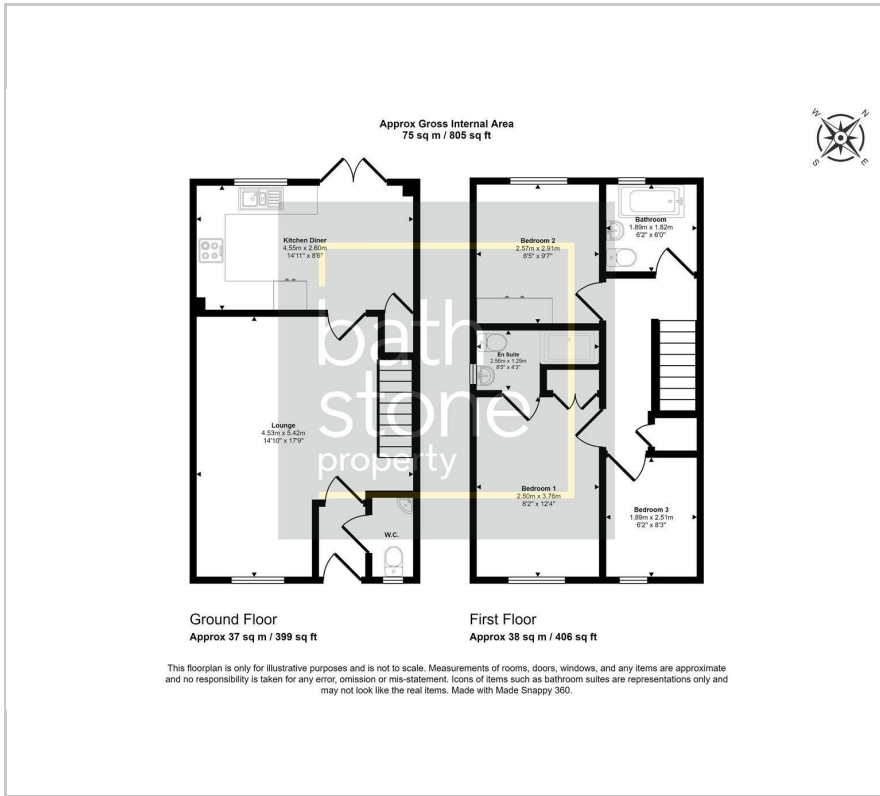

Area Map

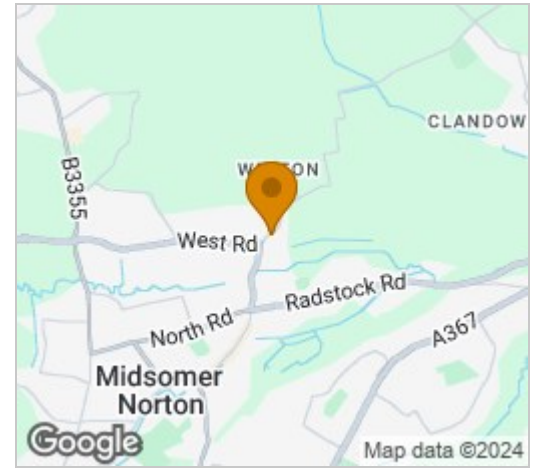

Energy Efficiency Graph

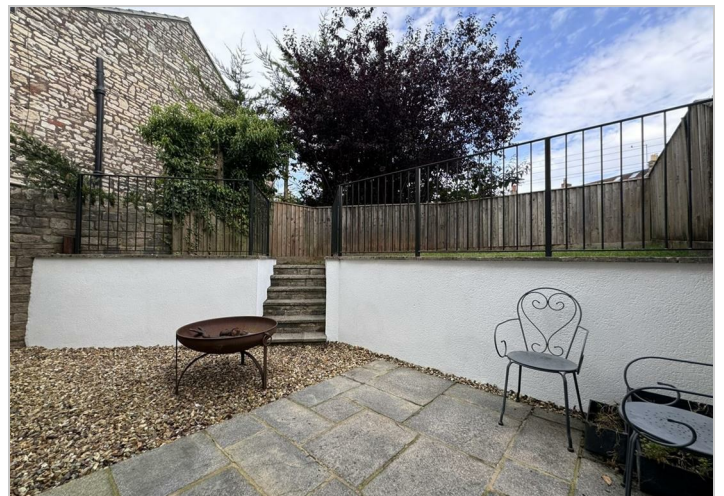
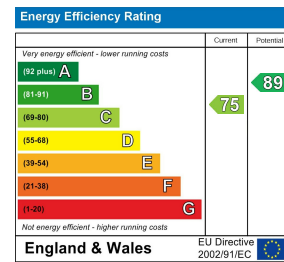

These particulars, whilst believed to be accurate are set out as a general outline only for guidance and do not constitute any part of an offer or contract. Intending purchasers should not rely on them as statements of representation of fact, but must satisfy themselves by inspection or otherwise as to their accuracy. No person in this firm's employment has the authority to make or give any representation or warranty in respect of the property.