



Heather Drive,

Price £310,000

**FOR SALE**





- Two Well-Sized Bedrooms
- Mid-Terrace
- Lounge Diner
- Two Off Street Parking Spaces
- Easy Maintenance South West Facing Garden
- CuL-de-Sac

## THE PROPERTY

Stylish and well-maintained two bedroom, mid-terrace home in a quiet cul-de-sac in Odd Down. This move-in-ready property features a bright open-plan lounge/diner, kitchen, two well-sized bedrooms, a sleek shower room, and a low-maintenance south west facing rear garden. The property also comes with two off street parking spaces.

Approx Gross Internal Area  
53 sq m / 575 sq ft

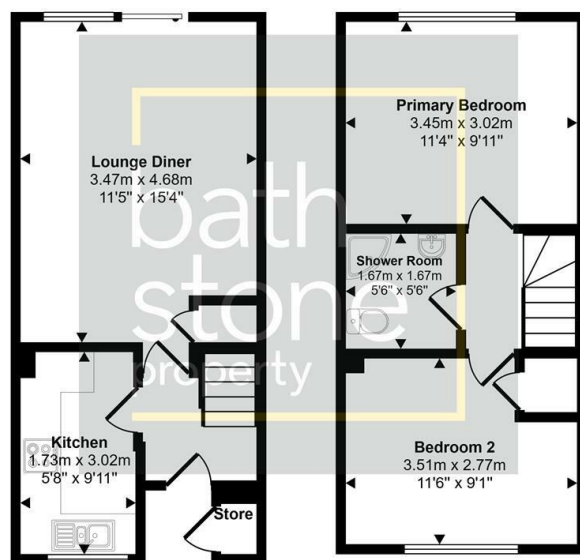

This floorplan is only for illustrative purposes and is not to scale. Measurements of rooms, doors, windows, and any items are approximate and no responsibility is taken for any error, omission or mis-statement. Icons of items such as bathroom suites are representations only and may not look like the real items. Made with Made Snappy 360.



### Energy Efficiency Rating

|   | Current                    | Potential |
|---|----------------------------|-----------|
| Very energy efficient - lower running costs |                            |           |
| (92 plus) <b>A</b>                          |                            | 87        |
| (81-91) <b>B</b>                            |                            |           |
| (69-80) <b>C</b>                            | 72                         |           |
| (55-68) <b>D</b>                            |                            |           |
| (39-54) <b>E</b>                            |                            |           |
| (21-38) <b>F</b>                            |                            |           |
| (1-20) <b>G</b>                             |                            |           |
| Not energy efficient - higher running costs |                            |           |
| <b>England &amp; Wales</b>                  | EU Directive<br>2002/91/EC |           |