



Westbury View,

£325,000

FOR SALE



- Three Bedrooms
- Garden to the front and to the rear
- Fireplace
- Garage with parking in front
- Downstairs W/C
- End-Terrace

THE PROPERTY

Situated in the area of Peasedown St. John, Bath, this delightful end-terrace house offers a perfect blend of comfort and convenience. The property offers three bedrooms, making it an ideal home for families or those seeking extra space.

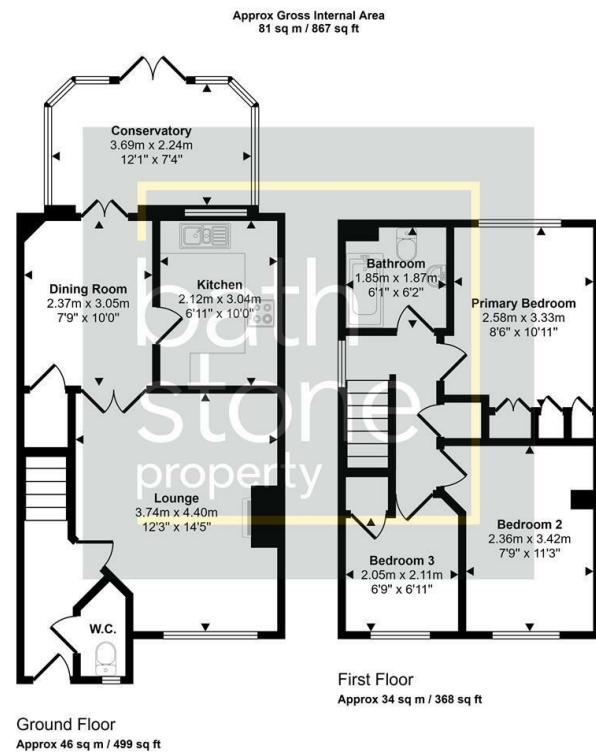

This floorplan is only for illustrative purposes and is not to scale. Measurements of rooms, doors, windows, and any items are approximate and no responsibility is taken for any error, omission or mis-statement. Icons of items such as bathroom suites are representations only and may not look like the real items. Made with Made Snappy 360.



Energy Efficiency Rating		
	Current	Potential
Very energy efficient - lower running costs		
(92 plus) A		86
(81-91) B		
(69-80) C	69	
(55-68) D		
(39-54) E		
(21-38) F		
(1-20) G		
Not energy efficient - higher running costs		
England & Wales		EU Directive 2002/91/EC