



Beechen Cliff Road,

£350,000

FOR SALE



- No Chain
- Grade II Listed
- Two Double Bedrooms
- Character
- Heart of Bear Flat
- Beautiful Grounds

THE PROPERTY

Located in the heart of Bear Flat on Beechen Cliff Road, this charming first-floor apartment offers a delightful blend of modern comfort and historical character. With two spacious double bedrooms, grand lounge diner, newly refurbished kitchen and family bathroom.

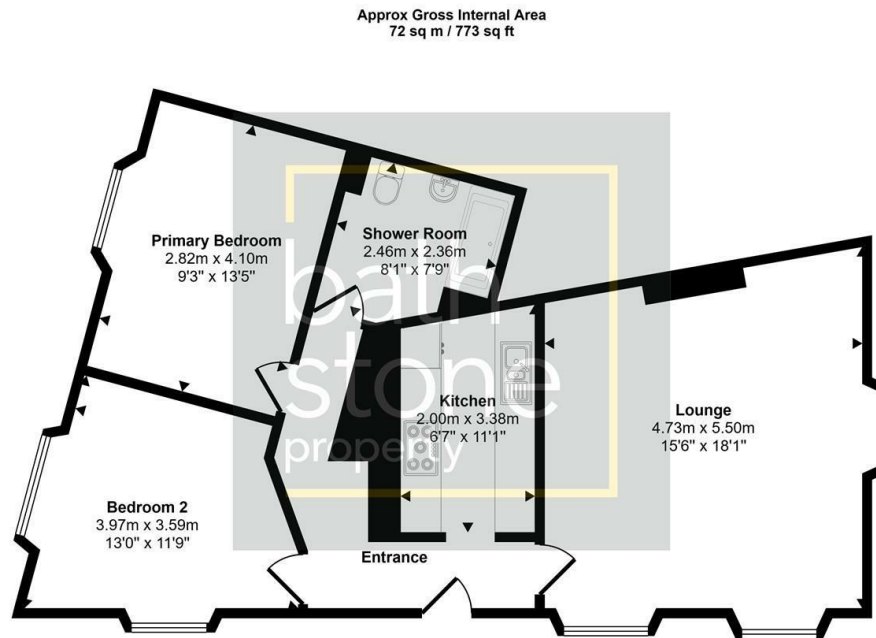

Floorplan

This floorplan is only for illustrative purposes and is not to scale. Measurements of rooms, doors, windows, and any items are approximate and no responsibility is taken for any error, omission or mis-statement. Icons of items such as bathroom suites are representations only and may not look like the real items. Made with Made Snappy 360.

