



## 18 Victoria Buildings

Bath, BA2 3EH

Offers In Excess Of £550,000

This exceptionally deceptive property is full of character and charm, making it a rare find in the heart of Bath. Whether you are looking for a family home or a stylish retreat, this residence is sure to impress. Don't miss the opportunity to make this beautiful house your new home.

- Grade II listed
- Full of Character
- Mid-Terrace
- Spacious
- Two Reception Rooms
- Kirchen Diner
- Utility and Downstairs WC
- Good Size Garden

### Viewing

Please contact our Bath Stone Property Office on 01225422224 if you wish to arrange a viewing appointment for this property or require further information.





Floor Plan

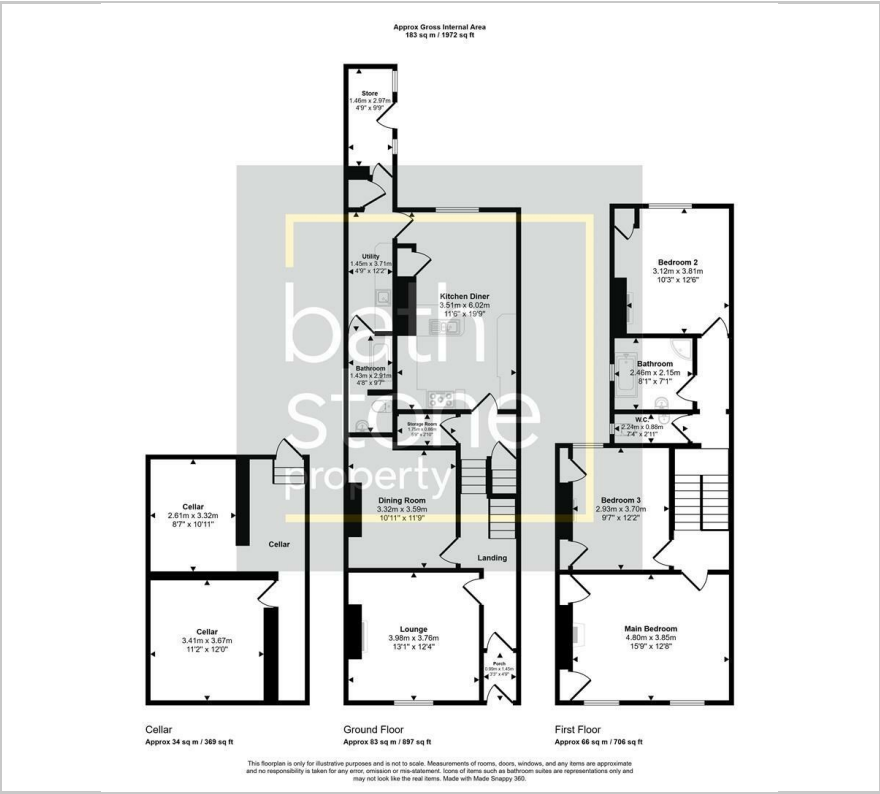

Area Map



Energy Efficiency Graph

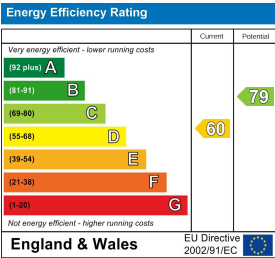

These particulars, whilst believed to be accurate are set out as a general outline only for guidance and do not constitute any part of an offer or contract. Intending purchasers should not rely on them as statements of representation of fact, but must satisfy themselves by inspection or otherwise as to their accuracy. No person in this firm's employment has the authority to make or give any representation or warranty in respect of the property.