



27 Lytton Gardens

Bath, BA2 1LW

Offers In Excess Of £475,000

This versatile dormer bungalow in Lytton Gardens is a rare find in Bath, combining spacious living areas, a beautiful garden, and practical amenities. With three well-proportioned bedrooms, this property is ideal for families or those looking for extra space to accommodate guests or create a home office.

- Detached
- Dormer Bungalow
- Three Bedrooms
- Large Plot
- Garage and Driveway for Ample Cars
- Two Reception Rooms
- Cul-de-Sac
- Two Family Bathrooms

Viewing

Please contact our Bath Stone Property Office on 01225422224 if you wish to arrange a viewing appointment for this property or require further information.



3



1



2



C

Floor Plan

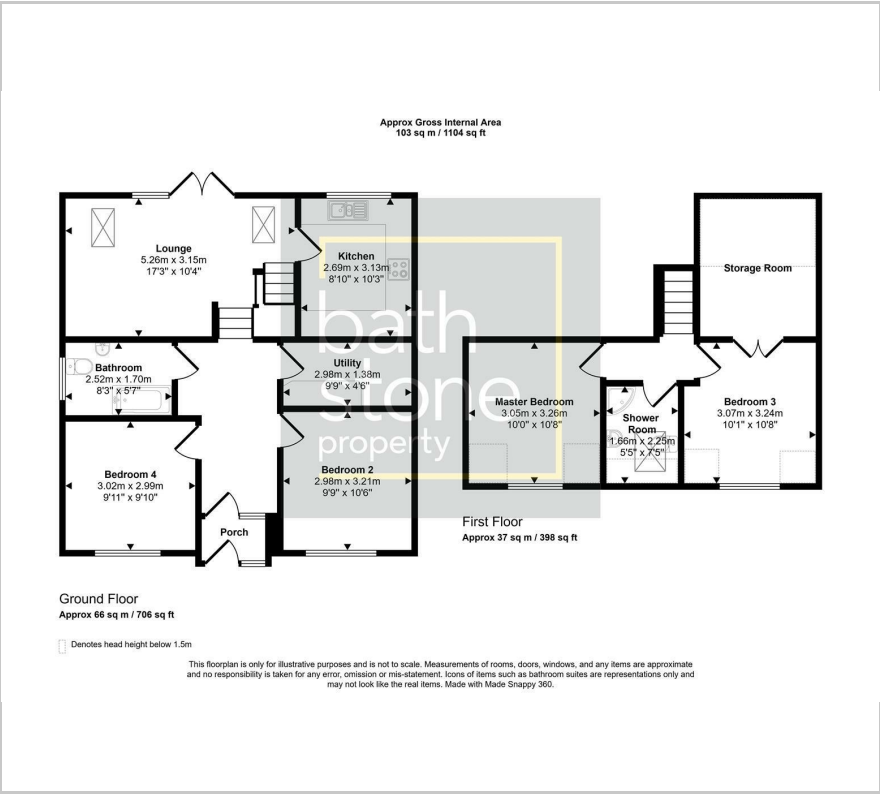

Area Map



Energy Efficiency Graph

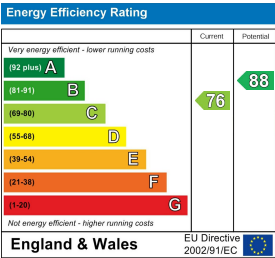

These particulars, whilst believed to be accurate are set out as a general outline only for guidance and do not constitute any part of an offer or contract. Intending purchasers should not rely on them as statements of representation of fact, but must satisfy themselves by inspection or otherwise as to their accuracy. No person in this firms employment has the authority to make or give any representation or warranty in respect of the property.