



## 104 Southdown Road

Bath, BA2 1JH

Offers In Excess Of £475,000

This semi-detached house on Southdown Road is a spacious and inviting home, perfect for those looking to enjoy the vibrant lifestyle that Bath has to offer. With its charming garden, versatile living spaces, and excellent location, this property is a must-see for anyone seeking their next home.

- Three bedrooms
- Semi-Detached
- Garage
- Outside Bar
- Three Reception Rooms
- Utility
- Spacious
- Rear access

### Viewing

Please contact our Bath Stone Property Office on 01225422224 if you wish to arrange a viewing appointment for this property or require further information.



3



1



3



D



Floor Plan

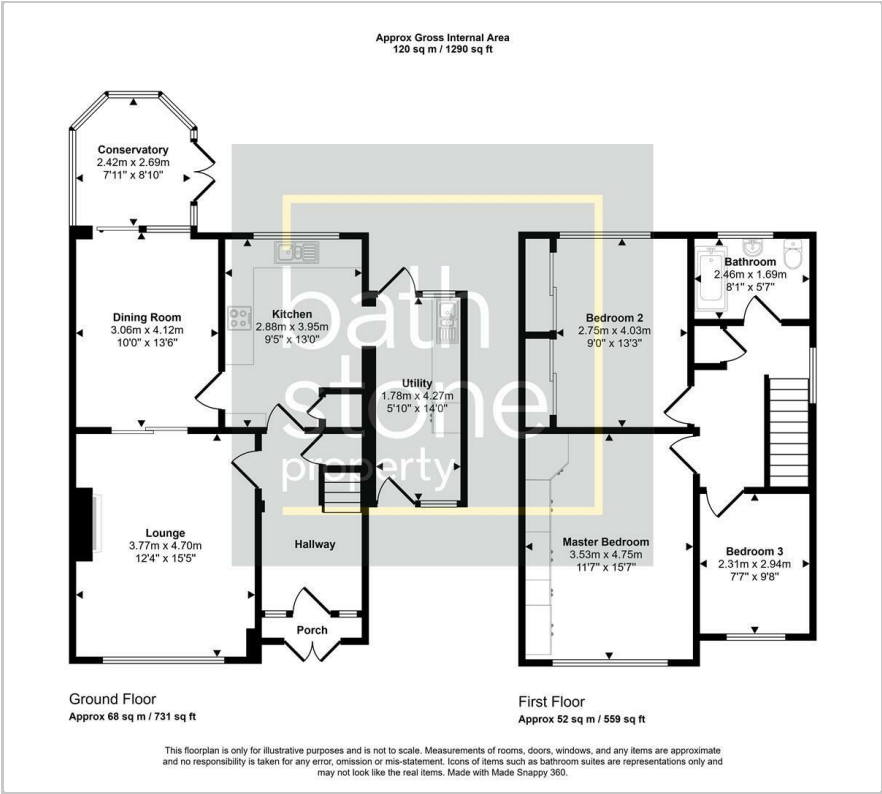

Area Map



Energy Efficiency Graph

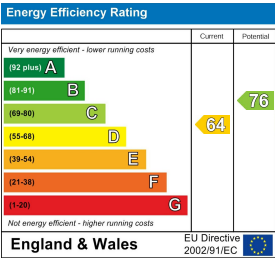

These particulars, whilst believed to be accurate are set out as a general outline only for guidance and do not constitute any part of an offer or contract. Intending purchasers should not rely on them as statements of representation of fact, but must satisfy themselves by inspection or otherwise as to their accuracy. No person in this firms employment has the authority to make or give any representation or warranty in respect of the property.