



5 Farleigh Wick

Bradford-On-Avon, BA15 2PU

Asking Price £575,000

Planning permission approved for a double story extension and two single story extensions; making this home into a 4 bed, 2 bath and 1 en-suite. This secluded and charming 2-bedroom detached cottage located in the picturesque village of Farleigh Wick, Bradford-On-Avon. The house is surrounded by a private, peaceful garden which is just shy of half an acre, offering 2 large double bedrooms, 2 receptions room, one including a cosy fireplace and ample parking. There is an added bonus of a garden cabin, which includes the luxury of power and lighting, making it the perfect home office. This home gives a perfect blend of modern living in a countryside setting.

- Large, private Garden
- Ample parking
- Period fireplace features
- Additional home office

Located between Bath and Bradford On Avon

Approved planning permission for a double story extension and two single story extensions

Viewing

Please contact our Bath Stone Property Office on 01225422224 if you wish to arrange a viewing appointment for this property or require further information.



Floor Plan

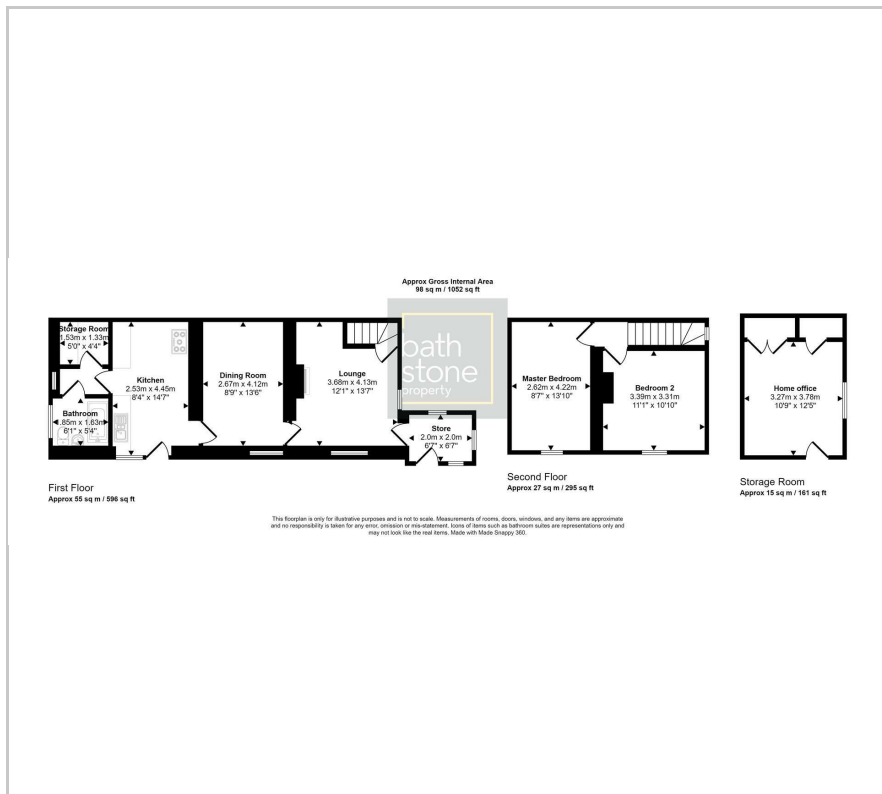

Area Map



Energy Efficiency Graph

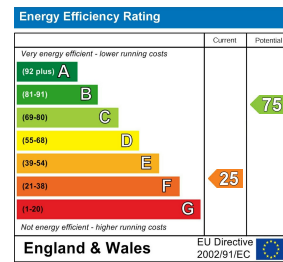

These particulars, whilst believed to be accurate are set out as a general outline only for guidance and do not constitute any part of an offer or contract. Intending purchasers should not rely on them as statements of representation of fact, but must satisfy themselves by inspection or otherwise as to their accuracy. No person in this firm's employment has the authority to make or give any representation or warranty in respect of the property.