



Wellsway,

£340,000

FOR SALE

bath
stone
property

- Two Bedroom
- High Ceilings
- Fantastic Location at the Heart of Bear Flat
- First Floor Apartment
- Spacious

THE PROPERTY

This super-spacious maisonette situated on the first floor, with access from Bruton Avenue, offers very generous accommodation including a huge lounge diner and master bedroom. It occupies a fantastically convenient position in the heart of Bear Flat close to many shops, services and parks and the gentle stroll downhill to the station and the City of Bath.

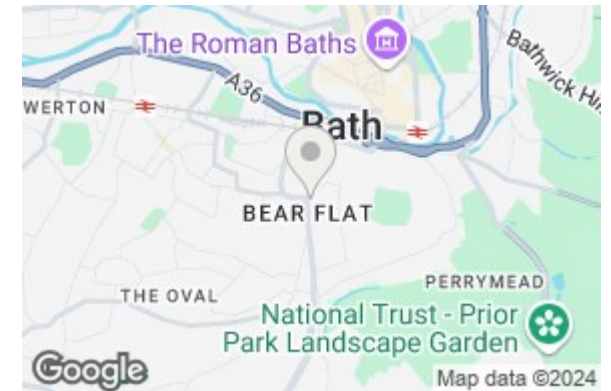
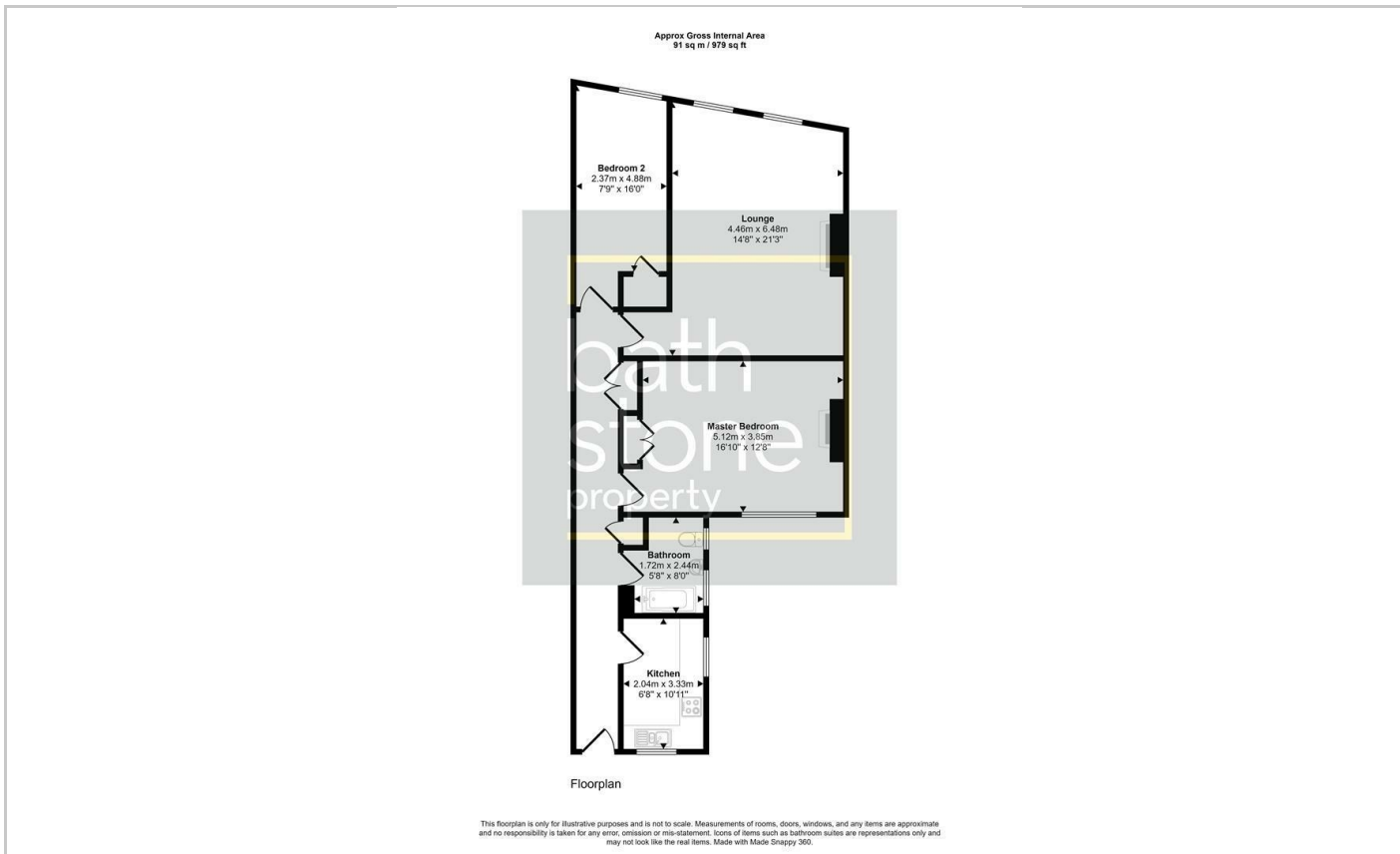

Energy Efficiency Rating		Current	Potential
Very energy efficient - lower running costs			
(92 plus) A			
(81-91) B			
(69-80) C			69
(55-68) D			
(39-54) E		43	
(21-38) F			
(1-20) G			
Not energy efficient - higher running costs			
England & Wales		EU Directive 2002/91/EC	