



Beech Grove,

£425,000

FOR SALE



- No Chain
- Three Bedrooms
- Large Private Garden
- Semi-Detached
- Driveway for Ample Parking
- Large Open Plan Living

THE PROPERTY

Beech Grove is being sold with no chain, it is a spacious three bedroom home with driveway for ample parking, large private garden and two family bathrooms. Don't miss out on the opportunity to make this house your home and give us a call 01225 422224

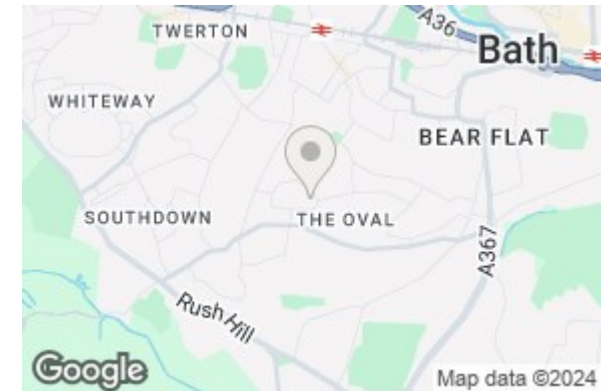
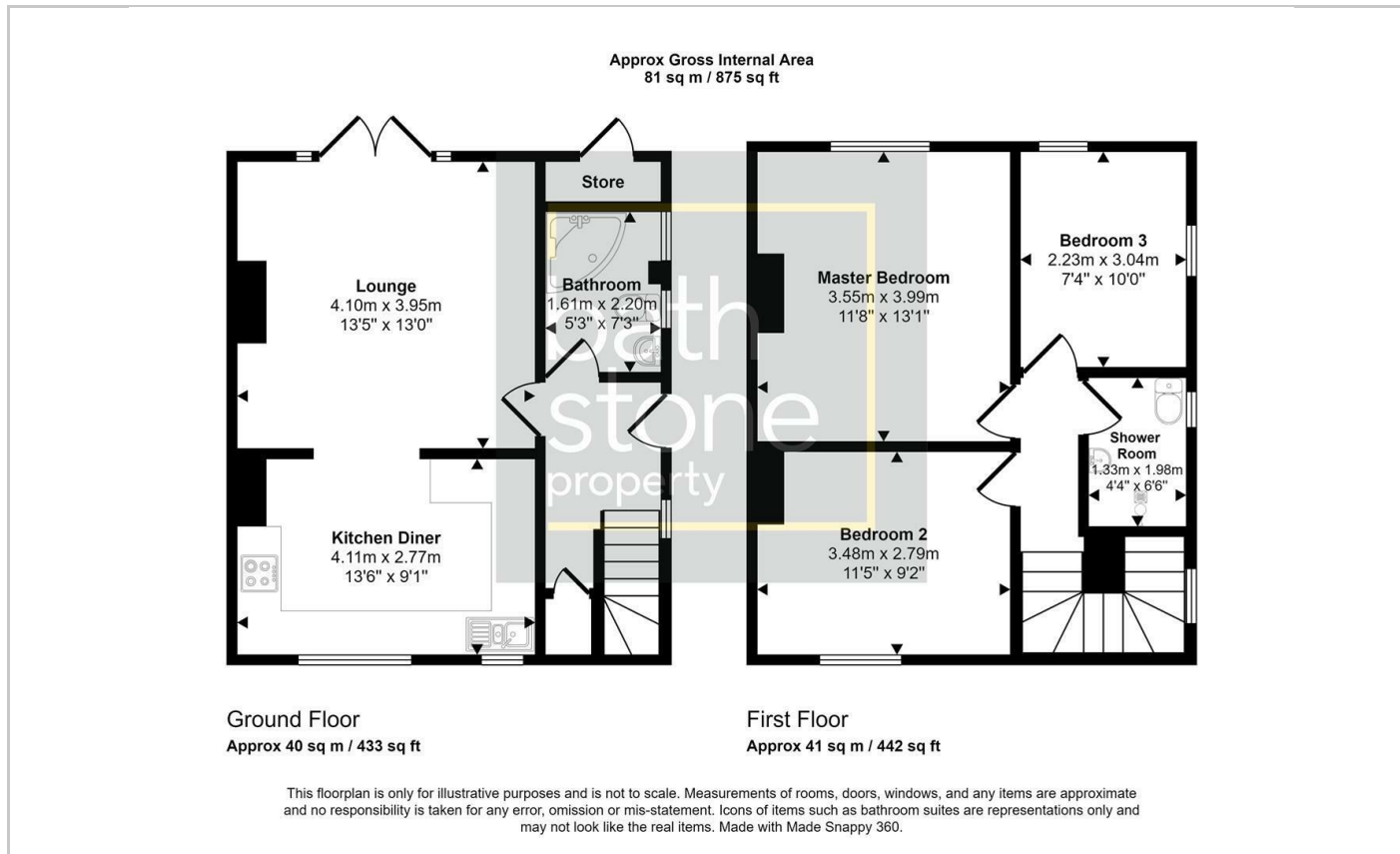

| Energy Efficiency Rating | | Current | Potential |
|---------------------------------------------|---|----------------------------|-----------|
| Very energy efficient - lower running costs | | | |
| (92 plus) | A | | |
| (81-91) | B | | 83 |
| (69-80) | C | | |
| (55-68) | D | 63 | |
| (39-54) | E | | |
| (21-38) | F | | |
| (1-20) | G | | |
| Not energy efficient - higher running costs | | | |
| England & Wales | | EU Directive 2002/91/EC | |