



Vernham Grove, Odd Down

£300,000

FOR SALE



- Mid-terraced home
- Two double bedrooms
- Great location for access in and out the City
- Perfect first family home
- Kitchen diner
- Southwest facing garden
- Off street parking for two cars

Approx Gross Internal Area
61 sq m / 655 sq ft

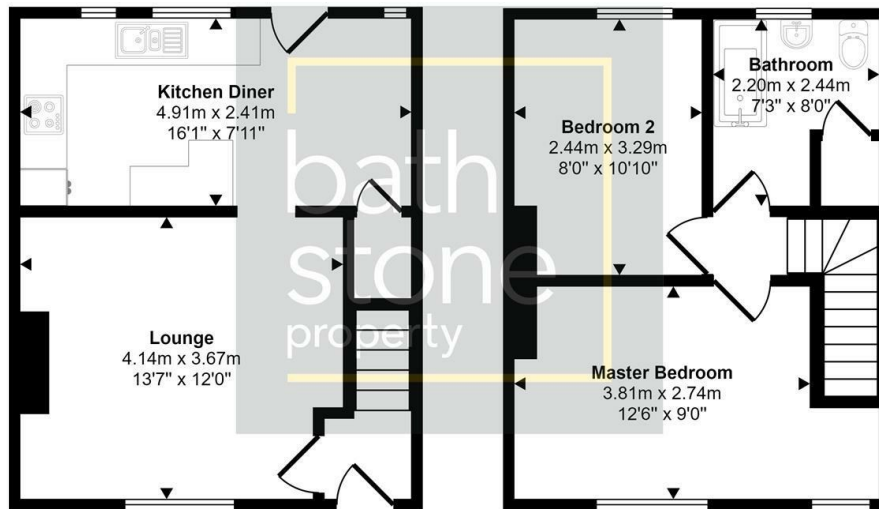

Ground Floor
Approx 31 sq m / 333 sq ft

First Floor
Approx 30 sq m / 322 sq ft

This floorplan is only for illustrative purposes and is not to scale. Measurements of rooms, doors, windows, and any items are approximate and no responsibility is taken for any error, omission or mis-statement. Icons of items such as bathroom suites are representations only and may not look like the real items. Made with Made Snappy 360.

THE PROPERTY

A superb two bedroom home on the south slopes of Bath giving you great access in and out the city. The property comes with off street parking and a south/west facing garden.



Energy Efficiency Rating

	Current	Potential
Very energy efficient - lower running costs		
(92 plus) A		90
(81-91) B		
(69-80) C	74	
(55-68) D		
(39-54) E		
(21-38) F		
(1-20) G		
Not energy efficient - higher running costs		
England & Wales	EU Directive 2002/91/EC	