



Ground Floor Flat, 42 Lorne Road

Westmoreland, BA2 3BZ

Price £300,000



Ground Floor Flat, 42 Lorne Road



Description

An impressive one bedroom, garden floor apartment located in the popular location of Oldfield Park. The property is a must to view to appreciate the spaciousness.

No Chain
Ground floor
Character
Driveway Parking

Spacious
Kitchen Diner
Good Size Garden
Good Location





Floor Plan

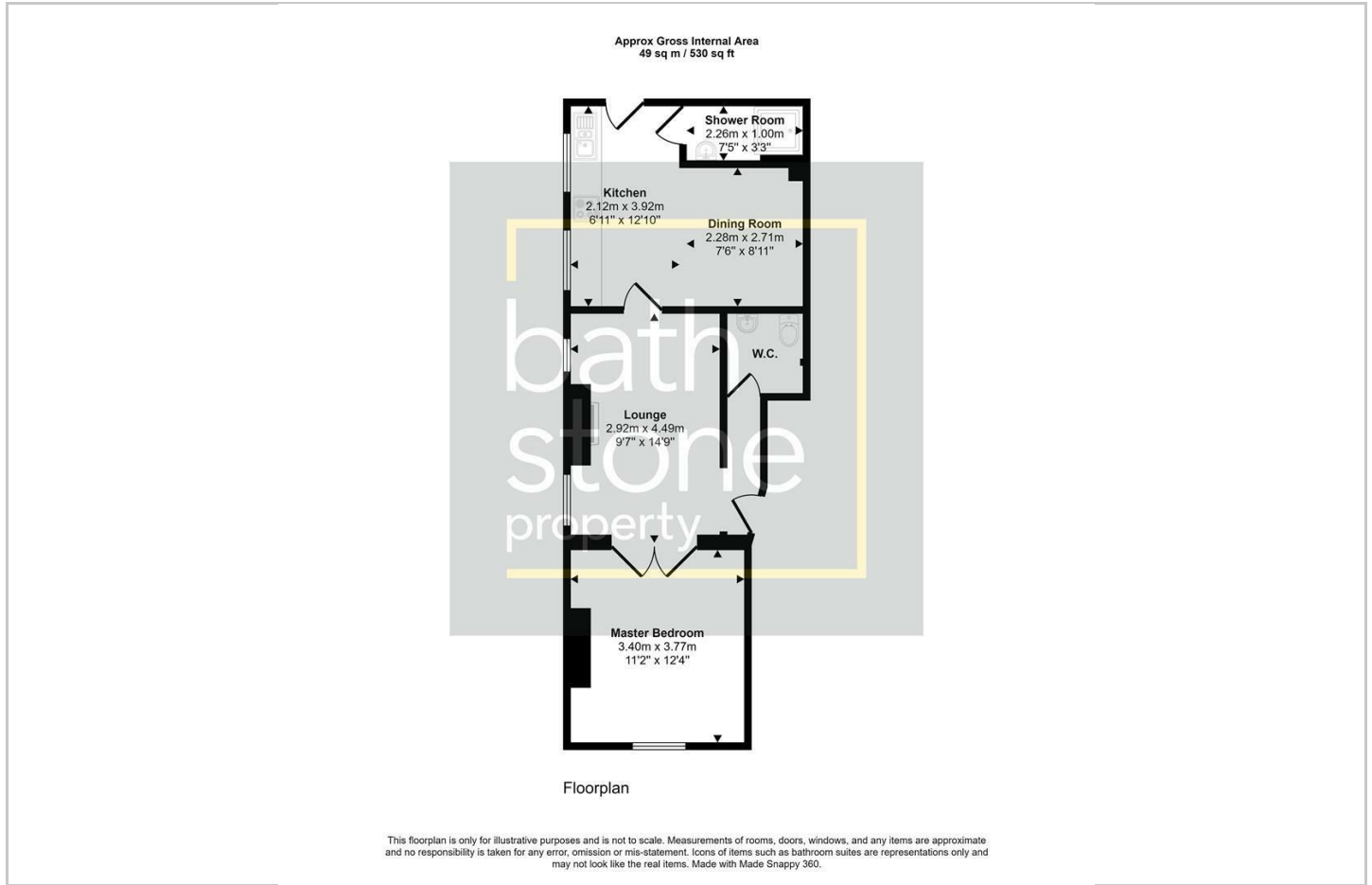

Area Map

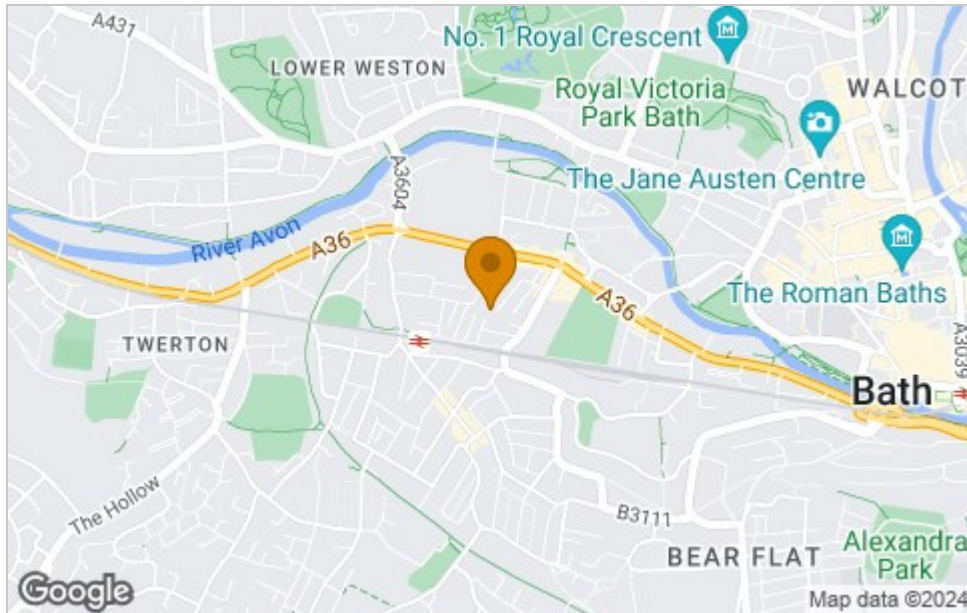

Energy Efficiency Graph

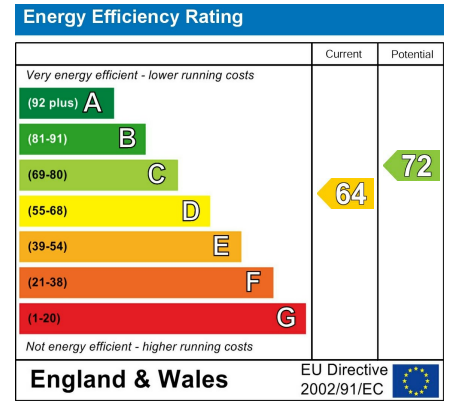

Viewing

Please contact our Bath Stone Property Office on 01225422224 if you wish to arrange a viewing appointment for this property or require further information.

These particulars, whilst believed to be accurate are set out as a general outline only for guidance and do not constitute any part of an offer or contract. Intending purchasers should not rely on them as statements of representation of fact, but must satisfy themselves by inspection or otherwise as to their accuracy. No person in this firm's employment has the authority to make or give any representation or warranty in respect of the property.