



8 Lansdown View

Faulkland, BA3 5UT

£289,950

Launched by our Midsomer Norton branch!
Welcome to this delightful three bedroom house nestled in the charming village of Faulkland. Offering views to the front and a great South facing rear garden, this property provides a perfect blend of serene countryside living and modern comfort.

Sellers found!
Fantastic village location
South facing rear garden
Views to front across fields
Two reception rooms
Generously sized throughout

Viewing

Please contact our Bath Stone Property (MSN) Office on 01761 360144 if you wish to arrange a viewing appointment for this property or require further information.



3



1



2



E

Floor Plan

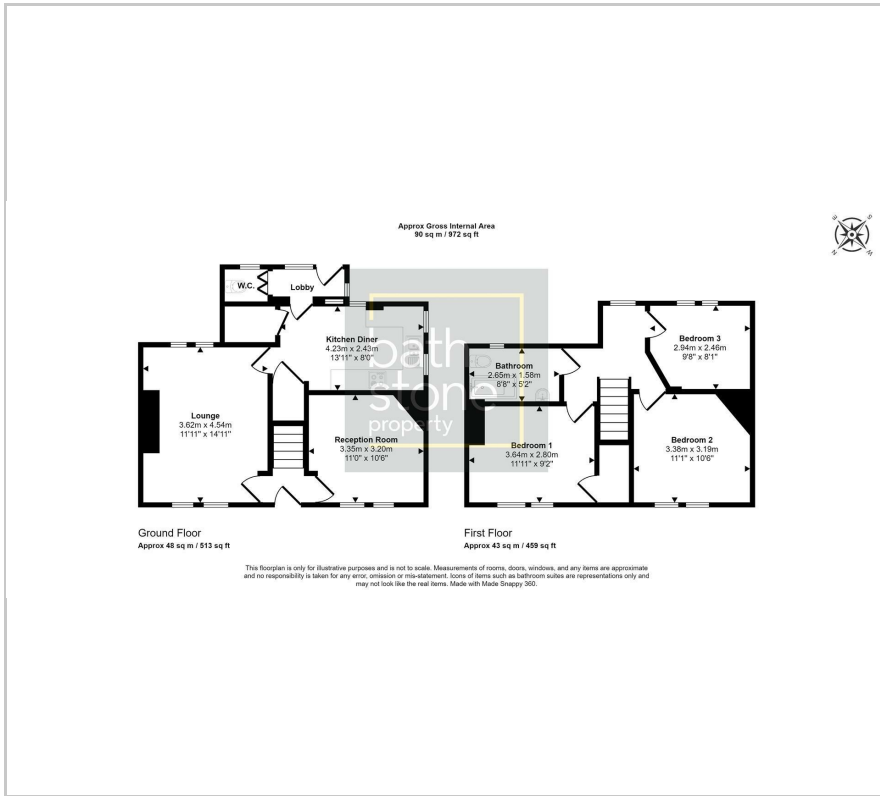

Area Map



Energy Efficiency Graph

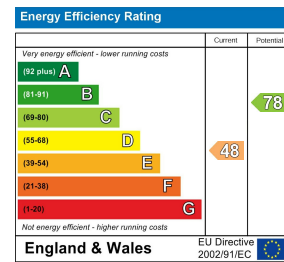

These particulars, whilst believed to be accurate are set out as a general outline only for guidance and do not constitute any part of an offer or contract. Intending purchasers should not rely on them as statements of representation of fact, but must satisfy themselves by inspection or otherwise as to their accuracy. No person in this firm's employment has the authority to make or give any representation or warranty in respect of the property.