



2 West View Crocombe

Timsbury, Bath, BA2 0SJ

Offers In Excess Of £365,000

A fantastic FAMILY HOME being offered as NO CHAIN!!! Located on a no through road surrounding by open fields. There is a beautiful OPEN PLAN KITCHEN/DINER/BREAKFAST ROOM, four bedrooms, family bathroom, 2WC, utility, enclosed rear garden and driveway parking. An internal viewing is highly recommended!

- No Chain
- Four Bedrooms
- Character
- Kitchen/Diner
- Utility
- Driveway
- Good Size Garden
- Semi-Detached

Viewing

Please contact our Bath Stone Property Office on 01225422224 if you wish to arrange a viewing appointment for this property or require further information.



4



1



1



D

Floor Plan

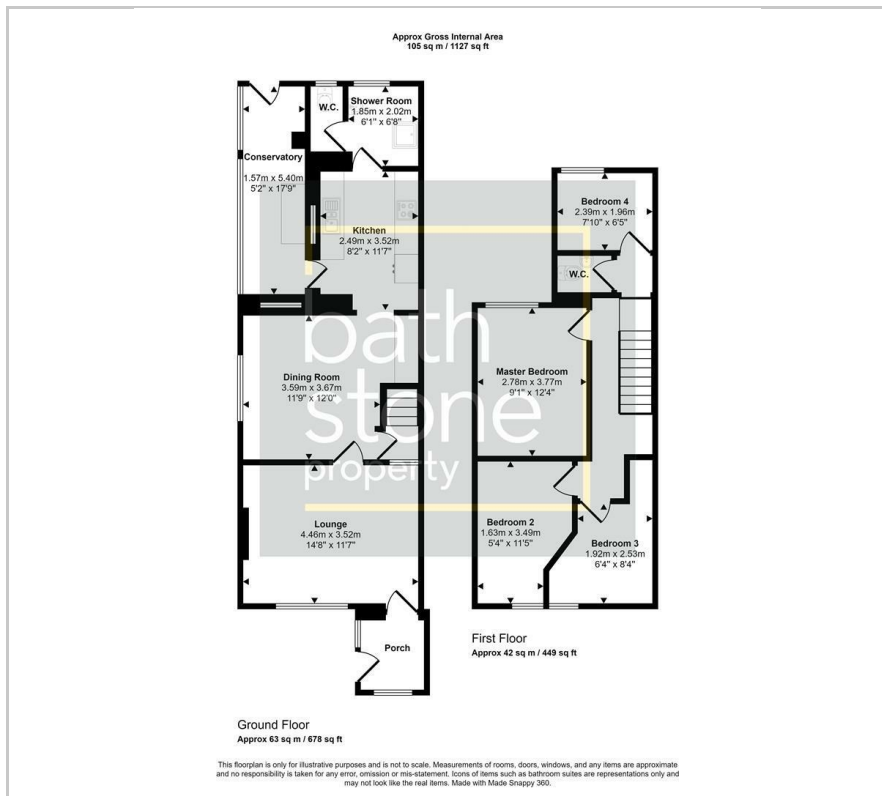

Area Map



Energy Efficiency Graph

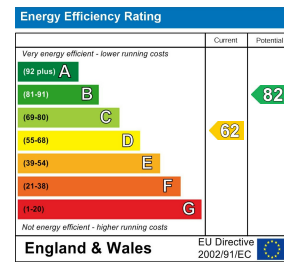

These particulars, whilst believed to be accurate are set out as a general outline only for guidance and do not constitute any part of an offer or contract. Intending purchasers should not rely on them as statements of representation of fact, but must satisfy themselves by inspection or otherwise as to their accuracy. No person in this firm's employment has the authority to make or give any representation or warranty in respect of the property.