



Gregley Ashford Road, Bakewell, Derbyshire, DE45 1GL

Saxton Mee

Gregley Ashford Road

£725,000

Fabulous Far Reaching Views

This beautifully presented detached property offers an exceptional blend of space, style and modern comfort, having been extensively renovated by the current owners to an impeccable standard. Enjoying an enviable position on the edge of town adjoining open countryside, it boasts superb far-reaching views while being within easy reach of the Riverside Works development with Thornbridge Brewery & Tap Room, a gym, Aldi, local walks and the many amenities and leisure facilities of historic Bakewell.

Designed with a focus on light, space, and quality, the accommodation is versatile and airy throughout. The welcoming entrance hall leads to a cosy sitting room with a bay window and a log-burning stove, creating a warm and inviting atmosphere. The heart of the home is the thoughtfully designed dining kitchen, fitted with a Belfast sink, a range of quality units and appliances and patio doors opening to the rear garden, ideal for entertaining. A practical utility room, two generous double bedrooms (one with a bay window) and a stylish shower room complete the ground floor.

Upstairs, a bright landing with built-in storage and study space leads to two further double bedrooms, a luxurious bathroom with a separate shower enclosure and a further bedroom or study, perfect for guests or home working.

Outside, the property is approached via a generous driveway providing off-road parking for several vehicles, with an attractive, well-stocked front garden. To the rear is a beautifully landscaped garden featuring a seating terrace, a timber summer house and a lawn with specimen shrubs and trees, all backing onto open countryside.

Combining a high-end finish with a relaxed lifestyle focus, this superb four/five bedroom, two-bathroom home offers spacious, light-filled accommodation in a highly sought-after location, perfectly blending modern living with the charm of Bakewell's countryside setting.



- Stunning Views & Adjoining Open Countryside
- Immaculately Presented & Completed To A High Specification
- Close To Excellent Amenities & Leisure Facilities
- Generous Gardens Adjoining Open Countryside
- Spacious & Flexible Living Accommodation
- Off Road Parking For Several Vehicles
- Easy Commutable Distance Of Major Commercial Centres
- Within Lady Manners School Catchment
- EPC: C
- Viewings: Bakewell Office





Gregley



Ground Floor
Approximate Floor Area
910 sq.ft
(84.51 sq.m.)

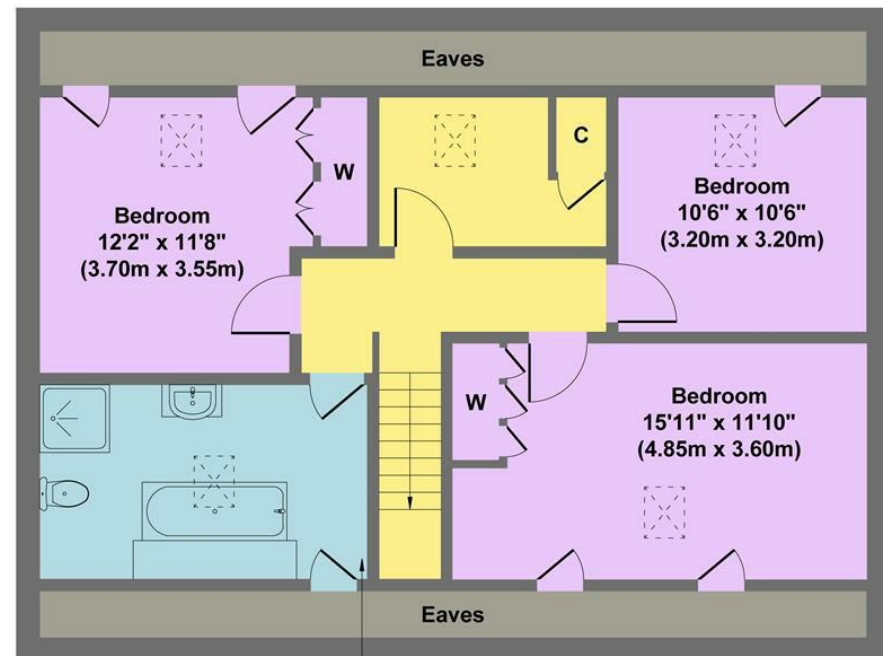

First Floor
Approximate Floor Area
711 sq.ft
(66.06 sq.m.)

Approx. Gross Internal Floor Area 1621 sq.ft / 150.57 sq.m

Illustration for identification purposes only. Measurements are approximate, not to scale

While we endeavour to make our sales particulars fair, accurate and reliable, they are only a general guide to the property and, accordingly, if there is any point, which is of particular importance to you, please contact the relevant office. The Agents have not tested any apparatus, equipment, fittings or services and so cannot verify they are in working order. The buyer is advised to obtain verification. Please note all the measurement details are approximate and should not be relied upon as exact. All plans, floor plans and maps are for guidance purposes only and are not to scale. Under no circumstances should they be relied upon as exact or for use in planning carpets and other such fixtures, fittings or furnishings. YOUR HOME IS AT RISK IF YOU DO NOT KEEP UP REPAYMENTS ON A MORTGAGE OR OTHER LOAN SECURED ON IT. 'A Life Assurance policy may be requested.' 'Written Quotations of credit terms available on request.'

Banner Cross
T: 0114 268 3241
E: bannercross@saxtonmee.co.uk
www.saxtonmee.co.uk

Hathersage
T: 01433 650009
E: hathersage@saxtonmee.co.uk

Bakewell
T: 01629 815307
E: bakewell@saxtonmee.co.uk

Matlock
T: 01629 828250
E: matlock@saxtonmee.co.uk

