



Fern Lea Manchester Road, Tideswell, Derbyshire, SK17 8LL

Saxton Mee

Fern Lea Manchester Road

Offers In The Region Of

£295,000

A Delightful Cottage in a Desirable Derbyshire Village.

Set in the heart of the sought-after Peak District village of Tideswell, this charming two double bedroom stone-built character cottage offers characterful accommodation with lovely outdoor spaces and no upward chain. Tideswell is a thriving and picturesque village known for its strong community spirit and excellent amenities including local shops, café, country inns and restaurants. Surrounded by spectacular Derbyshire countryside, the village is a gateway to a wealth of outdoor pursuits, while remaining within easy reach of major commercial centres, making it equally suited as a main residence or a holiday retreat.

The cottage blends period charm with tasteful modern touches and features an entrance lobby leading into a well-equipped dining kitchen with exposed beams, a stone-flagged floor, a range cooker, utility area and useful pantry/store. The generous dual aspect sitting room offers a welcoming atmosphere with a log burning stove and access to the rear courtyard. On the first floor, the landing leads to a spacious dual aspect double bedroom with exposed beams, Velux windows with inset blinds and a charming Juliette balcony. A second double bedroom and a bathroom complete the upper floor.

Externally, the property enjoys a gated front garden with a seating terrace and attractive planting, while the rear offers a private enclosed courtyard with a useful store and steps leading up to an additional elevated seating terrace.



- Charming Character Cottage
- Ideal Main Home Or Holiday Cottage
- Pretty Gardens & Store
- Centrally Positioned
- Excellent Village Amenities
- Juliette Balcony
- Traditional Period Features
- No Upward Chain
- EPC: E
- Viewings: Bakewell Office



Fern Lea Manchester Road Tideswell

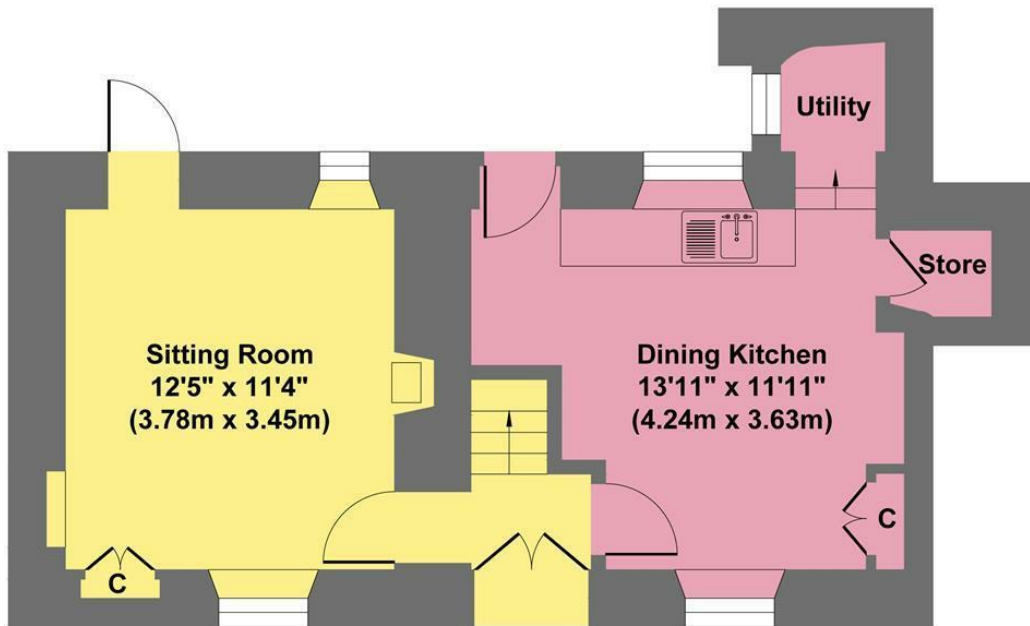

Ground Floor
Approximate Floor Area
384 sq.ft
(35.67 sq.m.)

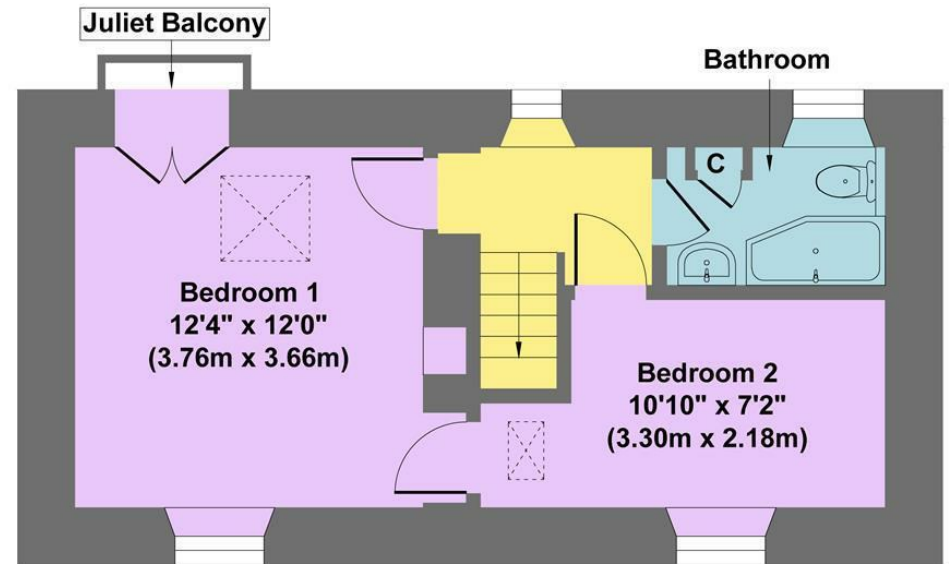

First Floor
Approximate Floor Area
345 sq.ft
(32.09 sq.m.)

Approx. Gross Internal Floor Area 729 sq.ft / 67.76 sq.m

Illustration for identification puposes only ,measurements are approximate, not to scale

While we endeavour to make our sales particulars fair, accurate and reliable, they are only a general guide to the property and, accordingly, if there is any point, which is of particular importance to you, please contact the relevant office. The Agents have not tested any apparatus, equipment, fittings or services and so cannot verify they are in working order. The buyer is advised to obtain verification. Please note all the measurement details are approximate and should not be relied upon as exact. All plans, floor plans and maps are for guidance purposes only and are not to scale. Under no circumstances should they be relied upon as exact or for use in planning carpets and other such fixtures, fittings or furnishings. YOUR HOME IS AT RISK IF YOU DO NOT KEEP UP REPAYMENTS ON A MORTGAGE OR OTHER LOAN SECURED ON IT. 'A Life Assurance policy may be requested.' 'Written Quotations of credit terms available on request.'

Banner Cross
T: 0114 268 3241
E: bannercross@saxtonmee.co.uk
www.saxtonmee.co.uk

Hathersage
T: 01433 650009
E: hathersage@saxtonmee.co.uk

Bakewell
T: 01629 815307
E: bakewell@saxtonmee.co.uk

Matlock
T: 01629 828250
E: matlock@saxtonmee.co.uk

