



2 The Lodge, Tideswell, Derbyshire, SK17 8PH

Saxton Mee



## 2 The Lodge

### Tideswell

**£285,000**

This charming, stone built mid terraced Derbyshire cottage sits in a peaceful, picturesque setting in the popular Peak Park village of Tideswell. Surrounded by stunning countryside with easy access to local walks and cycle trails, the property enjoys a generous rear garden that adjoins open countryside

Currently run as a successful holiday cottage, the contents are available through separate negotiation. Upon entering, you are welcomed by a front porch that opens into a cosy sitting room featuring a log-burning stove. The room seamlessly flows into a bespoke fitted kitchen equipped with a range of integrated appliances. Adjacent to the kitchen, a utility/store provides convenient access to the rear courtyard.

Upstairs, a spacious landing with a glazed door opens to the garden grants access to two well appointed bedrooms and a modern shower room.

Tideswell itself offers a delightful array of shops, amenities, café and country inns. It is also home to the historic church affectionately known as the "Cathedral of The Peak". Additionally, the property benefits from being within a highly regarded school catchment and is within commutable distance of major commercial centres.



- No Upward Chain
- An Ideal Holiday Cottage With Contents Available By Separate Negotiation
- Rear Garden With Timber Storage Shed
- Close To Excellent Village Amenities
- Easy Access To Local Walks & Cycle Trails
- Peaceful Picturesque Setting
- Ideal Main Home
- High Quality Fittings & Log Burning Stove
- EPC Rating D
- Viewings: Bakewell Office









## 2 The Lodge

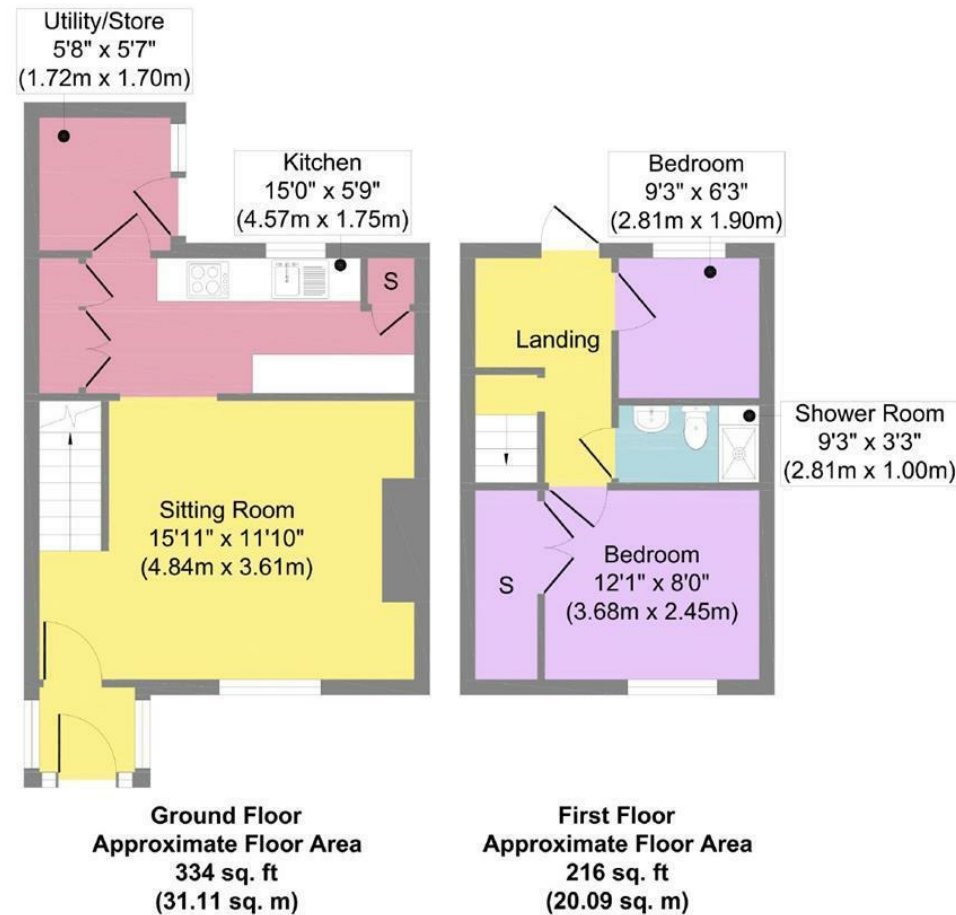

Illustration for identification purposes only, measurements are approximate, not to scale.

While we endeavour to make our sales particulars fair, accurate and reliable, they are only a general guide to the property and, accordingly, if there is any point, which is of particular importance to you, please contact the relevant office. The Agents have not tested any apparatus, equipment, fittings or services and so cannot verify they are in working order. The buyer is advised to obtain verification. Please note all the measurement details are approximate and should not be relied upon as exact. All plans, floor plans and maps are for guidance purposes only and are not to scale. Under no circumstances should they be relied upon as exact or for use in planning carpets and other such fixtures, fittings or furnishings. YOUR HOME IS AT RISK IF YOU DO NOT KEEP UP REPAYMENTS ON A MORTGAGE OR OTHER LOAN SECURED ON IT. 'A Life Assurance policy may be requested.' 'Written Quotations of credit terms available on request.'

Banner Cross  
T: 0114 268 3241  
E: [bannercross@saxtonmee.co.uk](mailto:bannercross@saxtonmee.co.uk)  
[www.saxtonmee.co.uk](http://www.saxtonmee.co.uk)

Hathersage  
T: 01433 650009  
E: [hathersage@saxtonmee.co.uk](mailto:hathersage@saxtonmee.co.uk)

Bakewell  
T: 01629 815307  
E: [bakewell@saxtonmee.co.uk](mailto:bakewell@saxtonmee.co.uk)

Matlock  
T: 01629 828250  
E: [matlock@saxtonmee.co.uk](mailto:matlock@saxtonmee.co.uk)

