



Dale Cottage Bankside, Youlgrave, Derbyshire, DE45 1WD

Saxton Mee

Dale Cottage Bankside

Youlgrave

Guide Price

£250,000

Set in a peaceful and picturesque position with breathtaking views across Bradford Dale, this charming two-bedroom stone-built cottage offers a perfect blend of character, comfort and location.

£250,000 - £265,000 Guide Price

Nestled in a sought-after Peak District village, the property enjoys an enviable setting with local shops, a café and traditional country inns all within easy reach. Currently operating as a holiday rental cottage, it would equally suit those looking for a permanent home in the heart of the countryside, with a wealth of outdoor pursuits quite literally on the doorstep.

Recently upgraded, the beautifully presented accommodation includes a spacious sitting and dining room where exposed stonework and a log burning stove create a warm and inviting atmosphere. A fitted kitchen completes the ground floor, offering both functionality and rustic charm.

Upstairs, the first floor landing leads to a double bedroom, a further bedroom and a bathroom, all of which enjoy glimpses of the stunning landscape beyond. Outside, a generous stone outbuilding offers useful storage or potential for a variety of uses, while the easily managed rear garden provides a perfect spot to sit back and take in the ever-changing views across the dale.

Offered with no upward chain, this is a rare opportunity to own a characterful cottage in one of the Peak District's most picturesque locations. The property is accessed by a cobbled pathway, set away from the main road.



- Idyllic Setting Overlooking The Dale
- Sought After Peak District Village
- Excellent Local Amenities
- Traditional Features
- Direct Access To A Wealth Of Outdoor Pursuits
- Substantial Stone Outbuilding
- Log Burning Stove
- No Upward Chain
- EPC: F
- Viewings: Bakewell Office



Dale Cottage

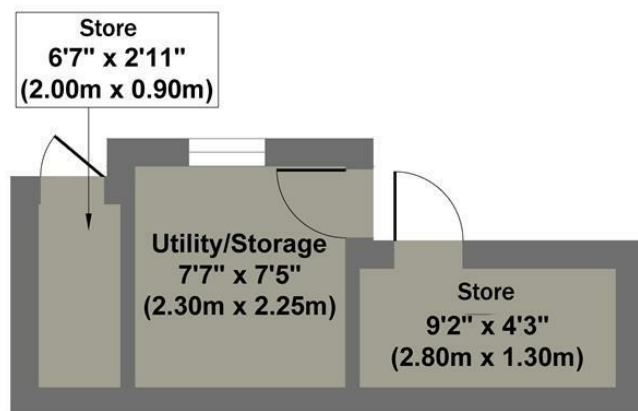

Outbuilding
Approximate Floor Area
123 sq.ft
(11.48 sq.m.)

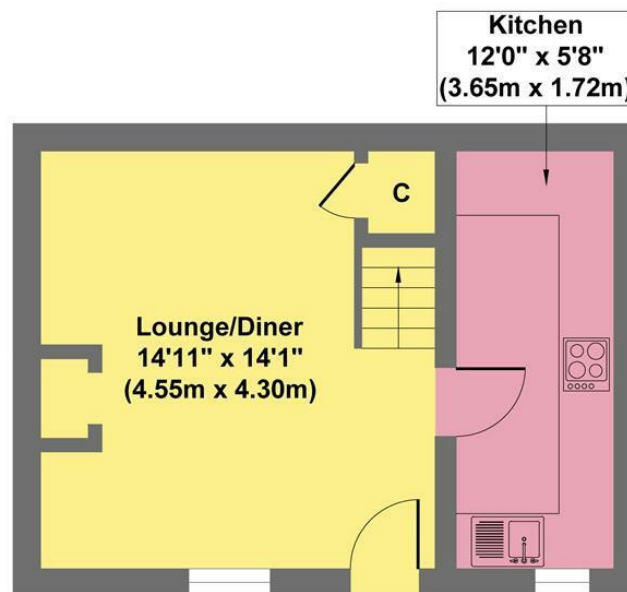

Ground Floor
Approximate Floor Area
306 sq.ft
(28.43 sq.m.)

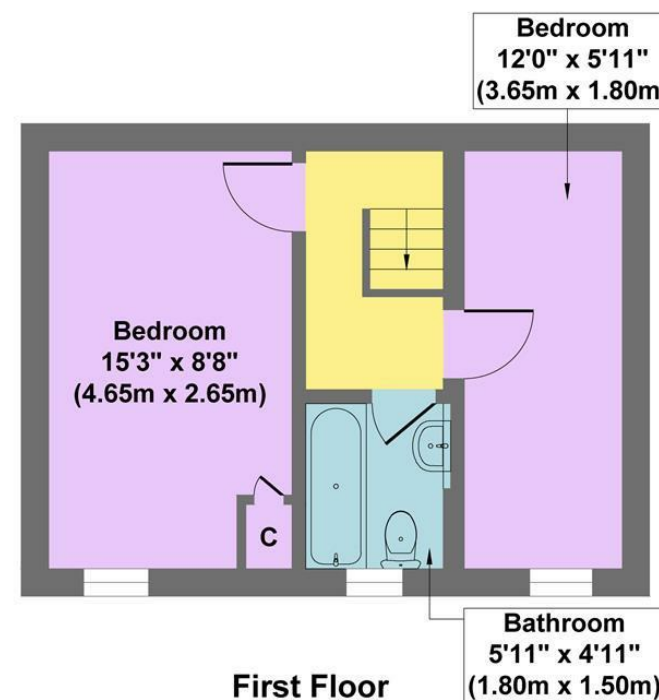

First Floor
Approximate Floor Area
306 sq.ft
(28.43 sq.m.)

Approx. Gross Internal Floor Area 735 sq.ft / 68.34 sq.m

Illustration for identification puposes only ,measurements are approximate, not to scale

While we endeavour to make our sales particulars fair, accurate and reliable, they are only a general guide to the property and, accordingly, if there is any point, which is of particular importance to you, please contact the relevant office. The Agents have not tested any apparatus, equipment, fittings or services and so cannot verify they are in working order. The buyer is advised to obtain verification. Please note all the measurement details are approximate and should not be relied upon as exact. All plans, floor plans and maps are for guidance purposes only and are not to scale. Under no circumstances should they be relied upon as exact or for use in planning carpets and other such fixtures, fittings or furnishings. YOUR HOME IS AT RISK IF YOU DO NOT KEEP UP REPAYMENTS ON A MORTGAGE OR OTHER LOAN SECURED ON IT. 'A Life Assurance policy may be requested.' 'Written Quotations of credit terms available on request.'

Banner Cross
T: 0114 268 3241
E: bannercross@saxtonmee.co.uk
www.saxtonmee.co.uk

Hathersage
T: 01433 650009
E: hathersage@saxtonmee.co.uk

Bakewell
T: 01629 815307
E: bakewell@saxtonmee.co.uk

Matlock
T: 01629 828250
E: matlock@saxtonmee.co.uk

