



24 Monks Dale Close, Tideswell, Derbyshire, SK17 8JG

Saxton Mee

24 Monks Dale Close

Tideswell

Guide Price

£325,000

Situated in a peaceful residential setting within the highly sought-after village of Tideswell, this three-bedroom semi detached home enjoys a wonderful blend of village charm and modern convenience. With a thriving community spirit, Tideswell offers a wealth of local amenities, including a variety of shops, café, traditional country inns and a well-regarded primary school. The property also falls within the catchment area for Lady Manners School, making it an ideal choice for families.

£325,000 - £350,000 Guide Price

Adjoining open countryside, the home boasts lovely views and easily managed gardens, providing a perfect balance of indoor and outdoor living.

The accommodation with gas central heating and double glazing features an entrance lobby leading into a comfortable sitting room, a separate dining room and a well-equipped fitted kitchen.

On the first floor, a landing gives access to two generously sized double bedrooms, a further bedroom and a family bathroom.

Additional benefits include an attached garage and off-road parking, ensuring practicality alongside its picturesque setting.

With no upward chain, this delightful home presents a fantastic opportunity to embrace village life in one of the Peak District's most desirable locations.



- Easily Managed Gardens
- Spacious Family Living Accommodation
- Countryside Views
- Local Primary School
- Excellent Village Amenities
- Peaceful Residential Setting
- Garage & Off Road Parking
- No Upward Chain
- EPC: TBC
- Viewings: Bakewell Office



24 Monksdale Close

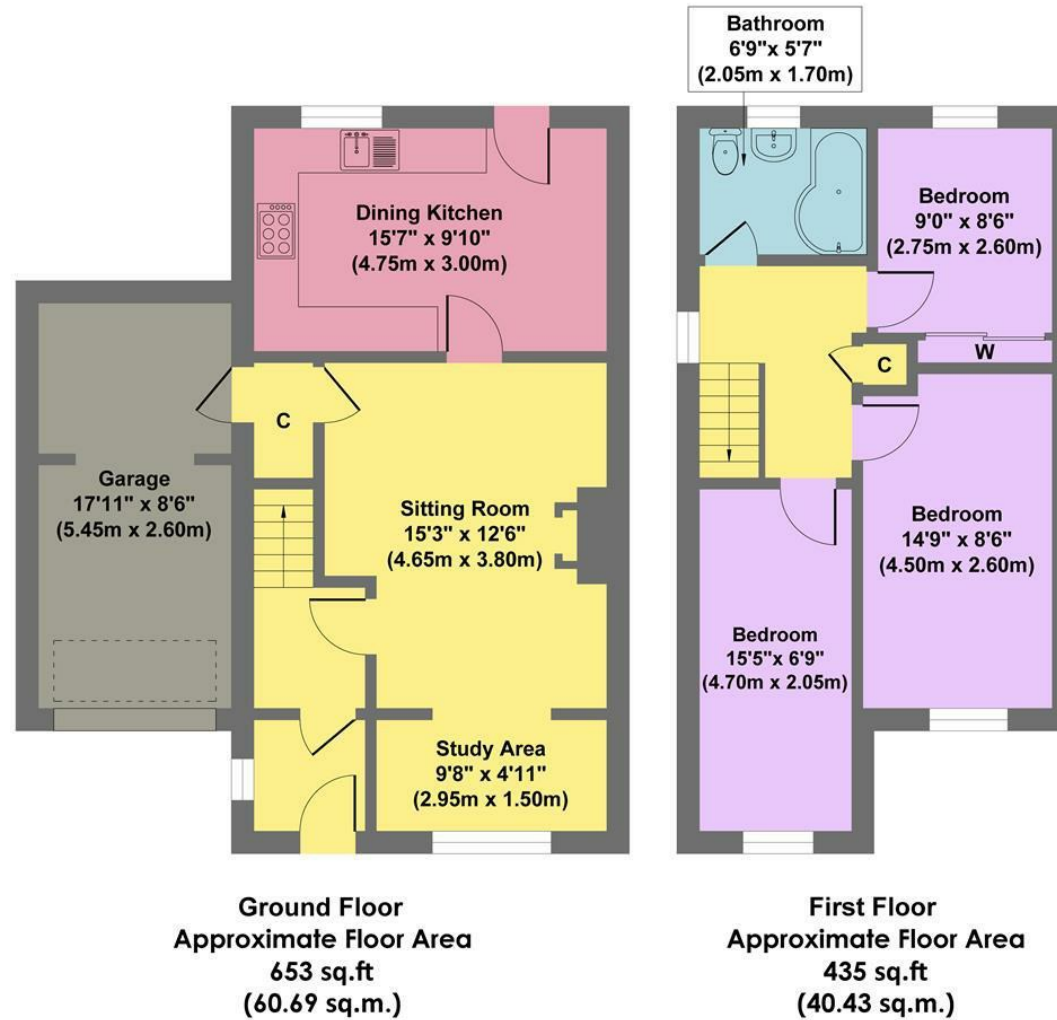

Approx. Gross Internal Floor Area 1088 sq.ft / 101.12 sq.m

Illustration for identification puposes only ,measurements are approximate, not to scale

While we endeavour to make our sales particulars fair, accurate and reliable, they are only a general guide to the property and, accordingly, if there is any point, which is of particular importance to you, please contact the relevant office. The Agents have not tested any apparatus, equipment, fittings or services and so cannot verify they are in working order. The buyer is advised to obtain verification. Please note all the measurement details are approximate and should not be relied upon as exact. All plans, floor plans and maps are for guidance purposes only and are not to scale. Under no circumstances should they be relied upon as exact or for use in planning carpets and other such fixtures, fittings or furnishings. YOUR HOME IS AT RISK IF YOU DO NOT KEEP UP REPAYMENTS ON A MORTGAGE OR OTHER LOAN SECURED ON IT. 'A Life Assurance policy may be requested.' 'Written Quotations of credit terms available on request.'

Banner Cross
T: 0114 268 3241
E: bannercross@saxtonmee.co.uk
www.saxtonmee.co.uk

Hathersage
T: 01433 650009
E: hathersage@saxtonmee.co.uk

Bakewell
T: 01629 815307
E: bakewell@saxtonmee.co.uk

Matlock
T: 01629 828250
E: matlock@saxtonmee.co.uk

