



Bank Cottage, East Bank, Winster, Derbyshire, DE4 2DT

Saxton Mee

East Bank

Winster

Guide Price

£225,000

Nestled in the heart of the historic village of Winster, this two bedroom stone built cottage presents an exciting opportunity for renovation and reconfiguration. Surrounded by the breathtaking Derbyshire countryside, the property enjoys a peaceful setting, yet remains within easy reach of the village's characterful streets, vibrant community and essential amenities.

£225,000 - £250,000 Guide Price

Inside, the cottage features a dual-aspect sitting room, with the added benefit of an adjoining pantry or store, offering potential for expansion or adaptation. The dining kitchen provides a functional space with scope for improvement to suit modern tastes and lifestyles.

Upstairs, the first floor comprises a spacious double bedroom with its own shower enclosure and an adjoining dressing room, alongside a second bedroom.

While the WC is currently accessed externally, this could offer an opportunity for reconfiguration to create a more contemporary layout.

To the rear, the tiered garden provides a tranquil outdoor space, complete with an ornamental pond, a greenhouse and a timber store, all set against the stunning rural backdrop.

With no upward chain, this property invites those with vision to restore and enhance its historic charm, making the most of its enviable location in one of Derbyshire's most picturesque villages.



- Peaceful Setting
- Charming Derbyshire Village
- Attractive Rear Garden
- Far Reaching Views
- Offers Scope To Complete To Individual Specifications
- Tiered Rear Garden
- No Upward Chain
- EPC: TBC
- Viewings: Bakewell Office





Bank Cottage

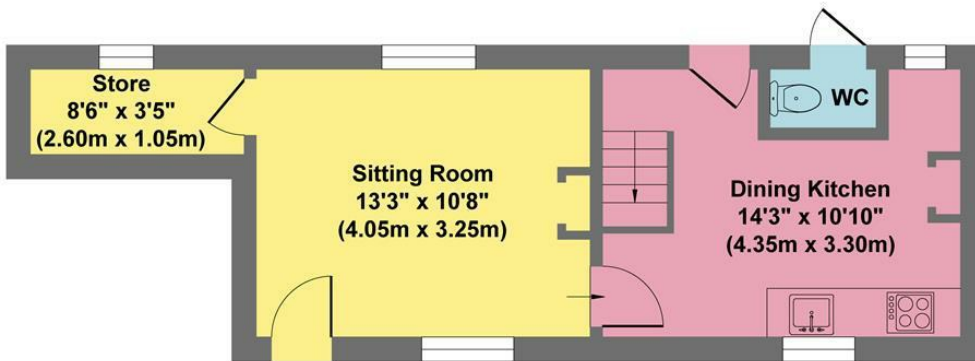

Ground Floor
Approximate Floor Area
330 sq.ft
(30.67 sq.m.)

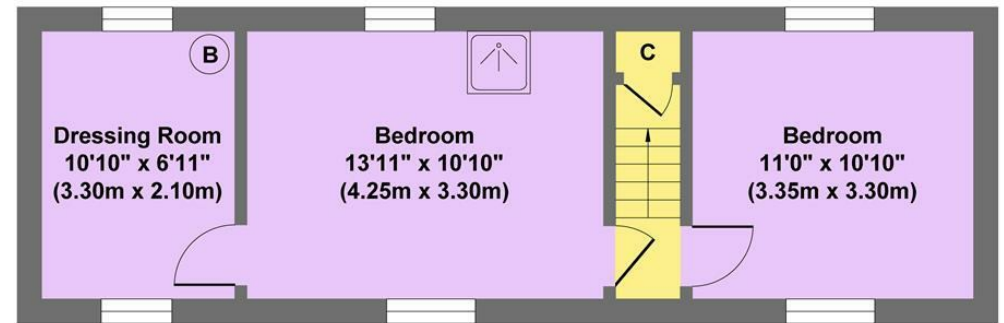

First Floor
Approximate Floor Area
395 sq.ft
(36.72 sq.m.)

Approx. Gross Internal Floor Area 725 sq.ft / 67.39 sq.m

Illustration for identification purposes only, measurements are approximate, not to scale

While we endeavour to make our sales particulars fair, accurate and reliable, they are only a general guide to the property and, accordingly, if there is any point, which is of particular importance to you, please contact the relevant office. The Agents have not tested any apparatus, equipment, fittings or services and so cannot verify they are in working order. The buyer is advised to obtain verification. Please note all the measurement details are approximate and should not be relied upon as exact. All plans, floor plans and maps are for guidance purposes only and are not to scale. Under no circumstances should they be relied upon as exact or for use in planning carpets and other such fixtures, fittings or furnishings. YOUR HOME IS AT RISK IF YOU DO NOT KEEP UP REPAYMENTS ON A MORTGAGE OR OTHER LOAN SECURED ON IT. 'A Life Assurance policy may be requested.' 'Written Quotations of credit terms available on request.'

Banner Cross
T: 0114 268 3241
E: bannercross@saxtonmee.co.uk
www.saxtonmee.co.uk

Hathersage
T: 01433 650009
E: hathersage@saxtonmee.co.uk

Bakewell
T: 01629 815307
E: bakewell@saxtonmee.co.uk

Matlock
T: 01629 828250
E: matlock@saxtonmee.co.uk

