



10 West End, Baslow, Derbyshire, DE45 1RG

Saxton Mee

10 West End Baslow

£275,000

Set in the heart of a picturesque Derbyshire village, this well presented three-bedroom semi-detached property enjoys a peaceful location with breathtaking views over the surrounding valley, including Baslow and Curbar Edges.

Nestled in the highly sought-after village of Baslow, the property is within catchment for the acclaimed Baslow St Anne's Primary School and Lady Manners School, making it an ideal home for families.

Baslow is a quintessential Peak District village, offering a variety of local amenities including shops, a Post Office, restaurants and charming country inns. The property's location allows for easy access to Chatsworth Park, as well as a range of local walks and cycle trails, catering to those who enjoy outdoor pursuits.

The home is equipped with gas central heating and double glazing. The accommodation includes a front entrance lobby that leads to a spacious dual-aspect sitting room, where a Clearview log-burning stove creates a cozy focal point. The shaker-style breakfast kitchen is well-appointed with integrated appliances, while the utility room and a garden/dining room provide additional practical and versatile spaces.

On the first floor, the property features a main double bedroom with built-in mirrored wardrobes, a second double bedroom offering spectacular views, a shower room and a third bedroom.

Externally, the front garden is attractively laid to lawn with planted beds, enhancing the property's appeal. The rear garden is designed for ease of maintenance, with raised beds, a timber storage shed and a wood store. The property offers on-street parking only. The property is on a bus route.

A three-year residency or employment clause within Derbyshire applies, adding to its exclusivity for local buyers

what3words

catching.position.unloaded



- Peaceful & Picturesque Setting
- Fabulous Far Reaching Views
- Clearview Multi-fuel Stove
- Excellent Village Amenities
- Easy Access To Many Local Walks
- On Street Parking Only
- No Upward Chain
- A Local Three Year 'Lived Or Worked In Derbyshire' Clause Applies.
- EPC: D
- Viewings: Bakewell Office





10 West End

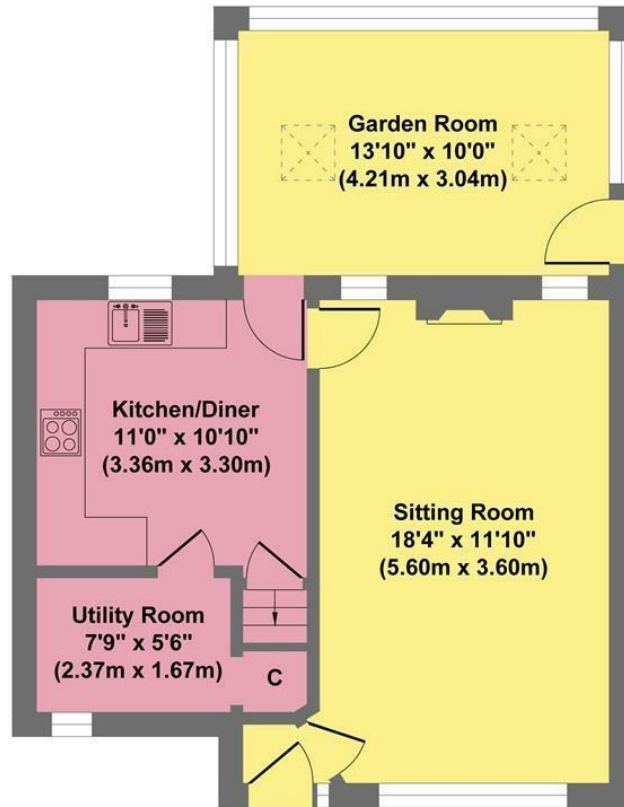

Ground Floor
Approximate Floor Area
601 sq.ft
(55.80 sq.m.)

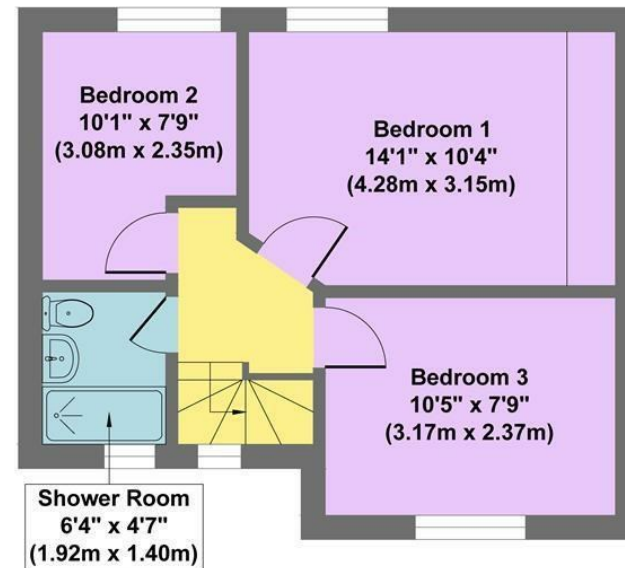

First Floor
Approximate Floor Area
426 sq.ft
(39.57 sq.m.)

Approx. Gross Internal Floor Area 1027 sq.ft / 95.37 sq.m

Illustration for identification puposes only ,measurements are approximate, not to scale

While we endeavour to make our sales particulars fair, accurate and reliable, they are only a general guide to the property and, accordingly, if there is any point, which is of particular importance to you, please contact the relevant office. The Agents have not tested any apparatus, equipment, fittings or services and so cannot verify they are in working order. The buyer is advised to obtain verification. Please note all the measurement details are approximate and should not be relied upon as exact. All plans, floor plans and maps are for guidance purposes only and are not to scale. Under no circumstances should they be relied upon as exact or for use in planning carpets and other such fixtures, fittings or furnishings. YOUR HOME IS AT RISK IF YOU DO NOT KEEP UP REPAYMENTS ON A MORTGAGE OR OTHER LOAN SECURED ON IT. 'A Life Assurance policy may be requested.' 'Written Quotations of credit terms available on request.'

Banner Cross
T: 0114 268 3241
E: bannercross@saxtonmee.co.uk
www.saxtonmee.co.uk

Hathersage
T: 01433 650009
E: hathersage@saxtonmee.co.uk

Bakewell
T: 01629 815307
E: bakewell@saxtonmee.co.uk

Matlock
T: 01629 828250
E: matlock@saxtonmee.co.uk

