



Flat 11 Royal Oak Place Matlock Street, Bakewell, Derbyshire, DE45 1HD

Saxton Mee



# Flat 11 Royal Oak

## £155,000

This charming one-bedroom apartment is situated on the first floor of a well-maintained building, offering the convenience of both lift and stair access along with a security intercom system for added peace of mind.

Centrally positioned in the heart of Bakewell, it is perfectly located close to an excellent range of shops, amenities and leisure facilities, making it an ideal choice for those seeking to downsize whilst maintaining a vibrant yet comfortable lifestyle.

The apartment enjoys lovely views over the town and features a communal entrance hallway leading to a private entrance hall, which includes built-in storage cupboards for practical living. The accommodation comprises a spacious open-plan living and dining room, creating a welcoming and versatile space for relaxation and entertaining. A fitted kitchen complements the layout. The property also boasts a generously sized double bedroom and a bathroom.

With the additional benefit of no upward chain, this property offers a superb opportunity for a hassle-free move into a desirable location.

- Excellent Town Centre Amenities & Leisure Facilities
- Access To Many Local Walks
- Well Presented
- Centrally Positioned
- Views Across Town
- First Floor Apartment
- Lift & Stairs Access
- Security Intercom
- EPC: C
- Viewings: Bakewell Office







## 11 Royal Oak Place

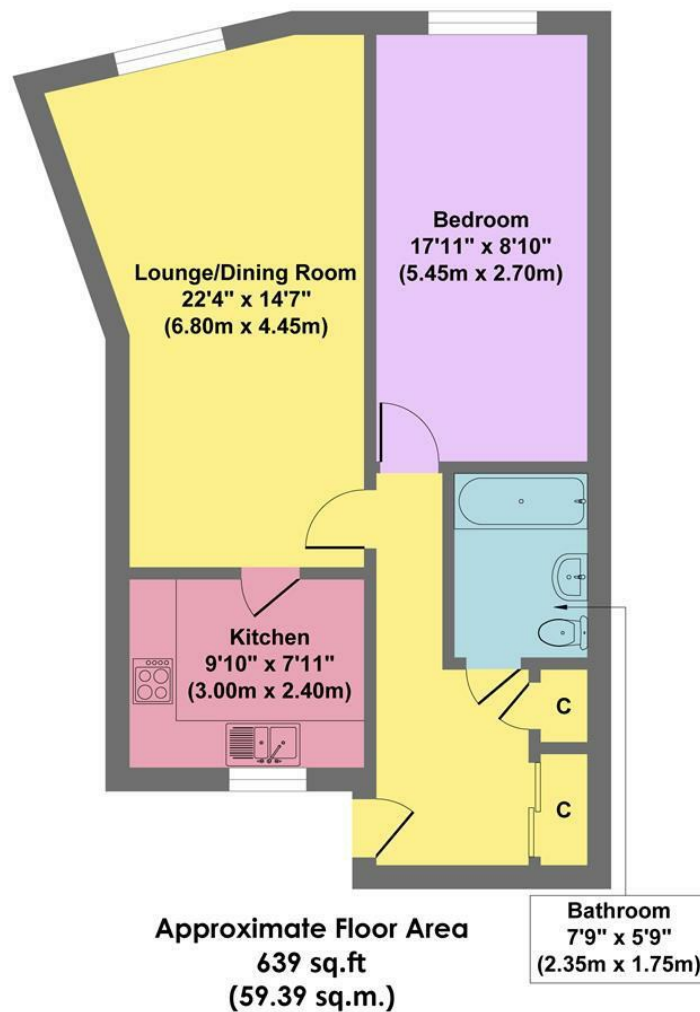

**Approx. Gross Internal Floor Area 639 sq.ft / 59.39 sq.m**

Illustration for identification puposes only ,measurements are approximate, not to scale

While we endeavour to make our sales particulars fair, accurate and reliable, they are only a general guide to the property and, accordingly, if there is any point, which is of particular importance to you, please contact the relevant office. The Agents have not tested any apparatus, equipment, fittings or services and so cannot verify they are in working order. The buyer is advised to obtain verification. Please note all the measurement details are approximate and should not be relied upon as exact. All plans, floor plans and maps are for guidance purposes only and are not to scale. Under no circumstances should they be relied upon as exact or for use in planning carpets and other such fixtures, fittings or furnishings. YOUR HOME IS AT RISK IF YOU DO NOT KEEP UP REPAYMENTS ON A MORTGAGE OR OTHER LOAN SECURED ON IT. 'A Life Assurance policy may be requested.' 'Written Quotations of credit terms available on request.'

Banner Cross  
T: 0114 268 3241  
E: [bannercross@saxtonmee.co.uk](mailto:bannercross@saxtonmee.co.uk)  
[www.saxtonmee.co.uk](http://www.saxtonmee.co.uk)

Hathersage  
T: 01433 650009  
E: [hathersage@saxtonmee.co.uk](mailto:hathersage@saxtonmee.co.uk)

Bakewell  
T: 01629 815307  
E: [bakewell@saxtonmee.co.uk](mailto:bakewell@saxtonmee.co.uk)

Matlock  
T: 01629 828250  
E: [matlock@saxtonmee.co.uk](mailto:matlock@saxtonmee.co.uk)

