



Marli Cottage, Buxton Road, Tideswell, Derbyshire, SK17 8PQ



# Buxton Road

## Tideswell

Guide Price

# £250,000

This beautifully presented two-bedroom semi-detached cottage is nestled in the heart of the picturesque village of Tideswell in the Peak District. Combining traditional charm with modern comforts, the property offers a high standard of living, enhanced by its idyllic location.

£250,000 - £265,000 Guide Price.

Just a short walk from local amenities, including independent shops, cafes and country inns, the cottage provides an inviting village lifestyle, while the surrounding Derbyshire countryside offers abundant opportunities for outdoor pursuits. Tideswell also hosts a historic primary school and the famous church known locally as the 'Cathedral of the Peak,' adding to its rich cultural heritage.

Renovated by the present owner the cottage itself is brimming with character, with a front door leading into a dual-aspect sitting room featuring a stone wall and a cosy wood-burning stove set in a stone fireplace. This spacious room accommodates both seating and dining areas, while a latched door opens to a well-appointed kitchen. The kitchen includes a range of units, roll-edge worktops, a Belfast sink overlooking the garden and space for appliances. A stable door opens directly out to the cottage's garden and outbuilding.

Upstairs, the main bedroom is generously sized with solid wood flooring and a front-facing view, while the second bedroom enjoys a rear-facing aspect. The bathroom is well-equipped with an overhead shower, low-flush WC, pedestal wash basin and built-in storage.

The cottages outside space is equally charming, with a large stone outbuilding offering potential for storage or further development and a summer house to enjoy the views. The tiered garden includes well stocked beds, borders and seating terraces.

The property also benefits from a rented local authority parking space conveniently located next to the house.



- Brimming With Character Features
- Level Walking Distance To The Excellent Village Amenities
- Beautifully Presented Throughout
- Useful Stone Store To The Rear
- Cosy Sitting Room With A Log Burning Stove
- Attractive Rear Garden with Charming Views
- Direct Access to Many Local Walks
- Ideal Main Home Or Holiday Cottage
- EPC: D
- Viewings: Bakewell Office





## Marli Cottage

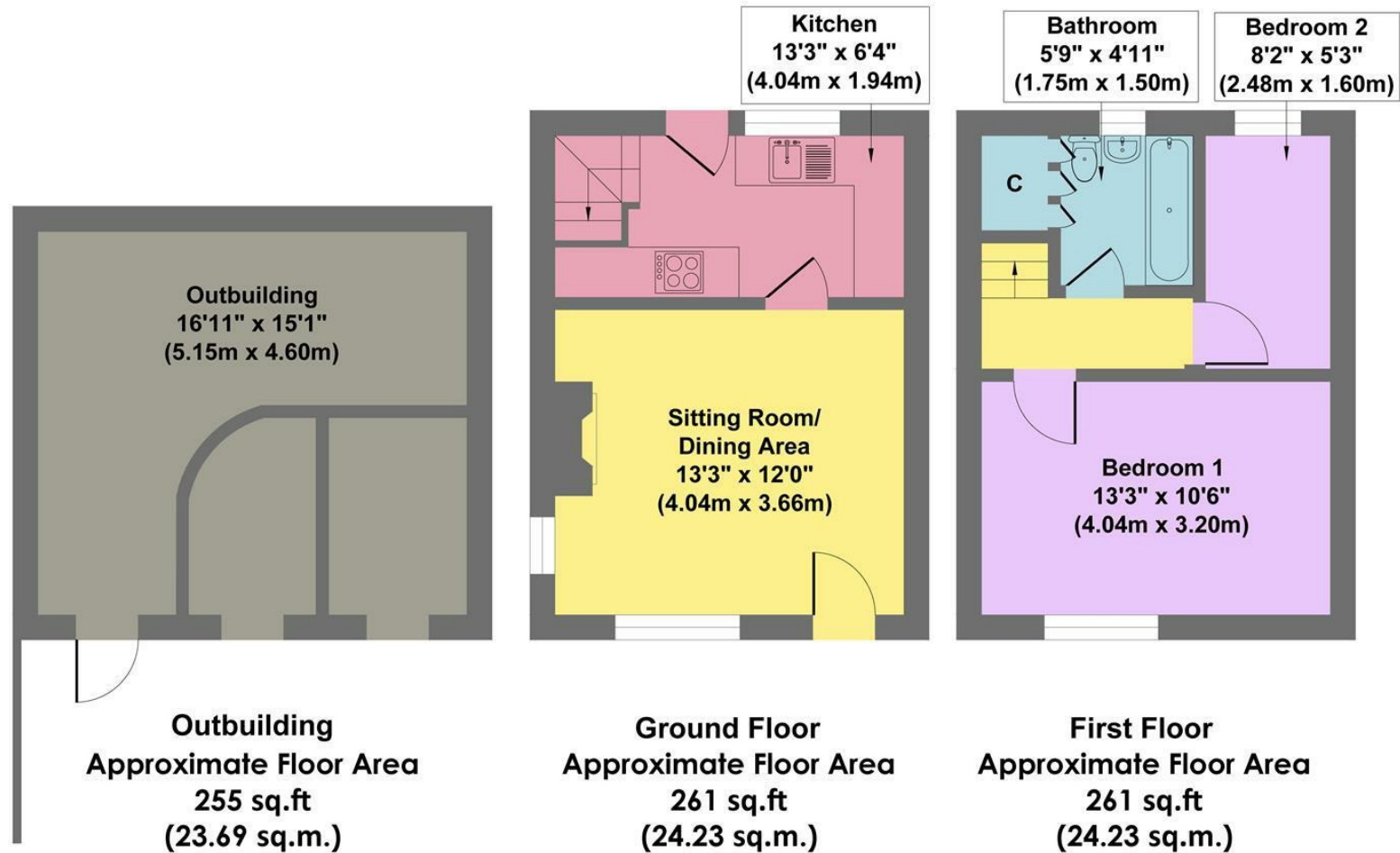

**Approx. Gross Internal Floor Area 777 sq.ft / 72.15 sq.m**

Illustration for identification purposes only, measurements are approximate, not to scale

While we endeavour to make our sales particulars fair, accurate and reliable, they are only a general guide to the property and, accordingly, if there is any point, which is of particular importance to you, please contact the relevant office. The Agents have not tested any apparatus, equipment, fittings or services and so cannot verify they are in working order. The buyer is advised to obtain verification. Please note all the measurement details are approximate and should not be relied upon as exact. All plans, floor plans and maps are for guidance purposes only and are not to scale. Under no circumstances should they be relied upon as exact or for use in planning carpets and other such fixtures, fittings or furnishings. YOUR HOME IS AT RISK IF YOU DO NOT KEEP UP REPAYMENTS ON A MORTGAGE OR OTHER LOAN SECURED ON IT. 'A Life Assurance policy may be requested.' 'Written Quotations of credit terms available on request.'

Banner Cross  
T: 0114 268 3241  
E: [bannercross@saxtonmee.co.uk](mailto:bannercross@saxtonmee.co.uk)  
[www.saxtonmee.co.uk](http://www.saxtonmee.co.uk)

Hathersage  
T: 01433 650009  
E: [hathersage@saxtonmee.co.uk](mailto:hathersage@saxtonmee.co.uk)

Bakewell  
T: 01629 815307  
E: [bakewell@saxtonmee.co.uk](mailto:bakewell@saxtonmee.co.uk)

Matlock  
T: 01629 828250  
E: [matlock@saxtonmee.co.uk](mailto:matlock@saxtonmee.co.uk)

