



22 The Meadows Grisedale Road, Great Longstone, Derbyshire, DE45 1TP

Saxton Mee

22 The Meadows Grisedale

Great Longstone

Offers In The Region Of

£295,000

This well-presented two-bedroom end terrace bungalow is situated in a peaceful residential area within the highly desirable village of Great Longstone, nestled in the heart of the Peak District. The property offers the perfect blend of rural tranquility and modern convenience, with local shops and amenities just a short walk away.

Surrounded by the breathtaking Derbyshire countryside, residents can enjoy direct access to scenic walks, while additional shops, amenities, and leisure facilities are easily accessible in nearby Bakewell. The bungalow also benefits from being within a commutable distance to major commercial centres, making it an ideal home for those seeking a balance between country living and urban accessibility. Inside, the accommodation is well-maintained, featuring gas central heating and double glazing, the entrance lobby leads into a functional fitted kitchen with an adjacent dining area, creating a welcoming space for meals and gatherings. The cozy sitting room offers a comfortable area to relax, two double bedrooms and a shower room completes the interior layout.

Outside, the property includes a driveway that offers off-road parking. The surrounding private gardens, designed for easy maintenance, provide a lovely outdoor space to enjoy the peaceful setting and include a timber summer house.

The property is offered with no upward chain, making it an attractive option for those looking to move into this charming village with minimal hassle.



- Charming Peak District Village
- Good Local Amenities
- Easily Managed Gardens And Summer House
- Gas Central Heating & Double Glazing
- Well Presented Throughout
- Peaceful Residential Setting
- Off Road Parking
- No Upward Chain
- EPC: TBC
- Viewings: Bakewell Office





22 The Meadows

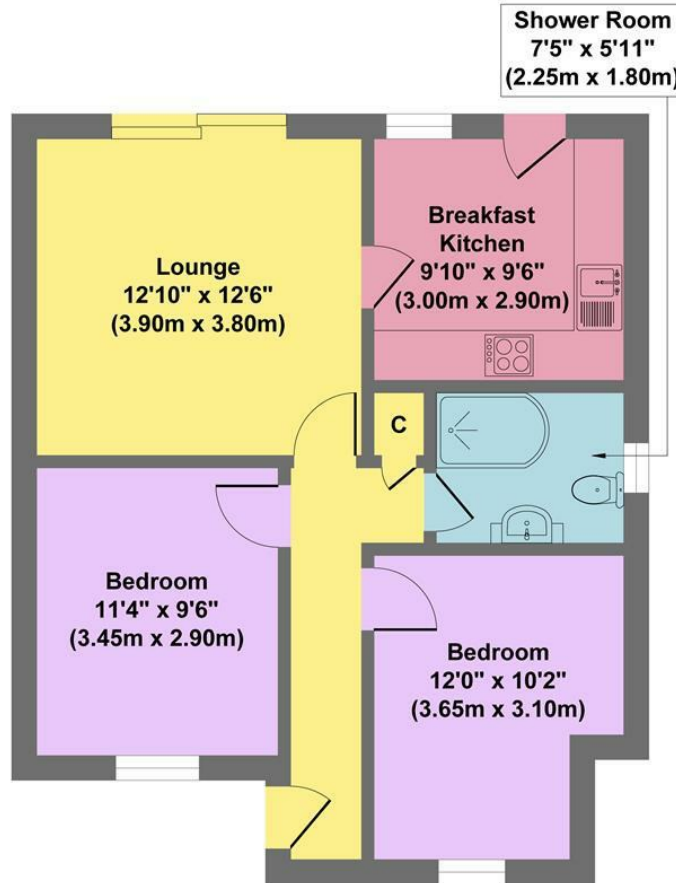

Approximate Floor Area
605 sq.ft
(56.19 sq.m.)

Approx. Gross Internal Floor Area 605 sq.ft / 56.19 sq.m

Illustration for identification puposes only ,measurements are approximate, not to scale

While we endeavour to make our sales particulars fair, accurate and reliable, they are only a general guide to the property and, accordingly, if there is any point, which is of particular importance to you, please contact the relevant office. The Agents have not tested any apparatus, equipment, fittings or services and so cannot verify they are in working order. The buyer is advised to obtain verification. Please note all the measurement details are approximate and should not be relied upon as exact. All plans, floor plans and maps are for guidance purposes only and are not to scale. Under no circumstances should they be relied upon as exact or for use in planning carpets and other such fixtures, fittings or furnishings. YOUR HOME IS AT RISK IF YOU DO NOT KEEP UP REPAYMENTS ON A MORTGAGE OR OTHER LOAN SECURED ON IT. 'A Life Assurance policy may be requested.' 'Written Quotations of credit terms available on request.'

Banner Cross
T: 0114 268 3241
E: bannercross@saxtonmee.co.uk
www.saxtonmee.co.uk

Hathersage
T: 01433 650009
E: hathersage@saxtonmee.co.uk

Bakewell
T: 01629 815307
E: bakewell@saxtonmee.co.uk

Matlock
T: 01629 828250
E: matlock@saxtonmee.co.uk

