



Braeside Conksbury Avenue, Youlgrave, Derbyshire, DE45 1WQ



Braeside Conksbury Avenue

Guide Price

£375,000

Fabulous Setting With Countryside Views

£375,000 - £385,000 Guide Price

Situated in an idyllic setting with superb countryside views, this two-bedroom detached bungalow offers a peaceful and picturesque lifestyle in the popular Peak District village of Youlgrave. A short walk from excellent local amenities, including shops, cafes, a primary school, and country inns, the property is ideally located for easy access to the market town of Bakewell, Chatsworth Country House, and the surrounding Derbyshire countryside. The village of Youlgrave is renowned for its stunning walks along the river at Bradford Dale and beyond, making it a haven for outdoor enthusiasts.

Internally, the property features spacious accommodation throughout, including an entrance porch leading to an inner lobby, a dining kitchen, a sitting room, a conservatory, two bedrooms, and a shower room.

The front of the property boasts a paved terrace and a driveway that provides generous off-road parking and vehicle access to the detached garage.

The rear of the property includes an easily managed garden with a useful workshop/store, enhancing the bungalow's appeal for those seeking both charm and practicality in a serene rural setting.

No Upward Chain

- Countryside Views
- Access To Many Local Walks
- A Thriving Village Community With A Calendar Of Events
- Easily Managed Gardens & Workshop/Store
- Offers Scope For Cosmetic Enhancement
- Excellent Local Amenities
- Garage & Off Road Parking
- No Upward Chain
- EPC: TBC
- Viewings: Bakewell Office





Braeside

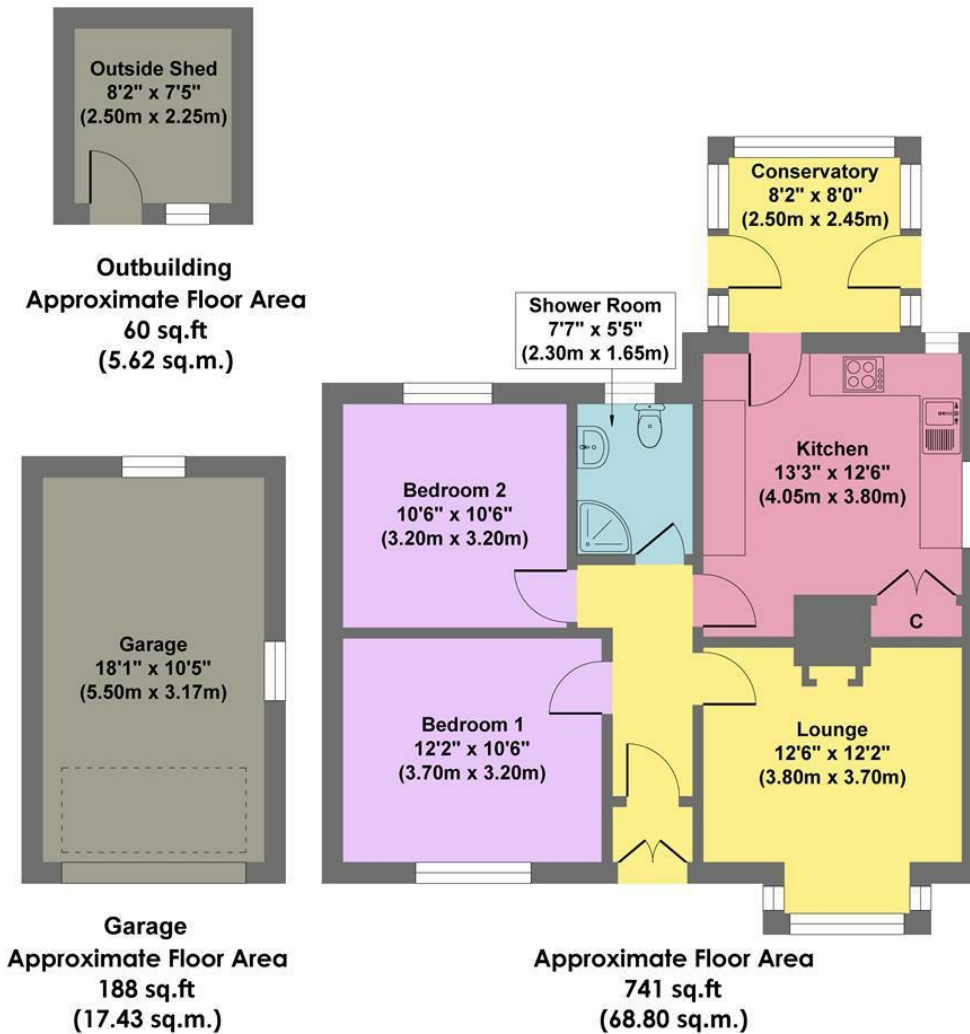

Approx. Gross Internal Floor Area 989 sq.ft / 91.85 sq.m

Illustration for identification purposes only, measurements are approximate, not to scale

While we endeavour to make our sales particulars fair, accurate and reliable, they are only a general guide to the property and, accordingly, if there is any point, which is of particular importance to you, please contact the relevant office. The Agents have not tested any apparatus, equipment, fittings or services and so cannot verify they are in working order. The buyer is advised to obtain verification. Please note all the measurement details are approximate and should not be relied upon as exact. All plans, floor plans and maps are for guidance purposes only and are not to scale. Under no circumstances should they be relied upon as exact or for use in planning carpets and other such fixtures, fittings or furnishings. YOUR HOME IS AT RISK IF YOU DO NOT KEEP UP REPAYMENTS ON A MORTGAGE OR OTHER LOAN SECURED ON IT. 'A Life Assurance policy may be requested.' 'Written Quotations of credit terms available on request.'

Banner Cross
T: 0114 268 3241
E: bannercross@saxtonmee.co.uk
www.saxtonmee.co.uk

Hathersage
T: 01433 650009
E: hathersage@saxtonmee.co.uk

Bakewell
T: 01629 815307
E: bakewell@saxtonmee.co.uk

Matlock
T: 01629 828250
E: matlock@saxtonmee.co.uk

