



6 Sherwood Road, Tideswell, Derbyshire, SK17 8HT



Saxton Mee

6 Sherwood Road

Tideswell

Asking Price

£150,000

This truly delightful and well-presented ground floor two-bedroomed apartment is perfect for a first-time buyer, professional couple, or retiree, forming part of a sympathetic conversion of a former 18th-century silk mill.

Located in the highly sought-after Peak District village of Tideswell, the apartment is close to local amenities and boasts excellent transportation links to Manchester, Sheffield, Buxton, and Bakewell.

Stylishly designed, the accommodation features electric heating and includes a lounge/dining room with an ornamental recess in the chimney breast, a well-equipped kitchen with integrated appliances, a second bedroom that can also serve as a home office, a rear/inner hall, a master bedroom with excellent fitted wardrobes, and a shower room.

The property also includes a small sitting area to the rear, perfect for enjoying the peaceful surroundings.

Please note that a 10-year local occupancy clause applies to this property.

No Upward Chain.



- Sought After Peak District Village
- Easy Reach Of Major Commercial Centres Well Presented
- Well Presented
- Small Rear Courtyard
- Within A Former Silk Mill
- Excellent Village Amenities
- A 10 Year Local Occupancy Clause Applies
- No Upward Chain
- EPC: D
- Viewings: Bakewell Office





6 Sherwood Road

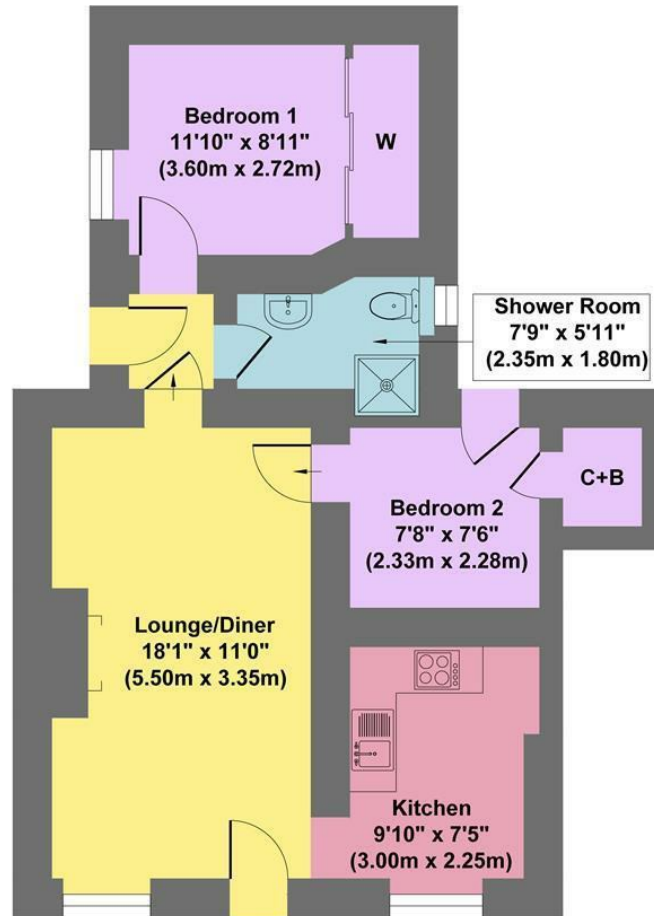

Approximate Floor Area
Area 609 sq.ft
(56.61 sq.m.)

Approx. Gross Internal Floor Area 609 sq.ft / 56.61 sq.m

Illustration for identification purposes only, measurements are approximate, not to scale

While we endeavour to make our sales particulars fair, accurate and reliable, they are only a general guide to the property and, accordingly, if there is any point, which is of particular importance to you, please contact the relevant office. The Agents have not tested any apparatus, equipment, fittings or services and so cannot verify they are in working order. The buyer is advised to obtain verification. Please note all the measurement details are approximate and should not be relied upon as exact. All plans, floor plans and maps are for guidance purposes only and are not to scale. Under no circumstances should they be relied upon as exact or for use in planning carpets and other such fixtures, fittings or furnishings. YOUR HOME IS AT RISK IF YOU DO NOT KEEP UP REPAYMENTS ON A MORTGAGE OR OTHER LOAN SECURED ON IT. 'A Life Assurance policy may be requested.' 'Written Quotations of credit terms available on request.'

Banner Cross
T: 0114 268 3241
E: bannercross@saxtonmee.co.uk
www.saxtonmee.co.uk

Hathersage
T: 01433 650009
E: hathersage@saxtonmee.co.uk

Bakewell
T: 01629 815307
E: bakewell@saxtonmee.co.uk

Matlock
T: 01629 828250
E: matlock@saxtonmee.co.uk

