



5, Orme Court Granby Road, Bakewell, Derbyshire, DE45 1ES



Orme Court Granby Road

Offers In The Region Of

£215,000

Sought After Historic Market Town

This two-bedroom apartment, located on the second floor, comes with an allocated parking space. Centrally positioned, it offers easy access to the excellent range of shops, leisure facilities, and amenities that historic Bakewell has to offer.

The apartment comprises a communal entrance hall, a private entrance hall with a security intercom, a spacious, light and airy living/dining room with views across the town, a fitted kitchen, two bedrooms, and a bathroom.

It is equipped with electric storage heaters.

Bakewell is a picturesque market town in the heart of the Peak District National Park, surrounded by stunning Derbyshire countryside. The location provides easy access to local walks and adjoining villages, with good recreational facilities, local transport links and convenient connections to Buxton, Chesterfield, and Sheffield.

No Upward Chain.

- Centrally Positioned In The Historic Town Centre
- Lift & Stairs Access
- Easy Reach Of Excellent Shops & Leisure Facilities
- Bordered By Spectacular Derbyshire Countryside
- Light And Airy Accommodation & Well Presented
- Allocated Parking For One Vehicle
- No Upward Chain
- Ideal Main Home Or Investment Property
- EPC: TBC
- Viewings: Bakewell Office





5 Orme Court

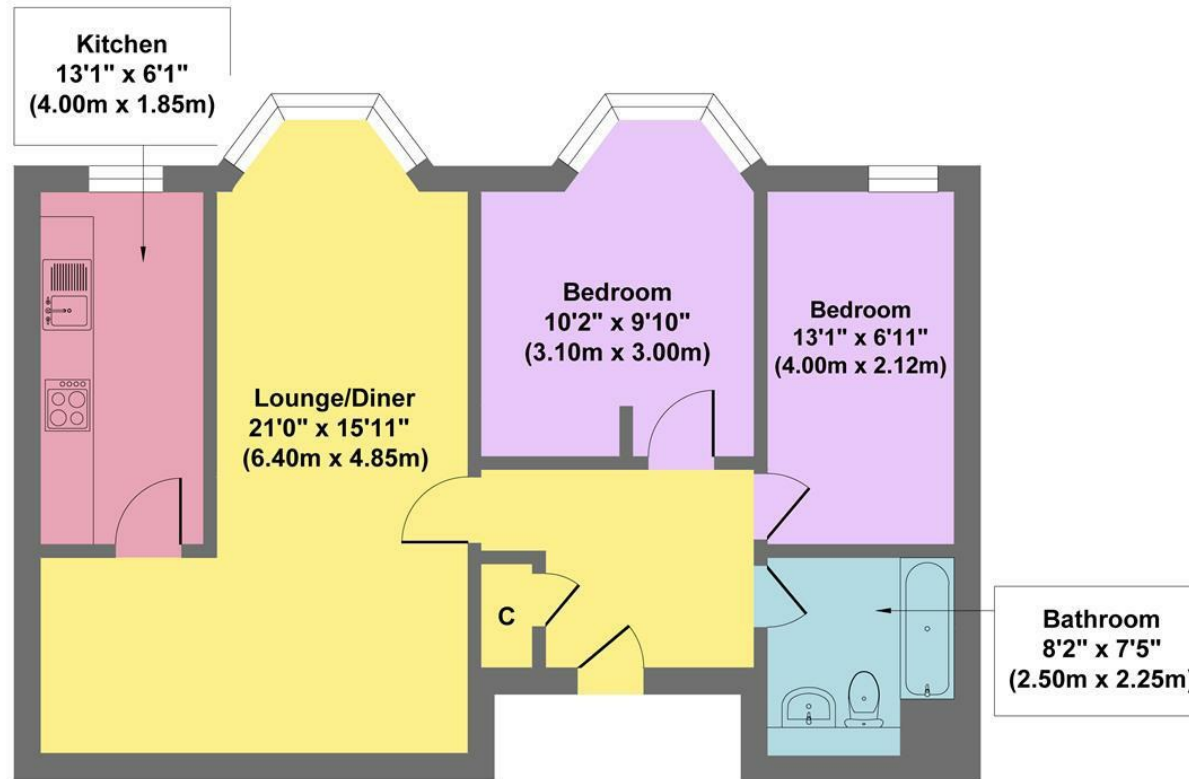

Approximate Floor Area
697 sq.ft
(64.80 sq.m.)

Approx. Gross Internal Floor Area 697 sq.ft / 64.80 sq.m

Illustration for identification purposes only, measurements are approximate, not to scale

While we endeavour to make our sales particulars fair, accurate and reliable, they are only a general guide to the property and, accordingly, if there is any point, which is of particular importance to you, please contact the relevant office. The Agents have not tested any apparatus, equipment, fittings or services and so cannot verify they are in working order. The buyer is advised to obtain verification. Please note all the measurement details are approximate and should not be relied upon as exact. All plans, floor plans and maps are for guidance purposes only and are not to scale. Under no circumstances should they be relied upon as exact or for use in planning carpets and other such fixtures, fittings or furnishings. YOUR HOME IS AT RISK IF YOU DO NOT KEEP UP REPAYMENTS ON A MORTGAGE OR OTHER LOAN SECURED ON IT. 'A Life Assurance policy may be requested.' 'Written Quotations of credit terms available on request.'

Banner Cross
T: 0114 268 3241
E: bannercross@saxtonmee.co.uk
www.saxtonmee.co.uk

Hathersage
T: 01433 650009
E: hathersage@saxtonmee.co.uk

Bakewell
T: 01629 815307
E: bakewell@saxtonmee.co.uk

Matlock
T: 01629 828250
E: matlock@saxtonmee.co.uk

