



Moonstones 2 Church Close, Peak Forest, Derbyshire, SK17 8EF

Saxton Mee

Moonstones 2 Church Close

Offers In The Region Of

£290,000

Enjoying an enviable position on a private road in the heart of the Peak District, this two double bedroom link-detached bungalow offers a rare opportunity to embrace peaceful rural living with uninterrupted views across open countryside. Chain free .

Situated in the picturesque village of Peak Forest, a charming Derbyshire community nestled among rolling hills and limestone scenery, the property combines a tranquil setting with a thriving village atmosphere. Known for its friendly community spirit and access to superb walking and cycling routes, Peak Forest is ideally placed for exploring nearby beauty spots including Castleton, Mam Tor and the wider Peak District National Park.

The bungalow itself is thoughtfully arranged to make the most of its setting, with an entrance hallway leading into a fitted kitchen and a spacious living and dining room where a log burning stove creates a warm, inviting focal point. The windows frame far-reaching views and double doors open directly onto the rear garden.

Both double bedrooms are fitted with wardrobes and a bathroom complete the accommodation. The property also benefits from modern additions including solar panels and an electric car charger, making it a more sustainable choice.

Externally, the rear garden is a particular highlight and offers breathtaking views and a real sense of privacy.

NO CHAIN

- Single Storey Living Accommodation
- Countryside Views
- Log Burning Stove
- Easy Commutable Distance Of Manchester & Sheffield
- Attractive Rear Garden
- Garage & Off Road Parking
- Offers Scope To Enlarge
- Solar Panels
- NO CHAIN
- Viewings: Hathersage Office





Moonstones

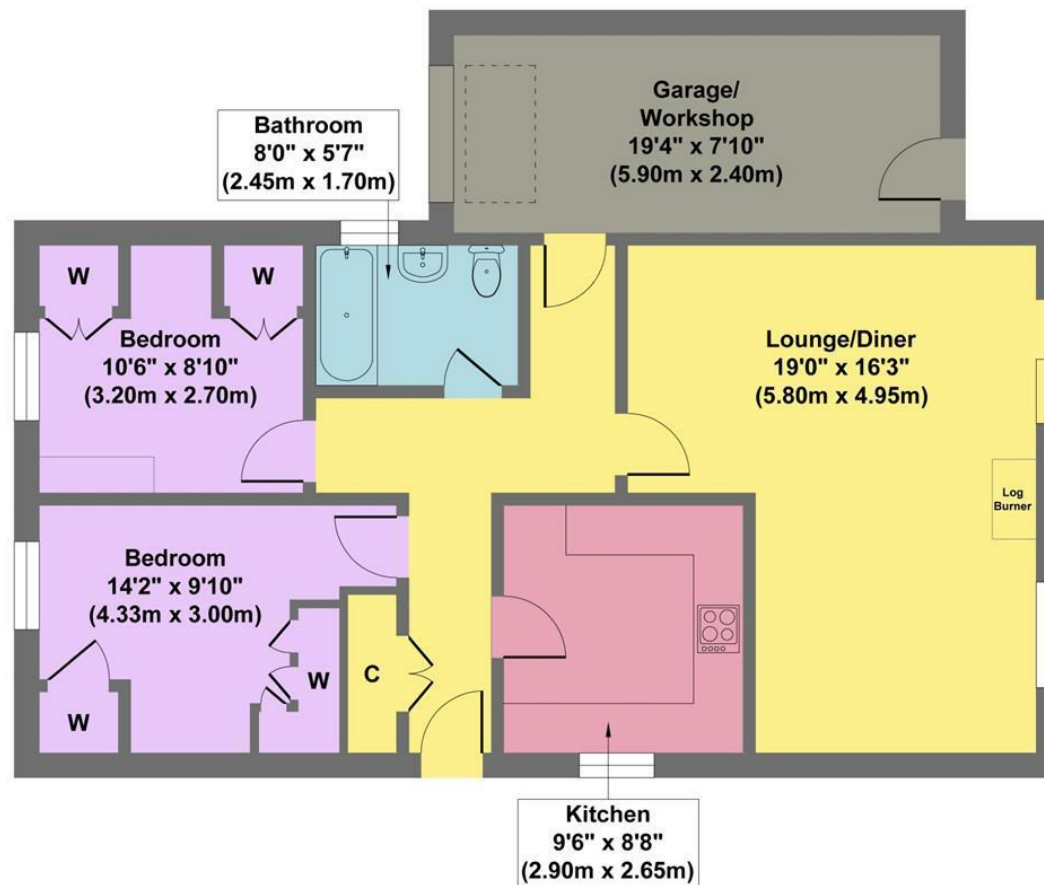

Approximate Floor Area
962 sq.ft
(89.33 sq.m.)

Approx. Gross Internal Floor Area 962 sq.ft / 89.33 sq.m

Illustration for identification puposes only ,measurements are approximate, not to scale

While we endeavour to make our sales particulars fair, accurate and reliable, they are only a general guide to the property and, accordingly, if there is any point, which is of particular importance to you, please contact the relevant office. The Agents have not tested any apparatus, equipment, fittings or services and so cannot verify they are in working order. The buyer is advised to obtain verification. Please note all the measurement details are approximate and should not be relied upon as exact. All plans, floor plans and maps are for guidance purposes only and are not to scale. Under no circumstances should they be relied upon as exact or for use in planning carpets and other such fixtures, fittings or furnishings. YOUR HOME IS AT RISK IF YOU DO NOT KEEP UP REPAYMENTS ON A MORTGAGE OR OTHER LOAN SECURED ON IT. 'A Life Assurance policy may be requested.' 'Written Quotations of credit terms available on request.'

Banner Cross
T: 0114 268 3241
E: bannercross@saxtonmee.co.uk
www.saxtonmee.co.uk

Hathersage
T: 01433 650009
E: hathersage@saxtonmee.co.uk

Bakewell
T: 01629 815307
E: bakewell@saxtonmee.co.uk

Matlock
T: 01629 828250
E: matlock@saxtonmee.co.uk

