



10 Glebe Park, Eyam, Derbyshire, S32 5RH

Saxton Mee

10 Glebe Park

Asking Price

£62,900

Nestled in the historic village of Eyam, this well presented two bedroom ground floor maisonette offers comfortable and convenient living in the heart of the Peak District. Known for its rich heritage and strong sense of community, Eyam is surrounded by breathtaking countryside, offering a range of scenic walks, local shops, a village school, tea rooms and a traditional country inn. With easy access to nearby market towns such as Bakewell and good transport links to Sheffield and Chesterfield, the village provides an ideal balance of rural charm and everyday convenience.

The property features a living dining kitchen. Two bedrooms and a shower room completes the layout. A charming front courtyard and shared area to the rear of the property.

A private covered parking space for one vehicle.

Offered to the market with no upward chain, the property is available on a shared ownership basis of 34%, with rent payable on the remaining share to a housing association.

Additionally, the property is subject to a ten-year parish clause, meaning applicants must establish an essential need to live in Eyam and complete an application form as part of the purchasing process.

This presents a unique opportunity for those wishing to become part of this vibrant village community while enjoying the beauty of the surrounding Peak District landscape.



- Ground Floor Living Accommodation
- Good Local Amenities
- Private Entrance Door
- Peaceful Village Setting
- Dedicated Covered Parking Space
- A 10 Year Parish Clause Applies
- Shared Ownership
- No Upward Chain
- EPC: TBC
- Viewings: Hathersage Office





10 Glebe Park

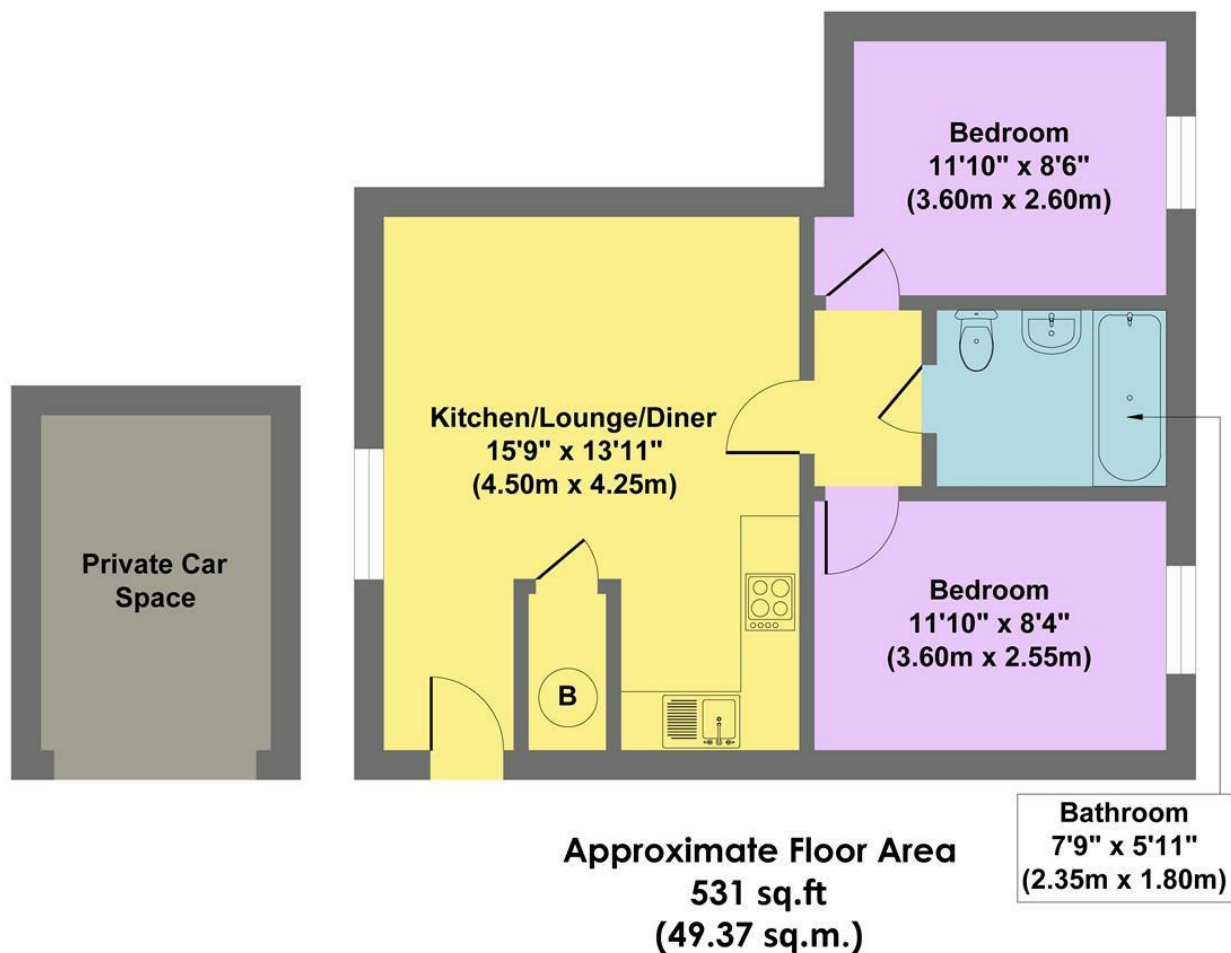

Approx. Gross Internal Floor Area 531 sq.ft / 49.37 sq.m

Illustration for identification purposes only, measurements are approximate, not to scale

While we endeavour to make our sales particulars fair, accurate and reliable, they are only a general guide to the property and, accordingly, if there is any point, which is of particular importance to you, please contact the relevant office. The Agents have not tested any apparatus, equipment, fittings or services and so cannot verify they are in working order. The buyer is advised to obtain verification. Please note all the measurement details are approximate and should not be relied upon as exact. All plans, floor plans and maps are for guidance purposes only and are not to scale. Under no circumstances should they be relied upon as exact or for use in planning carpets and other such fixtures, fittings or furnishings. YOUR HOME IS AT RISK IF YOU DO NOT KEEP UP REPAYMENTS ON A MORTGAGE OR OTHER LOAN SECURED ON IT. 'A Life Assurance policy may be requested.' 'Written Quotations of credit terms available on request.'

Banner Cross
T: 0114 268 3241
E: bannercross@saxtonmee.co.uk
www.saxtonmee.co.uk

Hathersage
T: 01433 650009
E: hathersage@saxtonmee.co.uk

Bakewell
T: 01629 815307
E: bakewell@saxtonmee.co.uk

Matlock
T: 01629 828250
E: matlock@saxtonmee.co.uk

