



5 Sir William Terrace, Grindleford, Derbyshire, S32 2HU

Saxton Mee

5 Sir William Terrace

Offers Around

£300,000

In a stunning location, a two bedroom mid terrace cottage with spectacular views over the valley and in the picturesque village of Grindleford. Offered for sale with early vacant possession and completed chain.

This charming property has the benefit of a garage and attractive garden and is an ideal retreat, in a peaceful location, yet convenient position, with excellent transport links including local train station. The village also has a local shop, primary school and country inns and is set in the heart of the natural beauty of the Peak District.

Ground Floor dining kitchen, walk-in pantry, lounge with feature fireplace and stunning open views. First Floor: double bedroom one, single bedroom two and bathroom with full suite. Good sized loft with potential for conversion. Outside: to the front, south easterly facing garden with uninterrupted views over the valley. To the rear, vehicular access and garage. Garden shed and greenhouse and attractive garden.



- Fabulous Uninterrupted Far Reaching Views Over the Valley
- Two Bedroom Stone Built Mid Terrace Cottage
- Garage and Attractive Gardens to Front and Rear
- For Sale with Early Vacant Possession and No Chain
- Thriving Village Community with Local Shop, Pubs and Railway Station
- Direct Access to Wealth of Outdoor Pursuits in the Heart of the Peak District
- Potential for Loft Conversion
- Early Viewing Strongly Recommended
- EPC Rating TBC
- Viewing: Hathersage Office





5 Sir William Hill Terrace

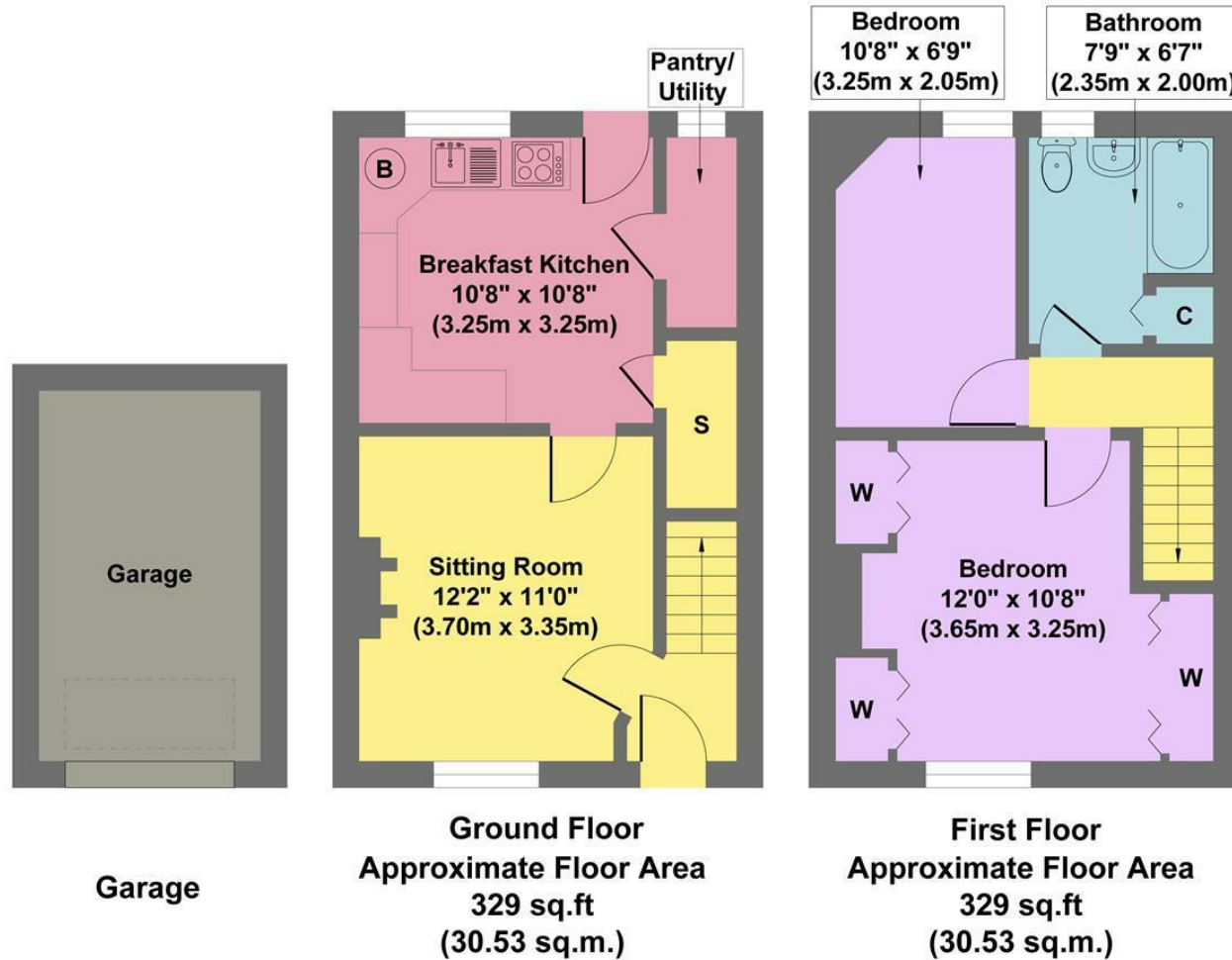

**Approx. Gross Internal Floor Area 658 sq.ft / 61.06 sq.m
(Excluding Garage)**

Illustration for identification puposes only ,measurements are approximate, not to scale

While we endeavour to make our sales particulars fair, accurate and reliable, they are only a general guide to the property and, accordingly, if there is any point, which is of particular importance to you, please contact the relevant office. The Agents have not tested any apparatus, equipment, fittings or services and so cannot verify they are in working order. The buyer is advised to obtain verification. Please note all the measurement details are approximate and should not be relied upon as exact. All plans, floor plans and maps are for guidance purposes only and are not to scale. Under no circumstances should they be relied upon as exact or for use in planning carpets and other such fixtures, fittings or furnishings. YOUR HOME IS AT RISK IF YOU DO NOT KEEP UP REPAYMENTS ON A MORTGAGE OR OTHER LOAN SECURED ON IT. 'A Life Assurance policy may be requested.' 'Written Quotations of credit terms available on request.'

Banner Cross
T: 0114 268 3241
E: bannercross@saxtonmee.co.uk
www.saxtonmee.co.uk

Hathersage
T: 01433 650009
E: hathersage@saxtonmee.co.uk

Bakewell
T: 01629 815307
E: bakewell@saxtonmee.co.uk

Matlock
T: 01629 828250
E: matlock@saxtonmee.co.uk

