



Riverside Court, Flat 8 Calver Road, Baslow, Derbyshire, DE45 1RD

Saxton Mee

Flat 8 Calver Road

Guide Price

£225,000

Idyllic Riverside Views Over The River Wye & Impressive Derbyshire Countryside!

£225,000 - £235,000 Guide Price.

A two bedroom first floor apartment with a balcony terrace overlooking the River Derwent and a private covered parking space in the adjoining parking area.

Set in the highly sought after village of Baslow boasting local shops, Post Office, cafes, restaurants and country inns. The Chatsworth Country Estate, historic Bakewell and Haddon Hall are close by as well as easy reach of Sheffield, Chesterfield & Manchester.

The accommodation comprises: communal entrance hall, hallway, a living room opens onto the balcony terrace. A fitted kitchen with integrated appliances, a double bedroom with fitted wardrobes, a shower room and a single bedroom with fitted wardrobes.

No Upwards Chain.

Lease: 999 years from 25/03/1980 with 957 years remaining

Ground Rent: £100 pa

Service Charge: £840 pa (Two payments of £420 are payable in March & September)

Council Tax Band C



- Idyllic Riverside Views
- Highly Sought After Setting
- Well Presented Throughout
- Balcony Overlooking River
- Gas Central Heating & Double Glazing
- Close To Excellent Village Amenities
- Covered Off Road Parking Space
- No Upward Chain
- EPC: C
- Viewings: Hathersage Office



8 Riverside Court

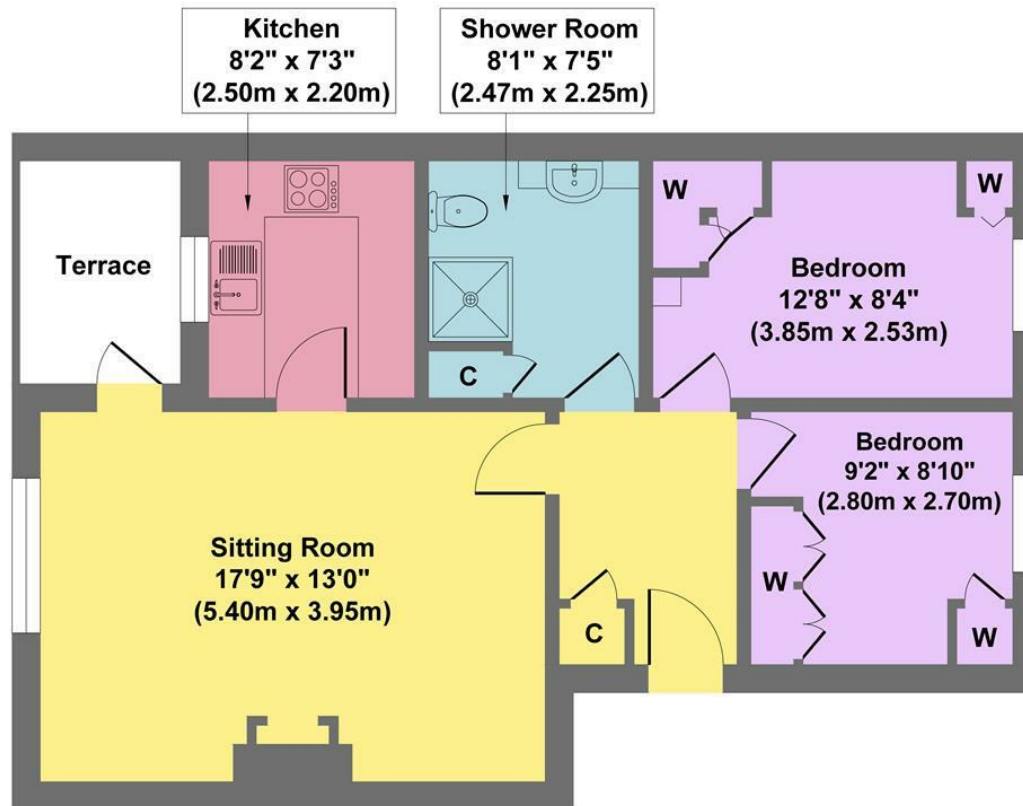

Approximate Floor Area
Area 623 sq.ft
(57.87 sq.m.)

Approx. Gross Internal Floor Area 623 sq.ft / 57.87 sq.m

Illustration for identification puposes only ,measurements are approximate, not to scale

While we endeavour to make our sales particulars fair, accurate and reliable, they are only a general guide to the property and, accordingly, if there is any point, which is of particular importance to you, please contact the relevant office. The Agents have not tested any apparatus, equipment, fittings or services and so cannot verify they are in working order. The buyer is advised to obtain verification. Please note all the measurement details are approximate and should not be relied upon as exact. All plans, floor plans and maps are for guidance purposes only and are not to scale. Under no circumstances should they be relied upon as exact or for use in planning carpets and other such fixtures, fittings or furnishings. YOUR HOME IS AT RISK IF YOU DO NOT KEEP UP REPAYMENTS ON A MORTGAGE OR OTHER LOAN SECURED ON IT. 'A Life Assurance policy may be requested.' 'Written Quotations of credit terms available on request.'

Banner Cross
T: 0114 268 3241
E: bannercross@saxtonmee.co.uk
www.saxtonmee.co.uk

Dronfield
T: 01246 290992
E: dronfield@saxtonmee.co.uk

Hathersage
T: 01433 650009
E: hathersage@saxtonmee.co.uk

Bakewell
T: 01629 815307
E: bakewell@saxtonmee.co.uk

