



71 Helmtan Road, Woodseats, Sheffield, S8 8QJ



71 Helmtan Road

Woodseats

Offers Around

£325,000

A deceptively spacious three/four bedroom extended semi detached family home offering an abundance of space with an outbuilding which currently provides an additional annex. This lovely home would be ideal for the growing family perhaps with an independent teenager or dependent relative and suits a variety of different uses.

The property briefly comprises:

Entrance porch into entrance lobby, lounge with feature fireplace, separate family room leading into dining room. The kitchen is fitted with a range of base, drawer and wall units with plenty of storage. There is also a further utility room providing space and plumbing for an automatic washing machine.

To the first floor there are two good size double bedrooms and a good size single. The family bathroom is furnished with a white suite comprising of a bath with shower above, pedestal wash hand basin and low flush w.c..

The outbuilding/annex offers a very versatile space with a kitchen area, w/c, living area and double bedroom. This area is currently used as storage and a gym.

Externally the property has a garden to the front and a driveway providing off road parking. To the rear is a private rear garden with patio and lawn.

A viewing is highly recommended in order to understand and appreciate the accommodation on offer.

The location in Woodseats is particularly appealing, with a range of local amenities, schools, and parks within easy reach. The area is well-connected to Sheffield city centre, making it ideal for those who commute or enjoy the vibrant city life.

In summary, this semi-detached house on Helmtan Road is a wonderful family home that combines space, versatility, and a prime location. It is an opportunity not to be missed for those looking to settle in a welcoming community.



- WITH ANNEX/OUTBUILDING
- EXTENDED TO THE REAR
- WELL PRESENTED THROUGHOUT
- THREE/FOUR BEDROOMS
- CONVENIENT AND POPULAR LOCATION
- GARDENS TO FRONT AND REAR
- EPC RATING: C
- COUNCIL TAX BAND: B
- TENURE: FREEHOLD
- VIEWINGS VIA BANNER CROSS BRANCH.





Ground Floor
Floor area 51.2 sq.m. (552 sq.ft.)

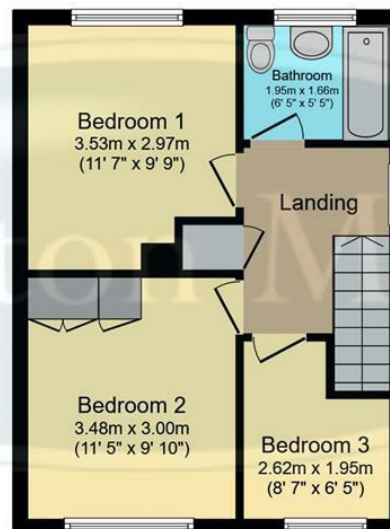

First Floor
Floor area 37.0 sq.m. (399 sq.ft.)



Annexe
Floor area 24.8 sq.m. (266 sq.ft.)

Total floor area: 113.0 sq.m. (1,217 sq.ft.)

This floor plan is for illustrative purposes only. It is not drawn to scale. Any measurements, floor areas (including any total floor area), openings and orientations are approximate. No details are guaranteed, they cannot be relied upon for any purpose and do not form any part of any agreement. No liability is taken for any error, omission or misstatement. A party must rely upon its own inspection(s). Powered by www.Propertybox.io

While we endeavour to make our sales particulars fair, accurate and reliable, they are only a general guide to the property and, accordingly, if there is any point, which is of particular importance to you, please contact the relevant office. The Agents have not tested any apparatus, equipment, fittings or services and so cannot verify they are in working order. The buyer is advised to obtain verification. Please note all the measurement details are approximate and should not be relied upon as exact. All plans, floor plans and maps are for guidance purposes only and are not to scale. Under no circumstances should they be relied upon as exact or for use in planning carpets and other such fixtures, fittings or furnishings. YOUR HOME IS AT RISK IF YOU DO NOT KEEP UP REPAYMENTS ON A MORTGAGE OR OTHER LOAN SECURED ON IT. 'A Life Assurance policy may be requested.' 'Written Quotations of credit terms available on request.'

Banner Cross
T: 0114 268 3241
E: bannercross@saxtonmee.co.uk
www.saxtonmee.co.uk

Hathersage
T: 01433 650009
E: hathersage@saxtonmee.co.uk

Bakewell
T: 01629 815307
E: bakewell@saxtonmee.co.uk

Matlock
T: 01629 828250
E: matlock@saxtonmee.co.uk

Saxton Mee