



431 Greystones Road, Sheffield, S11 7BY

Saxton Mee

431 Greystones Road

Guide Price

£350,000

GUIDE PRICE £350,000 - £375,000

Delightful Three-Bedroom Semi-Detached Home in the Heart of Greystones with NO ONWARD CHAIN.

Located in the ever-popular and sought-after suburb of Greystones, this charming house offers an excellent opportunity for families or professionals looking for a home with both character and potential. Perfectly positioned just moments from Bingham Park and Whitley Woods, the property benefits from an abundance of nearby green space and is within easy reach of highly regarded local schools, making it ideal for family living.

The house has been partially renovated, with the bathroom and one of the bedrooms already updated to a modern standard. The rest of the home presents a fantastic opportunity for the next owners to finish renovating and tailor the space to their own tastes and needs.

On the ground floor, a welcoming hallway leads through to a bright and generously sized living room at the front of the property. To the rear, the dining room offers views over the garden and connects to a well-proportioned kitchen.

Upstairs, the home features three well-sized bedrooms, including a spacious principal bedroom, a second comfortable double, and a third room ideal as a nursery, guest room, or home office. The modern bathroom is stylishly finished and ready to use.

Externally, the property boasts a sloped gradient garden, mainly laid to lawn, which enjoys lovely views—perfect for relaxing, entertaining, or simply soaking up the surroundings. There's also scope to landscape or further develop the outdoor space, subject to permissions.

With an approximate total area of 954 sq. ft. (88.65 m²), this is a home with great potential in one of Sheffield's most desirable locations. Greystones offers a friendly community feel with excellent amenities, independent shops, cafés, and public transport links all within easy reach.



- Fantastic Location Close to an Abundance of Green Spaces and Highly Regarded Schools
- Priced to Sell, this house has so much potential and internal viewings are highly recommended
- Three Good Size Bedrooms
- Modern Family Bathroom and Lovely Fitted Kitchen
- Good Size Garden but Please note that this is a sloped Garden
- The House and Garden Requires some Upgrading and is Perfect for Someone looking to add Improvements
- Greystones is popular for it's great local school's, easy access to amenities and green spaces
- No Onward Chain
- The property benefits from a cellar and loft for additional storage





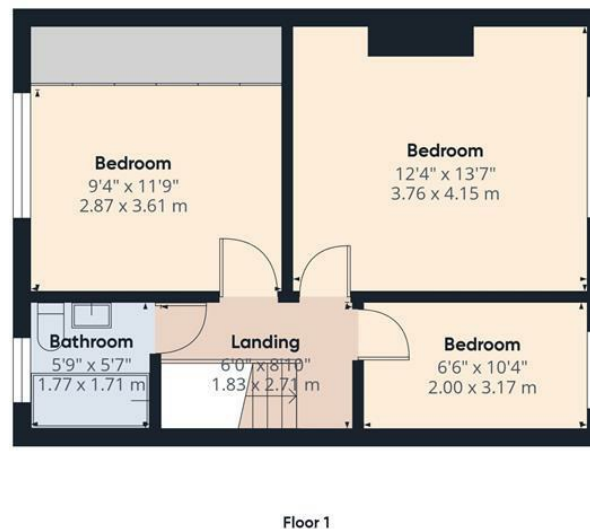
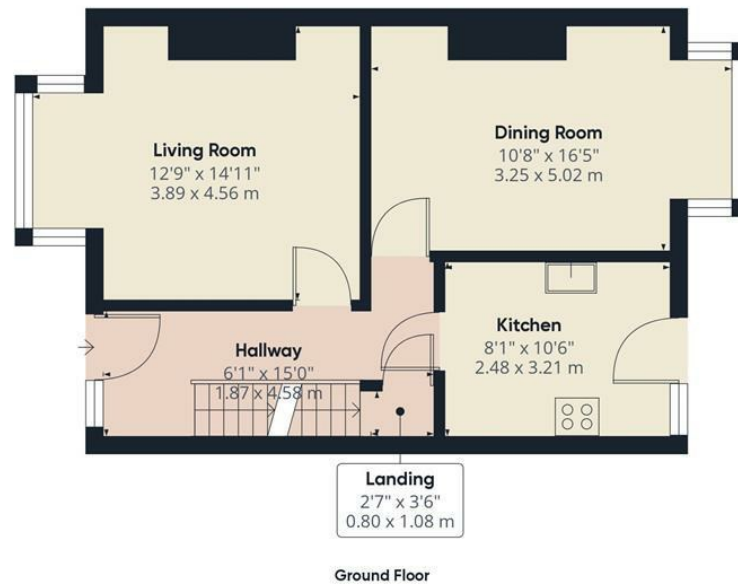

Approximate total area⁽¹⁾
954.22 ft²
88.65 m²

(1) Excluding balconies and terraces

While every attempt has been made to ensure accuracy, all measurements are approximate, not to scale. This floor plan is for illustrative purposes only.

Calculations are based on RICS IPMS 3C standard.

GIRAFFE360

While we endeavour to make our sales particulars fair, accurate and reliable, they are only a general guide to the property and, accordingly, if there is any point, which is of particular importance to you, please contact the relevant office. The Agents have not tested any apparatus, equipment, fittings or services and so cannot verify they are in working order. The buyer is advised to obtain verification. Please note all the measurement details are approximate and should not be relied upon as exact. All plans, floor plans and maps are for guidance purposes only and are not to scale. Under no circumstances should they be relied upon as exact or for use in planning carpets and other such fixtures, fittings or furnishings. YOUR HOME IS AT RISK IF YOU DO NOT KEEP UP REPAYMENTS ON A MORTGAGE OR OTHER LOAN SECURED ON IT. 'A Life Assurance policy may be requested.' 'Written Quotations of credit terms available on request.'

Banner Cross
T: 0114 268 3241
E: bannercross@saxtonmee.co.uk
www.saxtonmee.co.uk

Hathersage
T: 01433 650009
E: hathersage@saxtonmee.co.uk

Bakewell
T: 01629 815307
E: bakewell@saxtonmee.co.uk

Matlock
T: 01629 828250
E: matlock@saxtonmee.co.uk

