



Apartment 2 Graham Lodge 416 Fulwood Road, Sheffield, South Yorkshire,

Saxton Mee

Apartment 2 Graham

Offers Around

£450,000

Spacious ground floor apartment with its own garden and detached garage!

If you are looking for a property with period features, high ceilings and large windows, this property is definitely a must-see. This spacious ground floor apartment has its own front door and is located on Fulwood Road, in easy proximity to the hospitals and universities. This delightful property which is offered with no onward vendor chain briefly comprises;

Entrance hallway, spacious lounge -dining room with large bay window and feature fireplace. Small kitchen, shower room with w.c., and two double bedrooms. This property offers lots of scope (subject to the necessary management consents) for enhancement with a number of rooms below which other residents in the development have converted.

Additionally, this property includes its own garden, providing a lovely outdoor space for relaxation or gardening enthusiasts. The convenience of having a front door adds to the sense of privacy and independence that this flat offers. For those with a vehicle, parking is available for one car, making it easy to come and go as you please.

Access to the apartment can also be gained through the main central hallway of the house.

- NO ONWARD VENDOR CHAIN
- GROUND FLOOR WITH OWN FRONT DOOR
- OWN GARDEN
- TWO DOUBLE BEDROOMS
- SPACIOUS LOUNGE/DINING ROOM
- PERIOD FEATURES
- CELLAR STORAGE AND DETACHED GARAGE
- EPC RATING: D
- COUNCIL TAX BAND: C





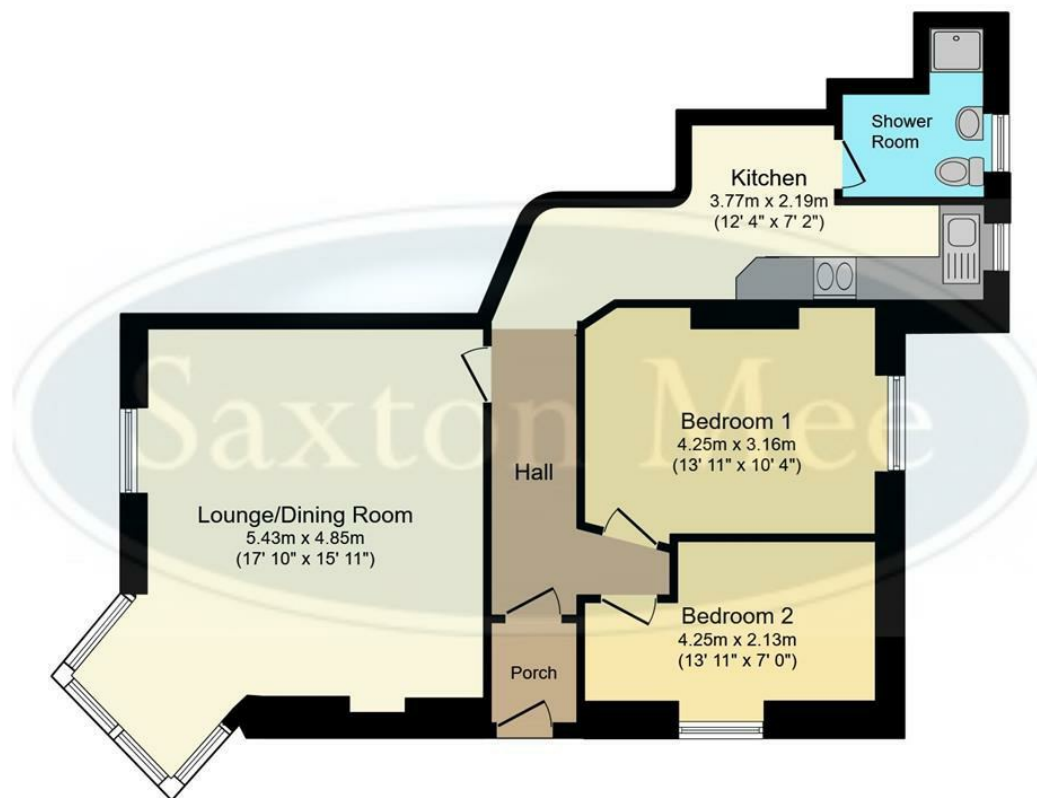

Floor Plan

Floor area 76.3 sq.m. (821 sq.ft.)

Total floor area: 76.3 sq.m. (821 sq.ft.)

This floor plan is for illustrative purposes only. It is not drawn to scale. Any measurements, floor areas (including any total floor area), openings and orientations are approximate. No details are guaranteed, they cannot be relied upon for any purpose and do not form any part of any agreement. No liability is taken for any error, omission or misstatement. A party must rely upon its own inspection(s). Powered by www.Propertybox.io

While we endeavour to make our sales particulars fair, accurate and reliable, they are only a general guide to the property and, accordingly, if there is any point, which is of particular importance to you, please contact the relevant office. The Agents have not tested any apparatus, equipment, fittings or services and so cannot verify they are in working order. The buyer is advised to obtain verification. Please note all the measurement details are approximate and should not be relied upon as exact. All plans, floor plans and maps are for guidance purposes only and are not to scale. Under no circumstances should they be relied upon as exact or for use in planning carpets and other such fixtures, fittings or furnishings. YOUR HOME IS AT RISK IF YOU DO NOT KEEP UP REPAYMENTS ON A MORTGAGE OR OTHER LOAN SECURED ON IT. 'A Life Assurance policy may be requested.' 'Written Quotations of credit terms available on request.'

Banner Cross
T: 0114 268 3241
E: bannercross@saxtonmee.co.uk
www.saxtonmee.co.uk

Hathersage
T: 01433 650009
E: hathersage@saxtonmee.co.uk

Bakewell
T: 01629 815307
E: bakewell@saxtonmee.co.uk

Matlock
T: 01629 828250
E: matlock@saxtonmee.co.uk

Saxton Mee