



33 Park Grange Court, Sheffield, S2 3SY

Saxton Mee



# 33 Park Grange Court

Asking Price

## £165,000

A beautifully presented two bedroom mid town house offering superb accommodation and offering an ideal purchase for the young first time buyer who wants to move in with no work to be done. This lovely property has been well maintained by the current owners and offers modern living with easy access into Sheffield City Centre and the Sheffield Parkway.

This lovely family home briefly comprises; Entrance lobby, light and airy lounge and well equipped modern fitted dining kitchen. There are integrated appliances and plenty of space for a dining table. There is also a downstairs w.c. T

To the first floor are two good size bedrooms and a family bathroom with bath and shower above, wash hand basin with vanity unit underneath and low flush w.c.

To the front of the property there is off road parking and a small planted area. To the rear of the property is a private garden with patio area and lawn.

Properties in this area prove popular due to the easy access into Sheffield City Centre, the super tram and bus links. An internal inspection is highly recommended.

Tenure: Leasehold.

- BEAUTIFULLY PRESENTED THROUGHOUT
- GOOD SIZE LOUNGE
- MODERN FITTED DINING KITCHEN
- DOWNSTAIRS W.C.
- TWO GOOD SIZE BEDROOMS
- FAMILY BATHROOM
- OFF ROAD PARKING AND GARDENS
- EPC RATING
- COUNCIL TAX BAND
- VIEWINGS VIA BANNER CROSS BRANCH







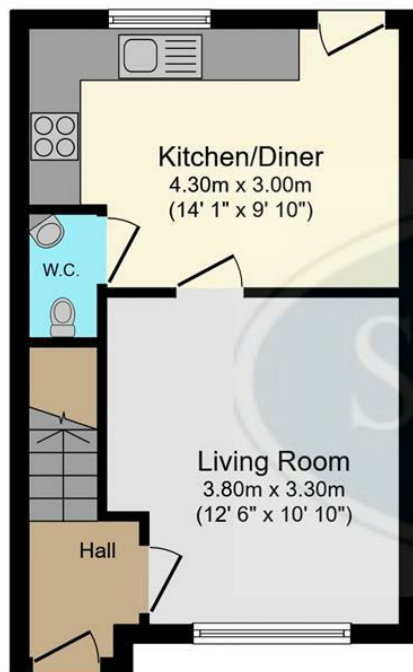

## Ground Floor

Floor area 30.1 m<sup>2</sup> (324 sq.ft.)

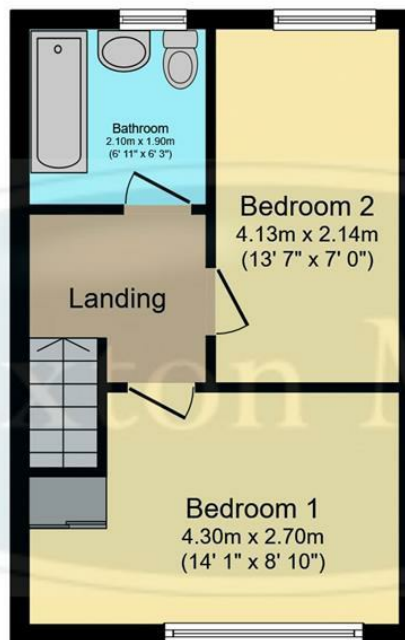

## First Floor

Floor area 29.7 m<sup>2</sup> (320 sq.ft.)



**TOTAL: 59.8 m<sup>2</sup> (644 sq.ft.)**

This floor plan is for illustrative purposes only. It is not drawn to scale. Any measurements, floor areas (including any total floor area), openings and orientations are approximate. No details are guaranteed, they cannot be relied upon for any purpose and do not form any part of any agreement. No liability is taken for any error, omission or misstatement. A party must rely upon its own inspection(s). Powered by [www.Propertybox.io](http://www.Propertybox.io)

While we endeavour to make our sales particulars fair, accurate and reliable, they are only a general guide to the property and, accordingly, if there is any point, which is of particular importance to you, please contact the relevant office. The Agents have not tested any apparatus, equipment, fittings or services and so cannot verify they are in working order. The buyer is advised to obtain verification. Please note all the measurement details are approximate and should not be relied upon as exact. All plans, floor plans and maps are for guidance purposes only and are not to scale. Under no circumstances should they be relied upon as exact or for use in planning carpets and other such fixtures, fittings or furnishings. YOUR HOME IS AT RISK IF YOU DO NOT KEEP UP REPAYMENTS ON A MORTGAGE OR OTHER LOAN SECURED ON IT. 'A Life Assurance policy may be requested.' 'Written Quotations of credit terms available on request.'

Banner Cross  
T: 0114 268 3241  
E: [bannercross@saxtonmee.co.uk](mailto:bannercross@saxtonmee.co.uk)  
[www.saxtonmee.co.uk](http://www.saxtonmee.co.uk)

Hathersage  
T: 01433 650009  
E: [hathersage@saxtonmee.co.uk](mailto:hathersage@saxtonmee.co.uk)

Bakewell  
T: 01629 815307  
E: [bakewell@saxtonmee.co.uk](mailto:bakewell@saxtonmee.co.uk)

Matlock  
T: 01629 828250  
E: [matlock@saxtonmee.co.uk](mailto:matlock@saxtonmee.co.uk)

