



18A Lismore Road, Sheffield, S8 9JD

Saxton Mee

18A Lismore Road

£550,000

Guide Price £550,000 to £575,000

This exceptional 5-bedroom detached house, built in 2008 and architecturally designed, is situated in the highly sought-after area of Meersbrook, close to a range of amenities and excellent transport links. Spanning three floors, this spacious and light-filled home offers contemporary living at its finest, with the added benefit of solar panels for improved energy efficiency and supplementing the hot water supply.

On the ground floor, you'll find a welcoming entrance hall, a convenient downstairs WC, and a modern fitted kitchen that seamlessly flows into a generous dining area, perfect for family meals and entertaining. A separate utility room adds practicality, while the bright and airy lounge boasts large doors opening out onto the private garden, creating an ideal indoor-outdoor living space.

The first floor features three well-proportioned bedrooms, including one with an en-suite, as well as a stylish family bathroom. Stairs lead to the second floor, where you'll discover two further spacious bedrooms and a contemporary shower room, providing flexible living options for a growing family or those who work from home.

This unique property is offered for sale with no onward chain, providing a seamless move for its new owners. With its exceptional design, spacious layout, and prime location, viewings are highly recommended to truly appreciate just how spectacular this home is. Don't miss the chance to make this stunning house your forever home.



- Architect Designed Unique Detached Property
- Excellent Location Nestled Within the Heart of Meersbrook
- Parking on the Driveway
- Lovely Level Rear Garden
- Spacious and Bright Rooms
- Downstairs WC
- En-Suite to the Master Bedroom
- Offered for Sale With No Onward Chain
- FREEHOLD
- Council Tax Band: D



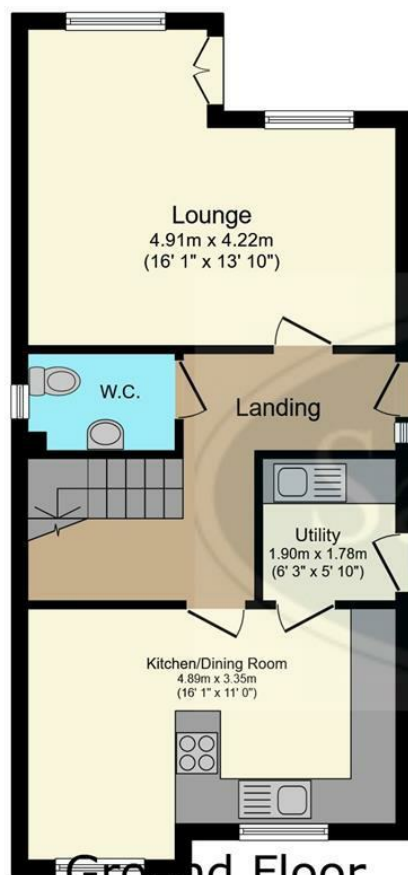

Ground Floor

Floor area 49.6 m² (534 sq.ft.)

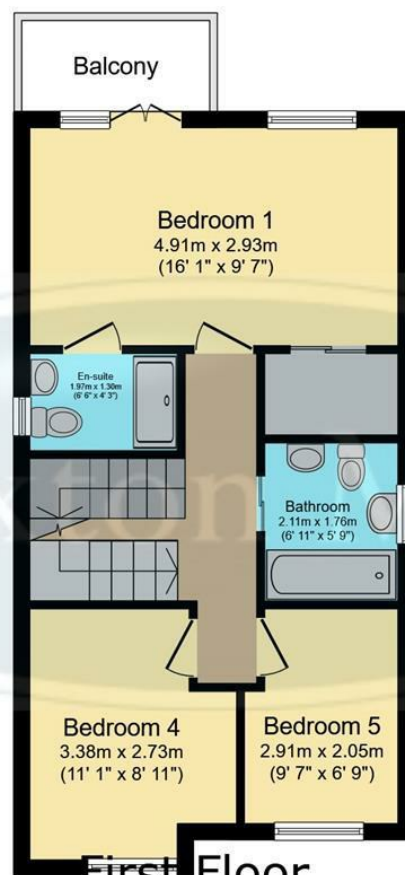

First Floor

Floor area 46.5 m² (501 sq.ft.)

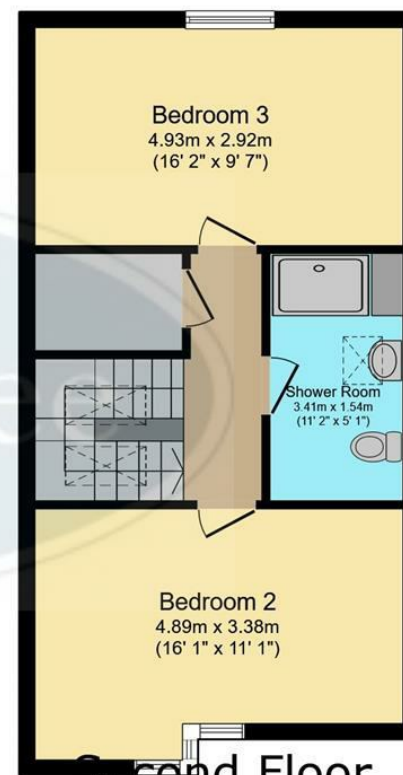

Second Floor

Floor area 46.5 m² (500 sq.ft.)

TOTAL: 142.6 m² (1,535 sq.ft.)

This floor plan is for illustrative purposes only. It is not drawn to scale. Any measurements, floor areas (including any total floor area), openings and orientations are approximate. No details are guaranteed, they cannot be relied upon for any purpose and do not form any part of any agreement. No liability is taken for any error, omission or misstatement. A party must rely upon its own inspection(s). Powered by www.Propertybox.io

While we endeavour to make our sales particulars fair, accurate and reliable, they are only a general guide to the property and, accordingly, if there is any point, which is of particular importance to you, please contact the relevant office. The Agents have not tested any apparatus, equipment, fittings or services and so cannot verify they are in working order. The buyer is advised to obtain verification. Please note all the measurement details are approximate and should not be relied upon as exact. All plans, floor plans and maps are for guidance purposes only and are not to scale. Under no circumstances should they be relied upon as exact or for use in planning carpets and other such fixtures, fittings or furnishings. YOUR HOME IS AT RISK IF YOU DO NOT KEEP UP REPAYMENTS ON A MORTGAGE OR OTHER LOAN SECURED ON IT. 'A Life Assurance policy may be requested.' 'Written Quotations of credit terms available on request.'

Banner Cross
T: 0114 268 3241
E: bannercross@saxtonmee.co.uk
www.saxtonmee.co.uk

Hathersage
T: 01433 650009
E: hathersage@saxtonmee.co.uk

Bakewell
T: 01629 815307
E: bakewell@saxtonmee.co.uk

Matlock
T: 01629 828250
E: matlock@saxtonmee.co.uk

