



5 The Pines, Lodge Moor, Sheffield, S10 4LZ

Saxton Mee

5 The Pines

Lodge Moor

Asking Price

£625,000

A beautifully presented four double bedroom detached family home located in this highly regarded area in the catchment area for excellent schools and offering spacious modern accommodation throughout. Having been lovingly maintained by the current owners, this delightful, light and airy home briefly comprises;

Entrance hallway, downstairs w.c. lounge, and modern fitted dining kitchen with a range of base, drawer and wall units, central island with quartz work surfaces and integrated appliances. Separate utility room. Within the kitchen there is also a very useful study area/home office area.

To the first floor are four excellent size bedrooms-the master bedroom having an en-suite shower room and having a further family bathroom with bath, wash hand basin and w.c.

To the front of the property is a garden which is mainly lawn and there is a driveway providing off road parking and access to the integral single garage. To the rear of the property is a well maintained garden which is private and has lawn, patio area and a variety of mature shrubs and trees.

An internal inspection is highly recommended.



- Four Double Bedroom Detached Family Home
- Spacious And Modern Throughout
- Dining Kitchen With Integrated Appliances
- Utility Room And Downstairs WC
- Master Bedroom With En-Suite Shower Room
- Off Road Parking And Integral Garage
- Private Rear Garden Ideal For Entertaining
- In The Catchment For Excellent Schools
- Council Tax Band F/ EPC Rating D/Freehold
- Viewings Via Banner Cross Branch







Ground Floor

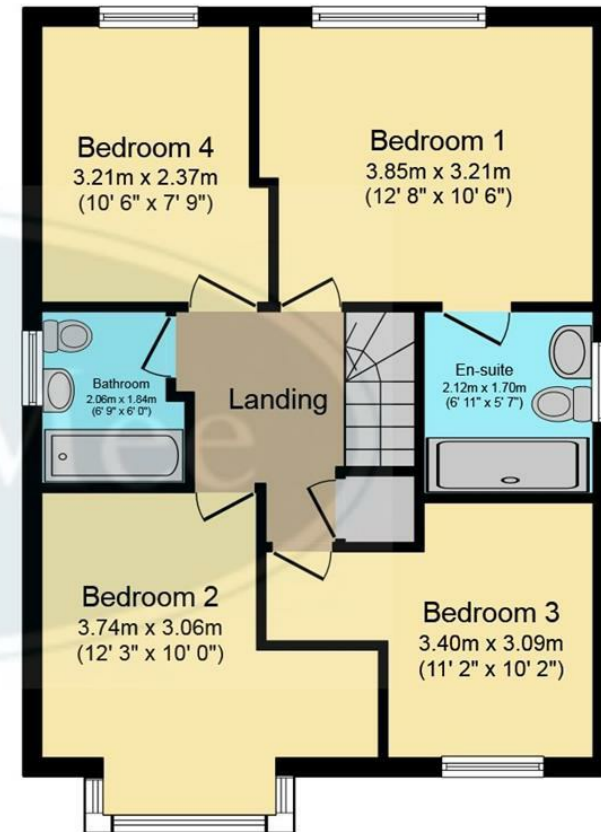

First Floor

Total floor area 133.0 m² (1,432 sq.ft.) approx

This plan is for illustration purposes only and may not be representative of the property. Plan not to scale. Powered by PropertyBox

While we endeavour to make our sales particulars fair, accurate and reliable, they are only a general guide to the property and, accordingly, if there is any point, which is of particular importance to you, please contact the relevant office. The Agents have not tested any apparatus, equipment, fittings or services and so cannot verify they are in working order. The buyer is advised to obtain verification. Please note all the measurement details are approximate and should not be relied upon as exact. All plans, floor plans and maps are for guidance purposes only and are not to scale. Under no circumstances should they be relied upon as exact or for use in planning carpets and other such fixtures, fittings or furnishings. YOUR HOME IS AT RISK IF YOU DO NOT KEEP UP REPAYMENTS ON A MORTGAGE OR OTHER LOAN SECURED ON IT. 'A Life Assurance policy may be requested.' 'Written Quotations of credit terms available on request.'

Banner Cross
T: 0114 268 3241
E: bannercross@saxtonmee.co.uk
www.saxtonmee.co.uk

Hathersage
T: 01433 650009
E: hathersage@saxtonmee.co.uk

Bakewell
T: 01629 815307
E: bakewell@saxtonmee.co.uk

Matlock
T: 01629 828250
E: matlock@saxtonmee.co.uk

