



59 Bole Hill Lane, Crookes, Sheffield, S10 1SA

Saxton Mee

59 Bole Hill Lane

Crookes

Guide Price

£250,000

GUIDE PRICE £250,000-£260,000

Ideal for a first time buyer or young family is this immaculately presented, three bedroom mid-terrace located in this popular residential area of Crookes within walking distance of the Bole Hills, a range of shops, bars and cafes, regular transport links and the universities/hospitals.

Briefly, the accommodation comprises: Entrance lobby with stairs to the first floor. Bay windowed lounge to the front with electric fireplace and surround. Open plan dining/kitchen having a range of wall and base units with space for appliances including a washing machine, cooker and fridge/freezer. Downstairs cloakroom/W.C. To the first floor are two generous double bedrooms and a further single bedroom. Recently installed, modern and stylish family bathroom with bath and shower over, wash basin and W.C set within a vanity unit with tiling to the floor and walls. Loft space ideal for storage.

Outside there is a completely private garden with no third party access across having rear access with a lawn, patio, established planted areas and outdoor store.

- Three Bedroom Mid Terrace With Private Garden
- Ideal For A First Time Buyer
- Excellent Location Close To The Bole Hills
- Within Walking Distance Of A Host Of Amenities
- Modern Recently Fitted Bathroom Suite
- Well Regarded Schools Close By
- Delightful Views Over Rivelin Valley
- Council Tax Band A/EPC Rating C
- Leasehold With 710 Years Remaining
- Viewing Via Banner Cross Office





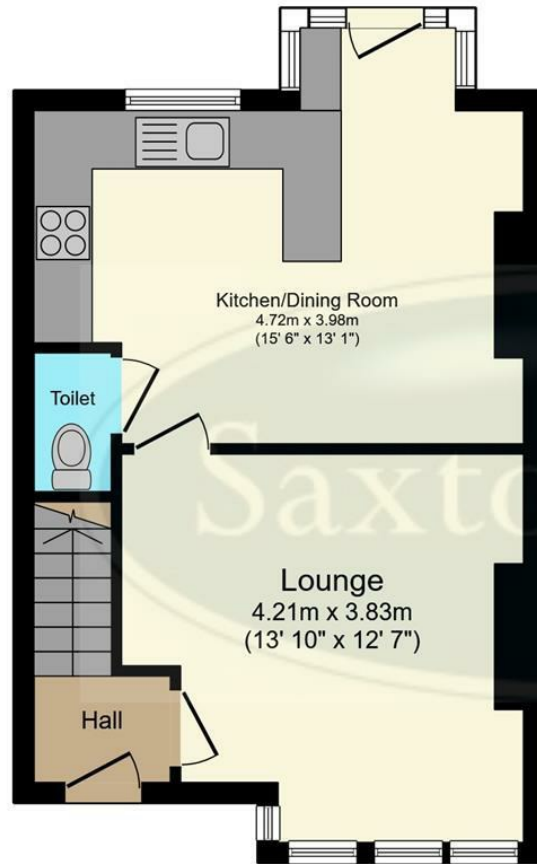

Ground Floor

Floor area 37.8 m² (407 sq.ft.)

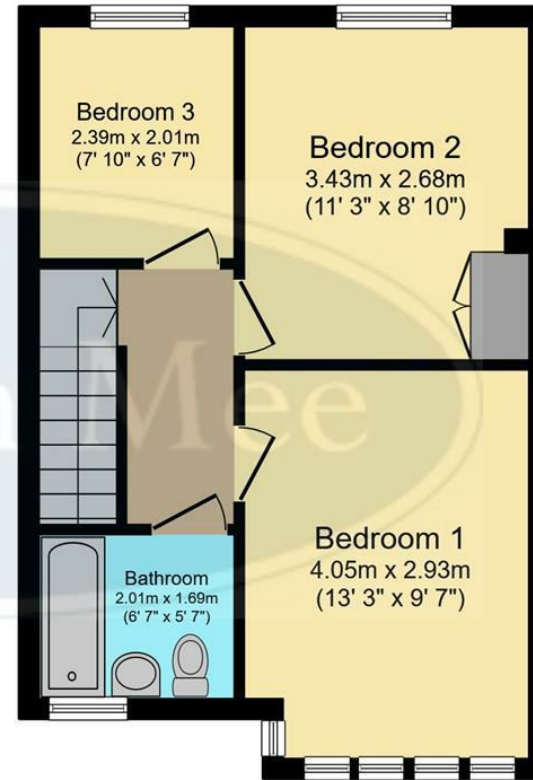

First Floor

Floor area 36.4 m² (392 sq.ft.)

TOTAL: 74.2 m² (798 sq.ft.)

This floor plan is for illustrative purposes only. It is not drawn to scale. Any measurements, floor areas (including any total floor area), openings and orientations are approximate. No details are guaranteed, they cannot be relied upon for any purpose and do not form any part of any agreement. No liability is taken for any error, omission or misstatement. A party must rely upon its own inspection(s). Powered by www.Propertybox.io

While we endeavour to make our sales particulars fair, accurate and reliable, they are only a general guide to the property and, accordingly, if there is any point, which is of particular importance to you, please contact the relevant office. The Agents have not tested any apparatus, equipment, fittings or services and so cannot verify they are in working order. The buyer is advised to obtain verification. Please note all the measurement details are approximate and should not be relied upon as exact. All plans, floor plans and maps are for guidance purposes only and are not to scale. Under no circumstances should they be relied upon as exact or for use in planning carpets and other such fixtures, fittings or furnishings. YOUR HOME IS AT RISK IF YOU DO NOT KEEP UP REPAYMENTS ON A MORTGAGE OR OTHER LOAN SECURED ON IT. 'A Life Assurance policy may be requested.' 'Written Quotations of credit terms available on request.'

Banner Cross
T: 0114 268 3241
E: bannercross@saxtonmee.co.uk
www.saxtonmee.co.uk

Hathersage
T: 01433 650009
E: hathersage@saxtonmee.co.uk

Bakewell
T: 01629 815307
E: bakewell@saxtonmee.co.uk

Matlock
T: 01629 828250
E: matlock@saxtonmee.co.uk

