



6 Hillcote Drive
Fulwood
Sheffield
S10 3PJ

Saxton Mee



6 Hillcote Drive, Fulwood, Sheffield S10 3PJ

A fantastic, stunning, large extended four double bedroom, two bathroom detached family home with accommodation of 2150 sqft, on a quiet cul de sac, in this exclusive residential suburb. Tastefully and substantially improved by the current owners and an internal inspection an absolute must.

The property which is being sold with NO ONWARD CHAIN has ethernet ports in every room and briefly comprises; Reception hall, cloakroom, large living room, separate dining room opening through to the stunning orangery with patio doors to terrace and garden and with feature roof lantern and bespoke library/study area to one side. Breakfast kitchen with contemporary range of units and range of appliances and separate chef's kitchen/utility. First Floor: master bedroom with en suite shower room, three further double bedrooms, one having a small room off, ideal for an en suite. Large family bathroom with full suite. Outside: double width drive to double garage, to the rear, south westerly facing private garden, beautifully landscaped and with terrace and creating a lovely setting for this beautiful family home.

Great catchment area for schools, walking distance of the open countryside and well placed for nearby hospitals and universities.

- No Onward Chain,
- Four Bedrooms/Two Bathrooms
- Stunning Rear Orangery with Lovely Aspect Over The Garden
- Excellent Location For First Class Schools And Well Placed For Nearby Hospitals
- EPC Rating D
- Fantastic Large Extended Detached Family Home
- Accommodation In Excess Of 2150 sq.ft
- Off Road Parking And Double Garage
- Walking Distance Of The Open Countryside Of The Mayfield Valley
- Viewing Via Banner Cross Office

Entrance Porch

Entrance Hallway

With storage under the stairs.

Open Plan Fitted Kitchen Dining Room

An ideal entertaining space. This beautiful modern kitchen offers excellent storage cupboards, with every space having being maximised, double oven and five ring hob with extractor fan above, and integral dishwasher. This wonderful room opens into the dining room and has a breakfast bar.

Dining Room

Being open plan to both the kitchen, lounge and orangery/study. This light and airy space is an ideal space for entertaining.

Orangery

This beautiful room was an extension by the current owners and is used as an orangery/study area with a range of bespoke shelving and desk. This light and airy space offers pleasant garden views, bespoke electric roof blinds and doors providing access onto the rear garden.

Utility/Kitchen

With a further five ring gas hob and space and plumbing for an automatic washing machine. Lots of additional storage space, sink and drainer unit.

Lounge

With stone fire surround and large window overlooking the pleasant rear garden.

Bedroom One

With a range of fitted wardrobes, this property overlooks the rear garden.

En Suite

A contemporary room with double shower cubicle, wall mounted wash hand basin and w.c.

Bedroom Two

With a range of fitted wardrobes, this is a great size double bedroom.

Bedroom Three

A light and bright room with built in wardrobes

Bedroom Four

A great size fourth bedroom again having fitted wardrobes and with an additional walk in space.

Family Bathroom

Beautifully presented with a recently fitted suite comprising of a bath, wash hand basin and w.c.

Double Integral Garage

Exterior and Gardens

To the front of the property is a garden which has lawn, herb garden and a range of mature shrubs and trees. The front garden could be removed to provide further additional parking if required. Double driveway to garage. To the rear of the property is a patio area with lawn beyond and again a range of mature shrubs and trees. Whilst the property is enclosed to the rear, there is access round the side of the property to the back garden.



6 Hillcote Drive

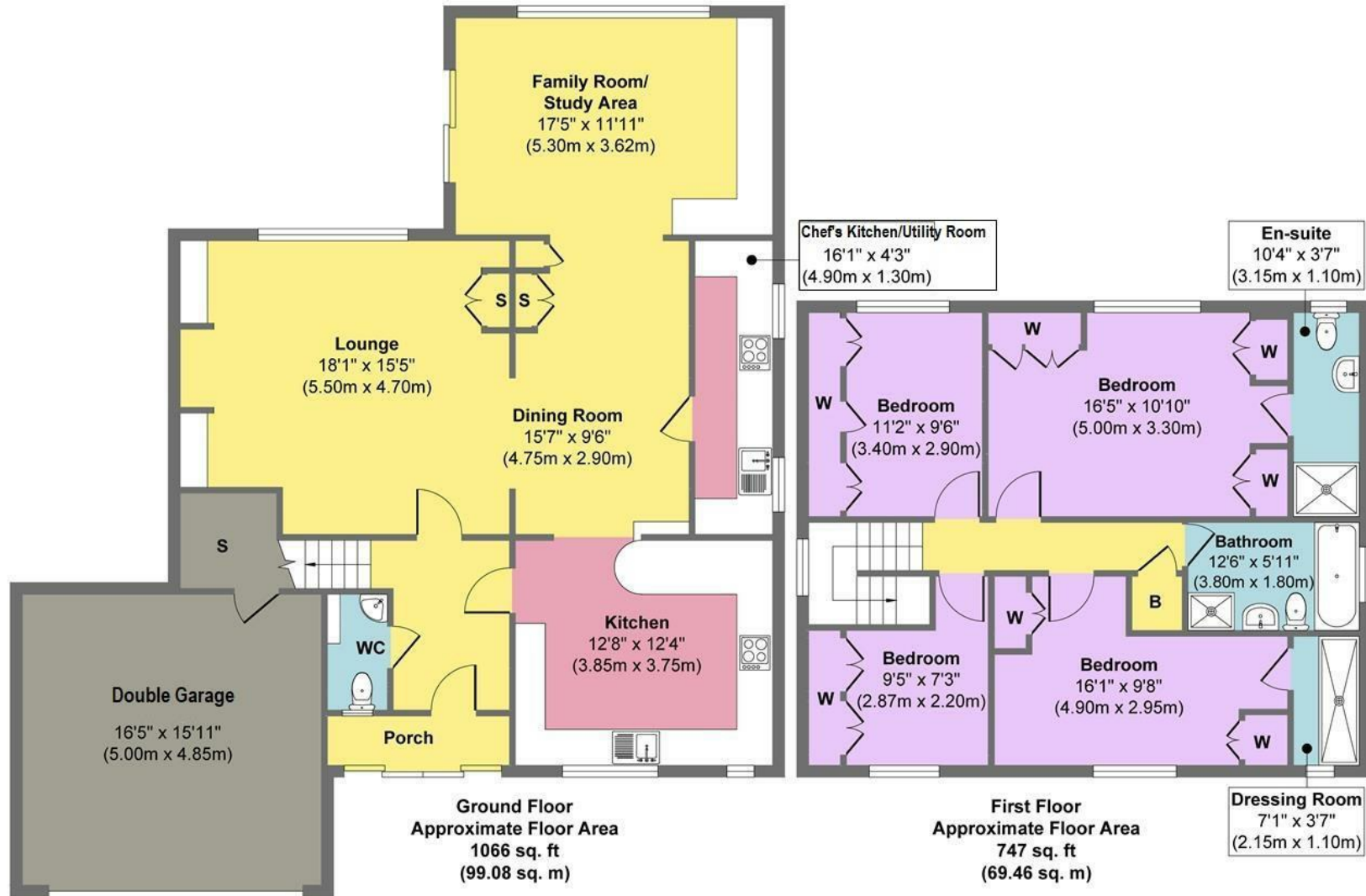

Approx. Gross Internal Floor Area 1814 sq. ft / 168.54 sq. m

Illustration for identification purposes only, measurements are approximate, not to scale.

Produced by Elements Property



