



32 Dunkeld Road, Ecclesall, Sheffield, S11 9HP

Saxton Mee

32 Dunkeld Road

Ecclesall

Guide Price

£525,000

GUIDE PRICE £525,000 - £550,000

Situated in the sought after area of Ecclesall is this three/four bedroom semi-detached home, ideal for a family and within easy reach of a wide range of amenities and excellent transport links into central Sheffield.

The accommodation is well presented throughout and briefly comprises: A welcoming entrance hallway with access down to the cellar ideal for storage. Bay windowed lounge to the front with feature fireplace. Dining room to the rear with decorative fireplace and a separate kitchen having a range of contemporary gloss units, integrated fridge and freezer, oven, hob and extractor hood above. A door leads out onto the garden. To the first floor are two large double bedrooms and a third single bedroom. Modern family bathroom with tiling to the floor and walls, wash hand basin, large walk in shower and separate bath. Separate W.C. A staircase rises to the occasional loft room with eaves storage and en suite W.C.

Outside to the front is a block paved driveway providing ample off street parking for three vehicles. To the rear is a much larger than average rear garden with patio, lawn, established hedging, decked area and garden shed. Gated access to the side.



- Good Sized Family Home
- First Class School Catchment
- Popular Area Of Ecclesall
- Regular Public Transport Links
- Potential To Extend (STPP)
- Large Private Garden
- Tenure: Leasehold
- Council Tax: Band D
- EPC Rating:
- Viewing Via Banner Cross Office



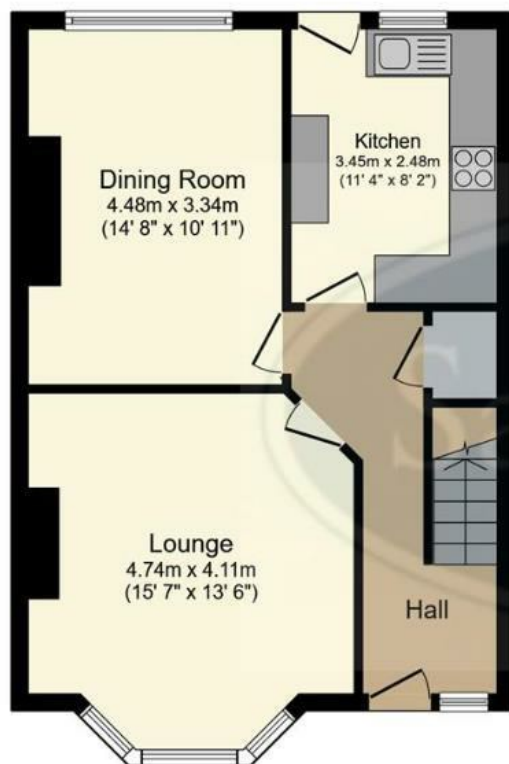

Ground Floor

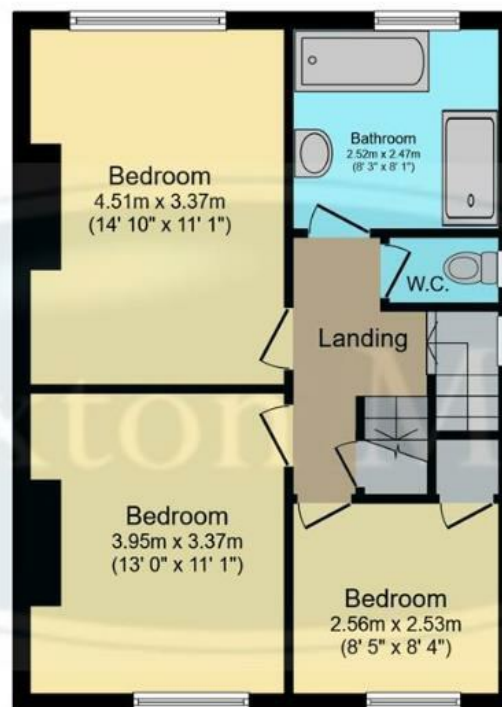

First Floor

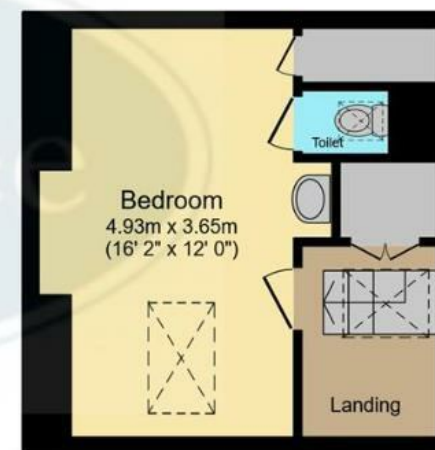

Second Floor

Total floor area 126.0 m² (1,356 sq.ft.) approx

This plan is for illustration purposes only and may not be representative of the property. Plan not to scale. Powered by PropertyBox

While we endeavour to make our sales particulars fair, accurate and reliable, they are only a general guide to the property and, accordingly, if there is any point, which is of particular importance to you, please contact the relevant office. The Agents have not tested any apparatus, equipment, fittings or services and so cannot verify they are in working order. The buyer is advised to obtain verification. Please note all the measurement details are approximate and should not be relied upon as exact. All plans, floor plans and maps are for guidance purposes only and are not to scale. Under no circumstances should they be relied upon as exact or for use in planning carpets and other such fixtures, fittings or furnishings. YOUR HOME IS AT RISK IF YOU DO NOT KEEP UP REPAYMENTS ON A MORTGAGE OR OTHER LOAN SECURED ON IT. 'A Life Assurance policy may be requested.' 'Written Quotations of credit terms available on request.'

Banner Cross
T: 0114 268 3241
E: bannercross@saxtonmee.co.uk
www.saxtonmee.co.uk

Hathersage
T: 01433 650009
E: hathersage@saxtonmee.co.uk

Bakewell
T: 01629 815307
E: bakewell@saxtonmee.co.uk

Matlock
T: 01629 828250
E: matlock@saxtonmee.co.uk

