

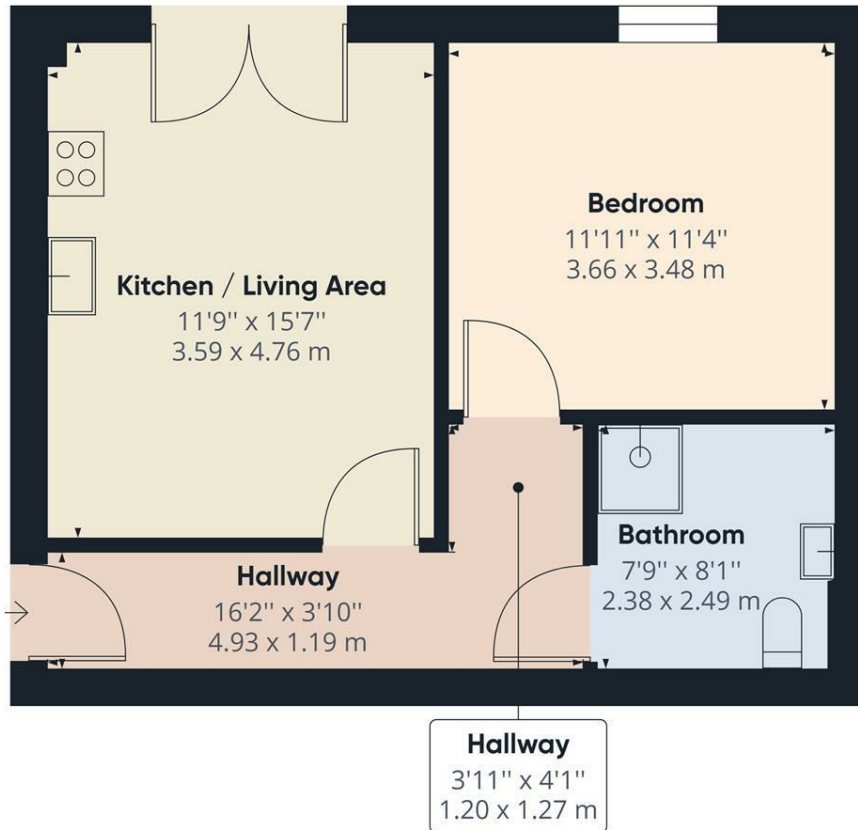

Apt 32 Cutlery Works 33 Lambert Street, Sheffield S3 7BG **£675 Per Calendar Month**

A particularly spacious one double bedroom first floor apartment located in this popular and conveniently located residential development. Within a short walk of Sheffield city centre and Kelham Island. Briefly comprising: entrance hallway, open plan kitchen/dining/living room with access to a balcony. Large double bedroom and spacious shower room.

FURNISHED 6-12 MONTH TENANCY. Restrictions - No smokers or pets. Energy Efficiency Rating B. Council Tax Band B.



Approximate total area⁽¹⁾
470.91 ft²
43.75 m²

(1) Excluding balconies and terraces

While every attempt has been made to ensure accuracy, all measurements are approximate, not to scale. This floor plan is for illustrative purposes only.

GIRAFFE360

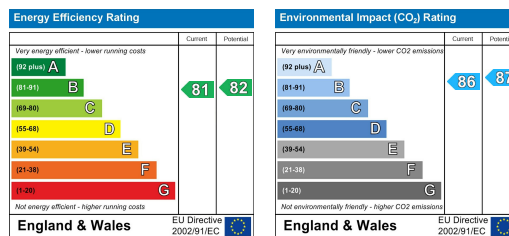

Banner Cross
Hathersage
Bakewell
Matlock
www.saxtonmee.co.uk

949-951 Ecclesall Road, Sheffield S11 8TN
3 Bank View, Main Road, Hathersage S32 1BB
Matlock Street, Bakewell DE45 1EE
27 Causeway Lane, Matlock, DE4 3AR

T: 0114 268 3241
T: 01433 650009
T: 01629 815307
T: 01629 828250

E: bannercross@saxtonmee.co.uk
E: hathersage@saxtonmee.co.uk
E: bakewell@saxtonmee.co.uk
E: matlock@saxtonmee.co.uk