

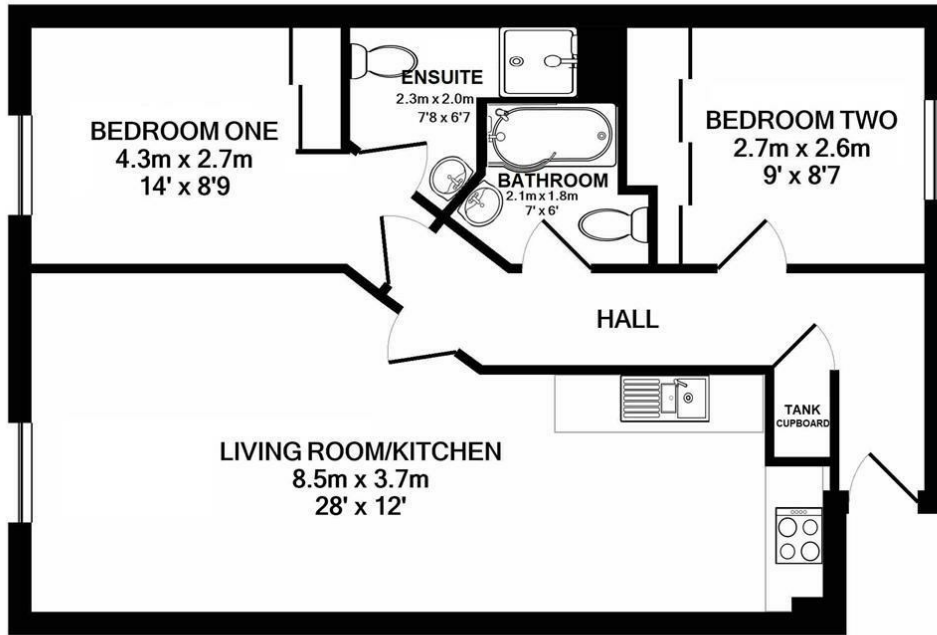

### **Apt 11 55 Wilkinson Street, S10 2GJ** **£950 Per Calendar Month**

Modern 2 bedroom, 2 bathroom (1 en-suite) top floor apartment. 5 minute walk to the Hallamshire Hospital & University of Sheffield. Includes basic furniture, washing machine/dryer, dishwasher, fridge freezer and microwave. Underfloor electric heating & double glazing throughout. Off road parking for 1 vehicle. Restrictions: No Smoking, No Pets Occupancy: maximum 2 persons (including any dependents)  
Restrictions: No Children or Pets. No Smoking. Energy Efficiency Rating C. Council Tax Band B



**TOTAL APPROX. FLOOR AREA 60.4 SQ.M. (650 SQ.FT.)**

Whilst every attempt has been made to ensure the accuracy of the floor plan contained here, measurements of doors, windows, rooms and any other items are approximate and no responsibility is taken for any error, omission, or mis-statement. This plan is for illustrative purposes only and should be used as such by any prospective purchaser. The services, systems and appliances shown have not been tested and no guarantee as to their operability or efficiency can be given

Made with Metropix ©2021

by **RCJ Residential** - [rcjresidential.co.uk](http://rcjresidential.co.uk)

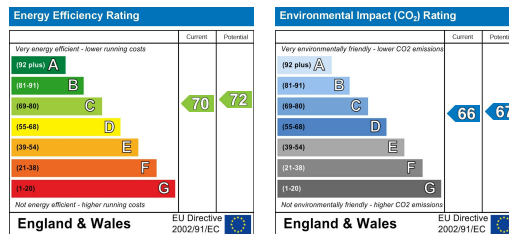

Banner Cross  
Hathersage  
Bakewell  
Matlock  
[www.saxtonmee.co.uk](http://www.saxtonmee.co.uk)

949-951 Ecclesall Road, Sheffield S11 8TN  
3 Bank View, Main Road, Hathersage S32 1BB  
Matlock Street, Bakewell DE45 1EE  
27 Causeway Lane, Matlock, DE4 3AR

T: 0114 268 3241  
T: 01433 650009  
T: 01629 815307  
T: 01629 828250

E: [bannercross@saxtonmee.co.uk](mailto:bannercross@saxtonmee.co.uk)  
E: [hathersage@saxtonmee.co.uk](mailto:hathersage@saxtonmee.co.uk)  
E: [bakewell@saxtonmee.co.uk](mailto:bakewell@saxtonmee.co.uk)  
E: [matlock@saxtonmee.co.uk](mailto:matlock@saxtonmee.co.uk)