



Flat 9 Victoria Court 16 Victoria Road, Sheffield S10 2DL £900 Per Calendar Month

Available to let is this spacious two bedroom second-floor apartment in a small exclusive development, located in this sought area just a stone's throw away from Ecclesall Road and the Collegiate campus, public transport, hospitals, and City Centre. The property in brief comprises;

Spacious reception hall with access to loft storage space, a large sitting room/dining room, separate kitchen with range of units. Double bedroom, single bedroom, and bathroom with full suite and shower. Outside: private allocated parking space and good sized communal grounds. UNFURNISHED 6-12 MONTH TENANCY. Restrictions: No sharers, smokers, or students. Energy Efficiency Rating E. Council Tax Band B

9 VICTORIA COURT, 16 VICTORIA ROAD

APPROXIMATE GROSS INTERNAL AREA = 53.3 SQ M / 574 SQ FT

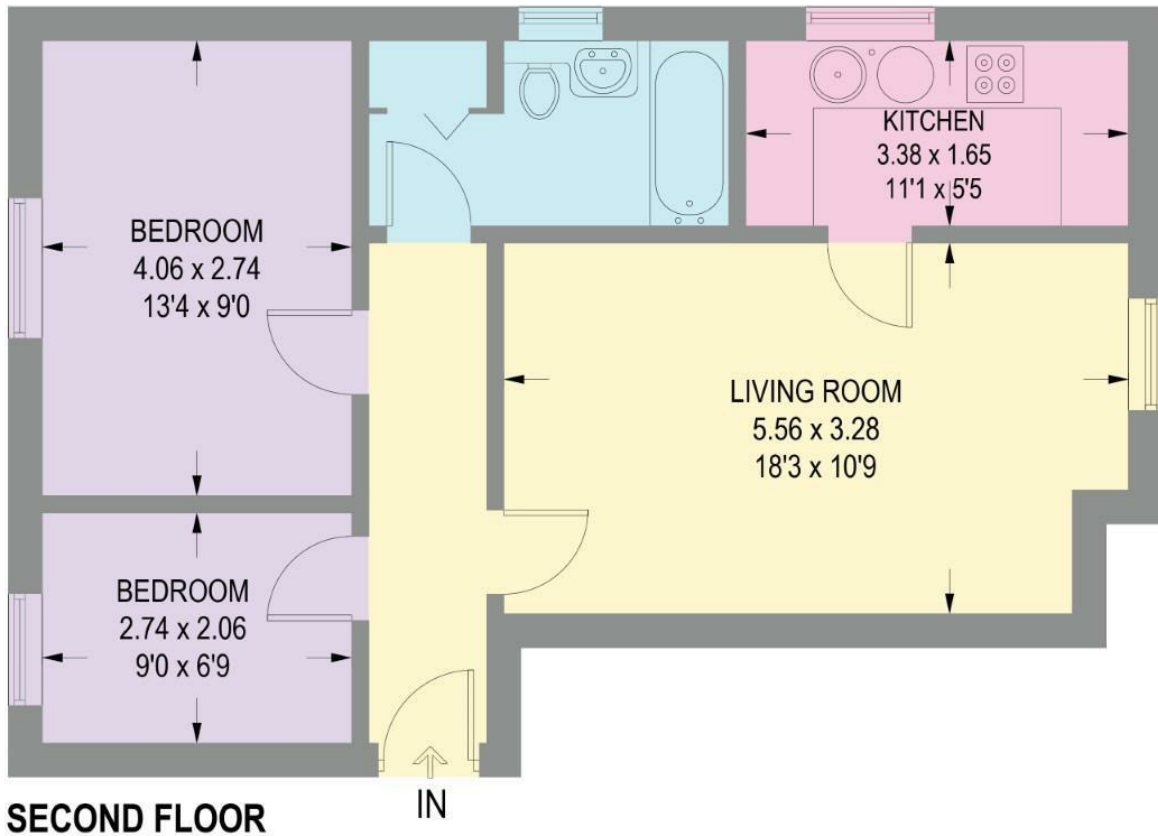
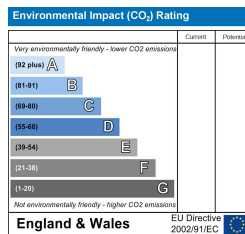
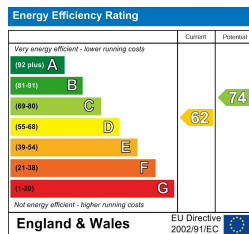

Illustration for identification purposes only, measurements are approximate, not to scale.



Banner Cross
Hathersage
Bakewell
Matlock
www.saxtonmee.co.uk

949-951 Ecclesall Road, Sheffield S11 8TN
3 Bank View, Main Road, Hathersage S32 1BB
Matlock Street, Bakewell DE45 1EE
27 Causeway Lane, Matlock, DE4 3AR

T: 0114 268 3241
T: 01433 650009
T: 01629 815307
T: 01629 828250

E: bannercross@saxtonmee.co.uk
E: hathersage@saxtonmee.co.uk
E: bakewell@saxtonmee.co.uk
E: matlock@saxtonmee.co.uk