



Willow Cottage Watts Green, Ashford-In-The-Water, Bakewell DE45 1QE

Saxton Mee

Lettings

# Willow Cottage Watts Green

## Ashford-In-The-Water

Per Calendar Month

### £1,650 Per Calendar

A charming three bedroomed cottage centrally positioned within a sought after village in the Peak District National Park 2 miles from Bakewell Market Town. Ashford-in-the-Water is an extremely picturesque village, has good amenities and is in an excellent catchment area for schools being a very short drive from the historic market town of Bakewell.

The accommodation includes: spacious open plan kitchen/dining room with good quality units and range cooker, WC through to lounge. First floor; Master double bedroom, a further two good sized bedrooms and bathroom with three piece white suite and separate shower cubicle. Outside; lawed rear garden with decked area enjoying stunning settings overlooking the River Wye.

FURNISHED 6 or 12 month tenancy. Restrictions: No smokers. Energy Efficiency Rating - D Council Tax Band - awaiting information

- Three Bedrooms
- One Bathroom
- Riverside Setting
- Sought After Location





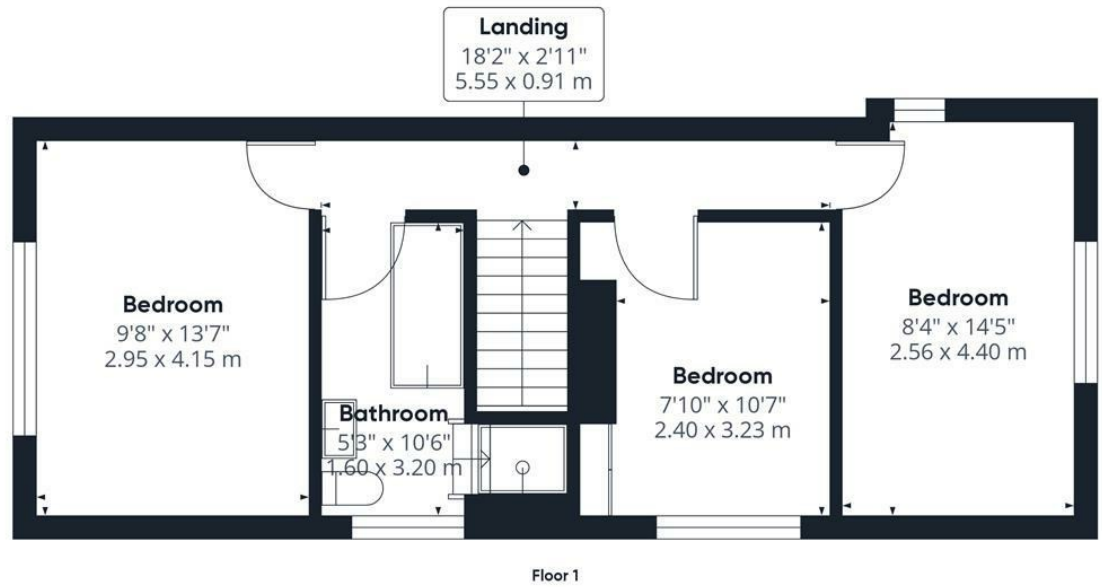
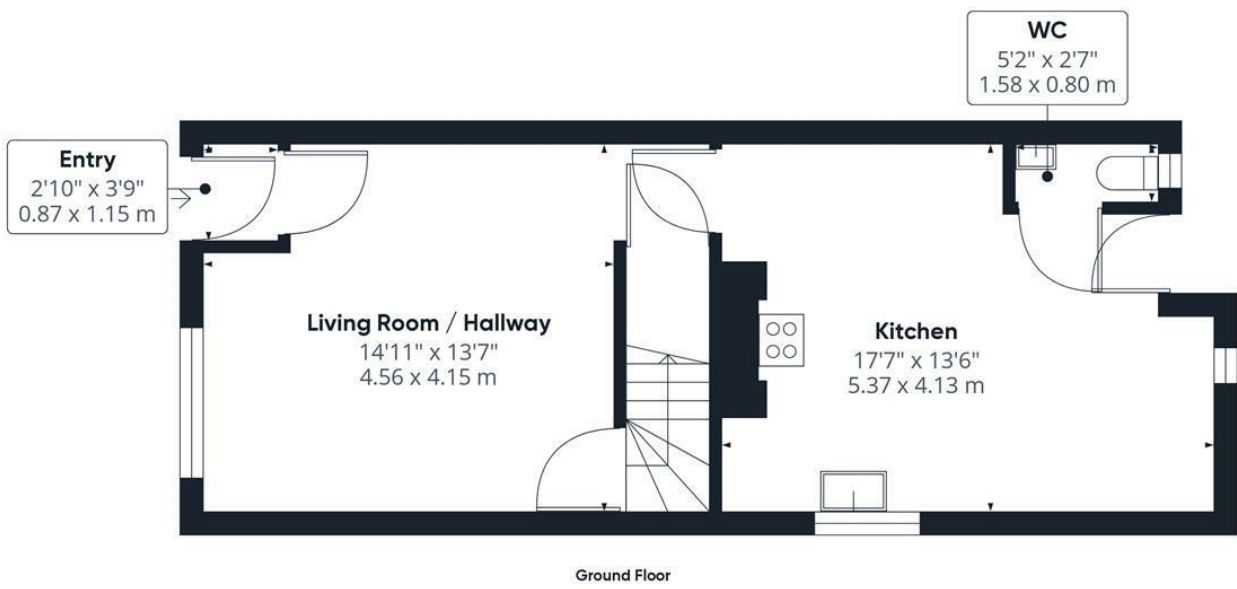

**Approximate total area<sup>®</sup>**  
940.42 ft<sup>2</sup>  
87.37 m<sup>2</sup>

(1) Excluding balconies and terraces.

While every attempt has been made to ensure accuracy, all measurements are approximate, not to scale. This floor plan is for illustrative purposes only.

GIRAFFE360

While we endeavour to make our sales particulars fair, accurate and reliable, they are only a general guide to the property and, accordingly, if there is any point, which is of particular importance to you, please contact the relevant office. The Agents have not tested any apparatus, equipment, fittings or services and so cannot verify they are in working order. The buyer is advised to obtain verification. Please note all the measurement details are approximate and should not be relied upon as exact. All plans, floor plans and maps are for guidance purposes only and are not to scale. Under no circumstances should they be relied upon as exact or for use in planning carpets and other such fixtures, fittings or furnishings. YOUR HOME IS AT RISK IF YOU DO NOT KEEP UP REPAYMENTS ON A MORTGAGE OR OTHER LOAN SECURED ON IT. 'A Life Assurance policy may be requested.' 'Written Quotations of credit terms available on request.'

Banner Cross  
T: 0114 268 3241  
E: [bannercross@saxtonmee.co.uk](mailto:bannercross@saxtonmee.co.uk)  
[www.saxtonmee.co.uk](http://www.saxtonmee.co.uk)

Hathersage  
T: 01433 650009  
E: [hathersage@saxtonmee.co.uk](mailto:hathersage@saxtonmee.co.uk)

Bakewell  
T: 01629 815307  
E: [bakewell@saxtonmee.co.uk](mailto:bakewell@saxtonmee.co.uk)

Matlock  
T: 01629 828250  
E: [matlock@saxtonmee.co.uk](mailto:matlock@saxtonmee.co.uk)



Lettings