



2 Whitworth Croft 10a Whitworth Road, Sheffield S10 3HD

Saxton Mee

Lettings

2 Whitworth Croft 10a

Per Calendar Month

£1,000 Per Calendar

Available to let is this excellent and tastefully presented two bedroom ground floor apartment close to to excellent amenities of Ranmoor and the open countryside of the Mayfield Valley.

Ranmoor is one of Sheffield's exclusive suburbs and is well placed for nearby shops and recreational facilities. In a good catchment area for schools, close to the open countryside and being very convenient for Sheffield University, hospitals and Sheffield City Centre.

The property briefly comprises of; communal entrance, entrance hallway, spacious open plan lounge/dining, kitchen with integrated appliances, master double bedroom, double bedroom two, bathroom with three piece white suite and shower over. Outside; garage and communal gardens.

FURNISHED 12 MONTH TENANCY. RESTRICTIONS: No smokers, no pets. Energy Efficiency Rating C Council Tax Band B

- Two Double Bedrooms
- One Bathroom
- Sought After Location
- Garage
- Available Immediately





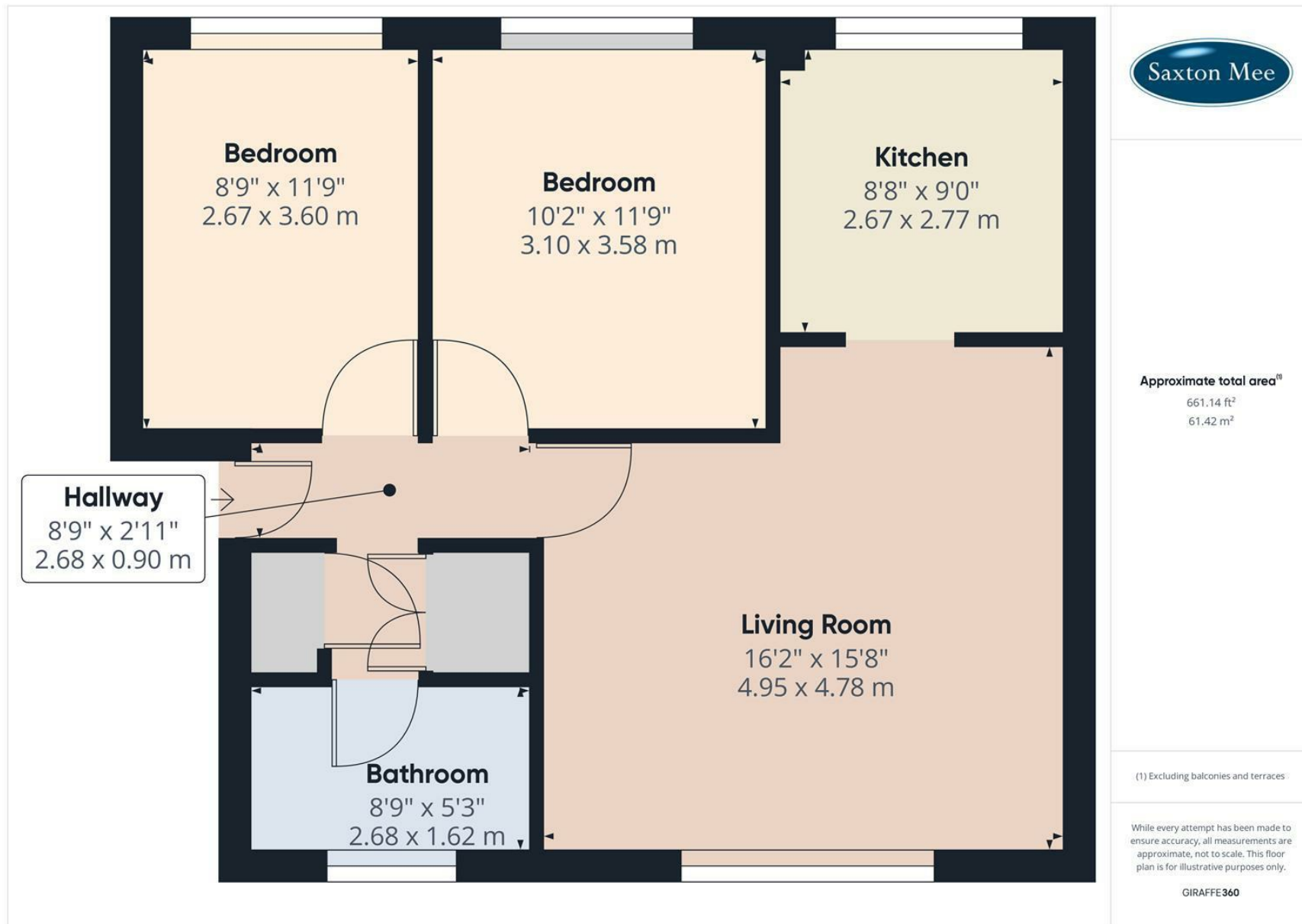

While we endeavour to make our sales particulars fair, accurate and reliable, they are only a general guide to the property and, accordingly, if there is any point, which is of particular importance to you, please contact the relevant office. The Agents have not tested any apparatus, equipment, fittings or services and so cannot verify they are in working order. The buyer is advised to obtain verification. Please note all the measurement details are approximate and should not be relied upon as exact. All plans, floor plans and maps are for guidance purposes only and are not to scale. Under no circumstances should they be relied upon as exact or for use in planning carpets and other such fixtures, fittings or furnishings. YOUR HOME IS AT RISK IF YOU DO NOT KEEP UP REPAYMENTS ON A MORTGAGE OR OTHER LOAN SECURED ON IT. 'A Life Assurance policy may be requested.' 'Written Quotations of credit terms available on request.'

Banner Cross
T: 0114 268 3241
E: bannercross@saxtonmee.co.uk
www.saxtonmee.co.uk

Hathersage
T: 01433 650009
E: hathersage@saxtonmee.co.uk

Bakewell
T: 01629 815307
E: bakewell@saxtonmee.co.uk

Matlock
T: 01629 828250
E: matlock@saxtonmee.co.uk



Lettings